

RECORD OWNERS:-
 SUZANNE BAUER (BOOK 5100, PAGE 379)
 LESLIE THOMAS MORSE (BOOK 5173, PAGE 723)

WRENTHAM, MASSACHUSETTS
 (NORFOLK COUNTY)

A-1
 321,160 S.F.
 (7.37 Acres)

A-2
 353,449 S.F.
 (8.11 Acres)

B-2
 605,463 S.F.
 (13.89 Acres)

B-1
 69,148 S.F.
 (1.59 Acres)

APPROVAL UNDER SUBDIVISION
 CONTROL LAW NOT REQUIRED
 DATE: JUNE 15, 1981
 [Signatures]
 PLAINVILLE PLANNING BOARD

I CERTIFY THAT THIS ACTUAL SURVEY WAS MADE
 ON THE GROUND IN ACCORDANCE WITH LAND COURT
 INSTRUCTIONS OF 1971 ON OR BETWEEN JULY 2, 1977
 AND MAY 23, 1981
 DATE: MAY 25, 1981 *David E. Grant*
 REGISTERED LAND SURVEYOR

I CERTIFY THAT THE CONDITIONS ON THE GROUND ARE
 THE SAME NOW AS AT THE TIME OF THE ORIGINAL
 SURVEY.
 DATE: APRIL 21, 1983 *David E. Grant*
 REGISTERED LAND SURVEYOR

NOTE:-
 1. LOT A-1, AND LOT A-2, TO BE COMBINED
 TO COMPRISE ONE LOT CONTAINING
 674,609 S.F. (15.48 AC.).
 2. LOT B-1, AND LOT B-2, TO BE COMBINED
 TO COMPRISE ONE LOT CONTAINING
 674,609 S.F. (15.48 AC.).

Charles R. and Madeline J. Mason
 L.C. PLAN NO. 39612A

PLAN OF LAND
 IN
PLAINVILLE AND CUMBERLAND
 MASSACHUSETTS
 (NORFOLK COUNTY) AND (PROVIDENCE COUNTY)

Scale: - 1" = 80' May 25, 1981

DAVID E. GRANT
 REGISTERED LAND SURVEYOR
 108 CENTRAL STREET
 MANSFIELD, MASS.

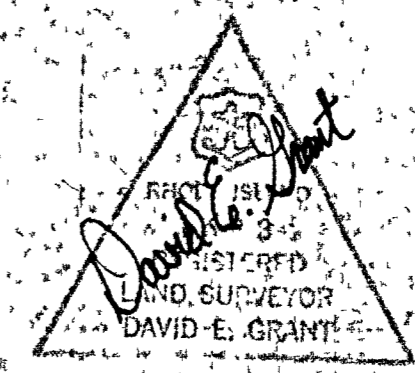
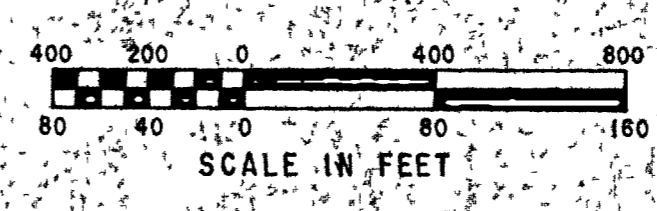

DETAIL "A"
 (TIE TO L.C. PLAN 29629A)

DETAIL "B"

Mayle, Inc.
 Book 5878, Page 246

L.C. PLAN 39612A

L.C. PLAN 29629A

NOTE:
 SEE DETAIL "A" FOR TRAVERSE
 TIE TO STATE LINE MONUMENT

