

PLAN OF LAND IN QUINCY, MASS.

GALE ENGINEERING COMPANY, INC.
8 WASHINGTON PLACE BRAINTREE, MASS.
ENGINEERS LAND SURVEYORS

SCALE: NOTED

DATE: MARCH 31, 1981

I CERTIFY THAT THIS ACTUAL SURVEY WAS MADE ON THE GROUND IN ACCORDANCE WITH THE LAND COURT INSTRUCTIONS OF 1971 BETWEEN 3-11-1981 AND 3-30-1981.

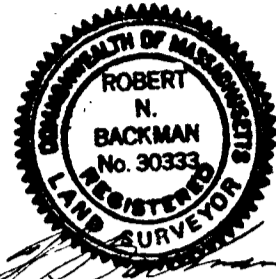

April 6, 1981

I HEREBY CERTIFY THAT THE PROPERTY LINES SHOWN ON THIS PLAN ARE THE LINES DIVIDING EXISTING OWNERSHIPS, AND THE LINES OF THE STREETS AND WAYS SHOWN ARE THOSE OF PUBLIC OR PRIVATE STREETS OR WAYS ALREADY ESTABLISHED, AND THAT NO NEW LINES FOR DIVISION OF EXISTING OWNERSHIP OR FOR NEW WAYS ARE SHOWN.

April 6, 1981

I CERTIFY THAT THE CONDITIONS ON THE GROUND ARE THE SAME NOW AS AT THE TIME OF THE ORIGINAL SURVEY.

Feb. 4, 1987

