

SILVER LAKE (Private ~30' wide) ROAD

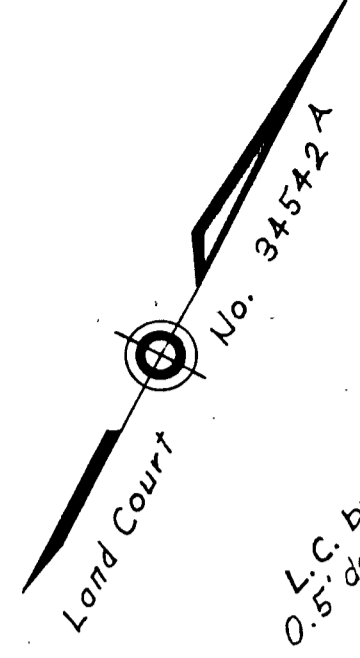

L.C. bronze pin (fnd)
0.5' down, loose

N 62° 10' 00" E → 50.00 (Rec.)
N 62° 21' 42" E → 49.85 (Meas.)

L.C. dh. in sb. (fnd) (held)

beg. of fence to ssm 2' p.p. in ssm. (set)

75.00 (R and Survey)

N 62° 10' 00" E →

Leo R. Remillard &
Viola R. Remillard
(See Land Court No. 34542
Cert. No. 87348 filed in Reg.
Bk. 437, Page 148)

#61
1 Story w/f House

#63
1 Story w/f House

Total Area = 10,137.s.f ±

1 Story w/f Building

Joseph & Theresa Giordano

"I certify that this actual survey was made on the ground in accordance with the Land Court Instructions of 1971 on or between March 30, 1976 and May 24, 1976."

John D. Halnon, Jr.
R.L.S. # 21954

"I hereby certify that the property lines shown on this plan are the lines dividing existing ownerships, and the lines of streets and ways shown are those of public or private streets or ways already established, and that no new lines for division of existing ownership or for new ways are shown."

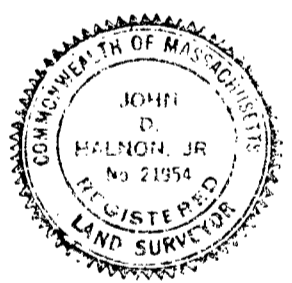

John D. Halnon, Jr.
R.L.S. # 21954

PETITIONERS PLAN OF LAND
IN
BELLINGHAM, MASS.
(NORFOLK COUNTY)
Petitioner: SCOTT HILL REALTY, INC.
Scale: 1" = 10' Date: May 24, 1976
Guerriere and Halnon, Inc.
Engineering and Land Surveying
707 Main Street, Millis, Mass.

- Deed and Plan References
Recorded in Norfolk County
Registry of Deeds, Dedham.
1. Book 4699 Page 515
 2. " 2401 " 253
 3. " 2584 " 150
 4. " 2377 " 235
 5. " 2271 " 227
 6. " 1566 " 620
 7. " 1519 " 627
 8. " 2026 " 273
 9. " 1519 " 627 & 628
 10. " 1599 " 386
 11. Plan No. 289 (of 3) in Book 1557/End

LEGEND:
L.C. dh. in = Land Court drill hole in stone bound found.
s.b. (fnd) =
p.p. in s.s.m. = Prick punch in 36" steel survey marker, set with cap. (set)

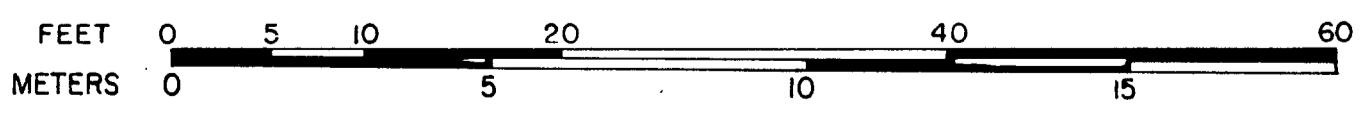

Note: This plan refers to Bellingham Assessors Sheet 68, Lot 21.