

TRUE NORTH (ROUTE 24)

STOUGHTON AVON

STOUGHTON

REDEVELOPMENT

BOSTON

AUTHORITY

EDISON

STOUGHTON AVON

MONUMENTED BASE LINE

PHILIP N. GOOD

(FORMERLY NEW YORK, NEW HAVEN AND HARTFORD RAILROAD) OLD COLONY BRANCH

51°10'36"E

85.67

860.60

541°41'05"W

102.93

914.28

532°31'39"E

44.83

572°19'05"W

270.88

588°01'29"E

89.14

162°34'02"E

51.91

121°39'54"E

361.24

222.76

162°34'02"E

51.91

121°39'54"E

361.24

222.76

162°34'02"E

51.91

121°39'54"E

361.24

222.76

162°34'02"E

51.91

121°39'54"E

361.24

222.76

162°34'02"E

51.91

121°39'54"E

361.24

222.76

162°34'02"E

51.91

121°39'54"E

361.24

222.76

162°34'02"E

51.91

121°39'54"E

361.24

222.76

162°34'02"E

51.91

121°39'54"E

361.24

222.76

162°34'02"E

51.91

121°39'54"E

361.24

222.76

162°34'02"E

51.91

121°39'54"E

361.24

222.76

162°34'02"E

51.91

121°39'54"E

361.24

222.76

162°34'02"E

51.91

121°39'54"E

361.24

222.76

162°34'02"E

51.91

121°39'54"E

361.24

222.76

162°34'02"E

51.91

121°39'54"E

361.24

222.76

162°34'02"E

51.91

121°39'54"E

361.24

222.76

162°34'02"E

51.91

121°39'54"E

361.24

222.76

162°34'02"E

51.91

121°39'54"E

361.24

222.76

162°34'02"E

51.91

121°39'54"E

361.24

222.76

162°34'02"E

51.91

121°39'54"E

361.24

222.76

162°34'02"E

51.91

APPROXIMATE LOCATION OF LOTS 117, 118, 157 & 158 BEING CLAIMED BY PETITIONER. EXACT LOCATION OF LOTS IS INDETERMINATE AS PLAN OF AVON PARK DOES NOT COINCIDE WITH CONDITIONS EXISTING ON THE GROUND.

AREA 22,539 ACRES (INCLUDES LOTS 117, 118 & 157, 158)

SEE "PLAN OF AVON PARK, AVON, MASS., - 1906 SCALE 50 FT. TO 1 INCH RECORDED AT NORFOLK COUNTY REGISTRY OF DEEDS, FEBRUARY 11, 1907 AND FILED AS PLAN NO. 2165, PLAN BOOK 46."

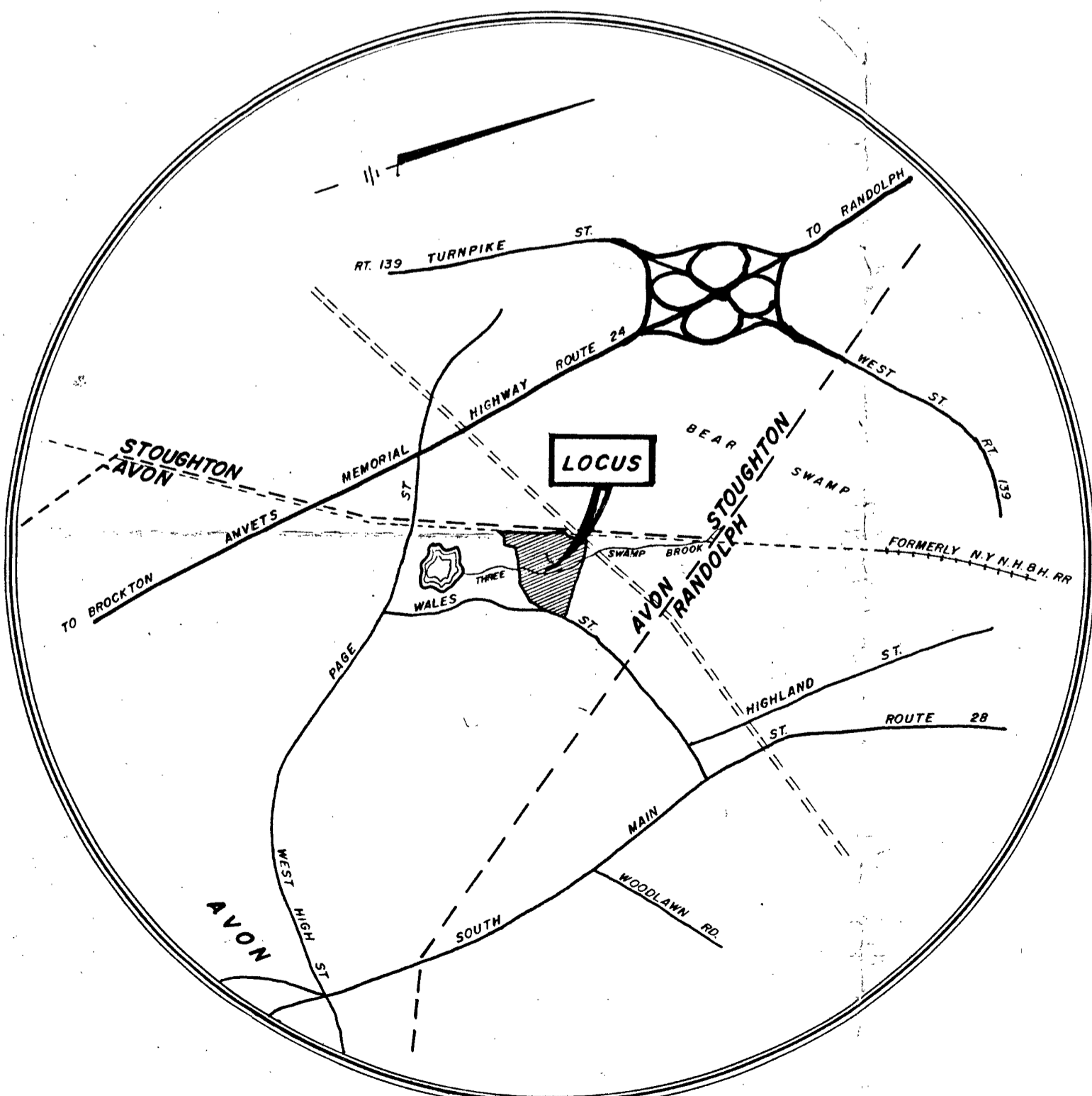

LOCUS MAP SCALE 1" = 2000'

APPROVAL UNDER SUBDIVISION CONTROL LAW NOT REQUIRED  
*J. Edwards*  
*Wayne Court*  
TOWN OF AVON PLANNING BOARD  
DATE 13 June 1974

I CERTIFY THAT THIS ACTUAL SURVEY WAS MADE ON THE GROUND IN ACCORDANCE WITH THE LAND COURT INSTRUCTIONS OF 1971 ON OR BETWEEN MARCH 24, 1974 AND MARCH 26, 1974.  
*James B. Williams*  
Registered Land Surveyor  
DATE 4-25-74

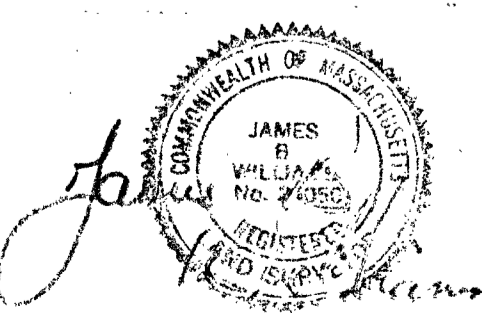

LAND COURT PLAN OF LAND IN AVON, MASSACHUSETTS OWNED BY T.L. EDWARDS, INC. SCALE 1" = 100' APRIL 4, 1973 HAYWARD-BOYNTON & WILLIAMS, INC. SURVEYORS CIVIL ENGINEERS 47 WEST ELM ST. BROCKTON, MASS.