

L. C. # 26706

LD. CT. CASE 26706 A  
FILED WITH CERT. OF TITLE 65404

FND. D.H.C.B. PREVIOUSLY SET O.K.

MEADOW (40.00' wide) RD.

LOT 57 Francis J. & Patricia R. Datri Cert. of Title 78760 13 Meadow Rd. Medway, Mass.	LOT 58 Alon O. & Elaine Katz Cert. of Title 84725 15 Meadow Rd. Medway, Mass.	LOT 59 Francis A. & Marcio F. Corini Cert. of Title 86867 17 Meadow Rd. Medway, Mass.	LOT 60 Stanley C. & Patricia A. Misiuk Cert. of Title 78521 19 Meadow Rd. Medway, Mass.	LOT 61 Alano M. Converse Cert. of Title 80950 21 Meadow Rd. Medway, Mass.
---	--	--	--	--

165' D.H. FND. TO D.H.F. 10.  
N76°00' W 16.88'  
159.45' N89°12' 32"E 423.04'  
113' D.H. FND. S 1.13' E 0.53' OF OLD D.H. LOC. APPEARS TO HAVE BEEN HIT BY BULLDOZER ETC.  
153.12' D.H. FND. GONE AS OF 12/18/69  
29.10' N84°53'-25" E  
121.13' N00°41'-45" W  
93.77' D.H.C.B. SET

WARD O  
K. WAPPING CONNECTICUT  
WALTER WAPPING  
BOX II

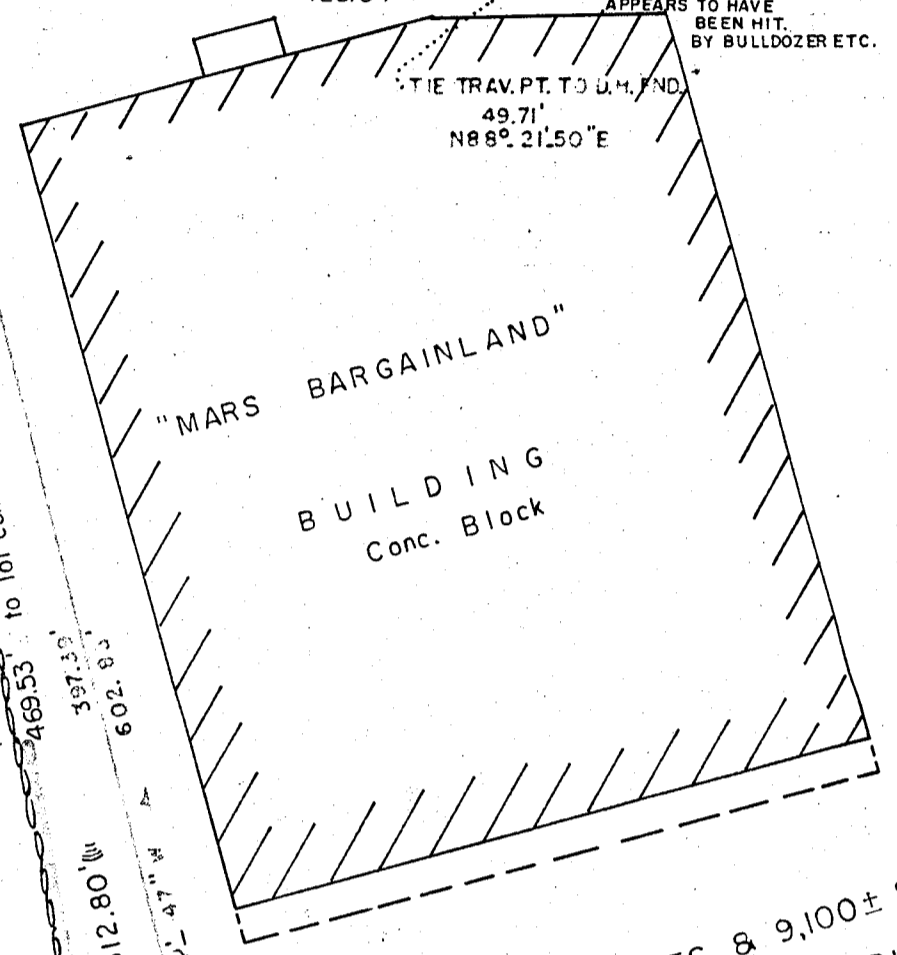

AREA = 5 ACRES & 9,100 ± S.F.  
FREEMAN REALTY TRUST  
Petitioner

MEDWAY SHOPPING CENTER

NOTE:  
BD. HIT AS OF 12/19/69  
IT IS NOW IN THE HOT TOP  
AS SHOWN

0.11' 0.44' Co record located  
244.91' 182.66'

EXIST. BLDG.  
LOT 66  
26706 A  
LD. CT. CASE OF TITLE 65404  
FILED WITH CERT. OF TRUST  
FREEMAN REALTY TRUSTEE  
SAMUEL FREEMAN  
54 SHELDON RD. NEWTON, MASS.

TO POND ST.  
D.H. S.B. FND. O.K.  
90°  
4.00' FND.  
D.H. S.B. (held) 265.09'  
265.09'  
D.H.C.B. SET  
50.93'  
510.00'  
N 12° 24' 25\"/>

CO. LAYOUT OF 1921  
(RTE. 109)  
N 71° 02' 50\"/>

In accordance with Chopt. 380 of the Acts of 1966 I hereby certify that the property lines shown on this plan are the lines dividing existing ownerships and the lines of the streets and ways shown are those of public or private streets or ways already established, and that no new lines for division of existing ownership or for new ways are shown.

*Russell S. Bowie*  
Russell S. Bowie

DATE: Dec. 19, 1969

I certify that this plan was made from an actual survey made on the ground in accordance with the L.d. Ct. Instructions of 1959 between Oct. 4, 1967 & Dec. 19, 1969

*Russell S. Bowie*  
Russell S. Bowie

DATE: Dec. 19, 1969

PETITIONERS PLAN OF LAND  
IN  
MEDWAY, MASS.  
— REG. DISTRICT OF NORFOLK —

SCALE: 1" = 60' DEC. 19, 1969

BOWIE ENGINEERING CO.  
CIVIL ENGINEERS - LAND SURVEYORS  
707 MAIN ST. MILLIS, MASS.

