

FIELD SURVEY TRAVERSE TABLE						
STA.	INTERIOR & BEARING	DIST.	N(+)	S(-)	E(+)	W(-)
A	118°-29'-15"	577'-47'-43"W	184.248		38.951	180.084
B	81°-13'-15"	N 3°-26'-10"W	435.332	434.549		26.092
C	72°-58'-20"	S 76°-24'-30"E	309.166		72.654	300.508
D	87°-18'-35"	S 16°-17'-00"W	336.440		322.944	94.334

MARSHALL (PUBLIC 40' WIDE) STREET

MIDDLE (PUBLIC 40' WIDE) STREET

TERRACE

PENNIMAN (PUBLIC 40' WIDE)

APPROVAL UNDER THE SUBDIVISION CONTROL LAW NOT REQUIRED

CHAIRMAN - BRAINTREE PLANNING BOARD

I CERTIFY THAT THIS ACTUAL SURVEY WAS MADE ON THE GROUND IN ACCORDANCE WITH THE LAND COURT INSTRUCTIONS OF 1959 BETWEEN APR 18 AND APR 25, 1966.

APR 25, 1966 *Lamont R. Healy*

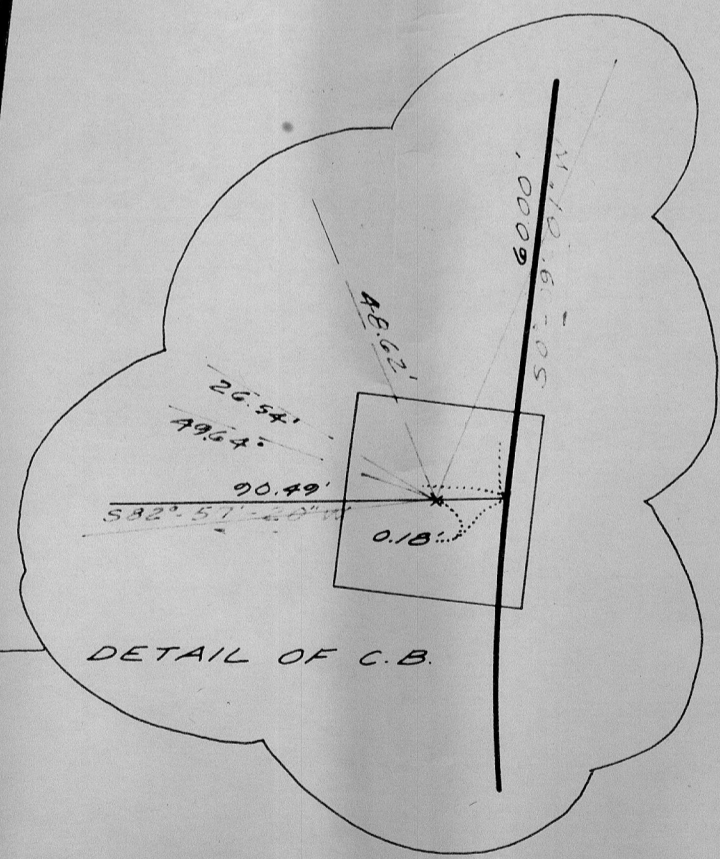

PLAN OF LAND IN BRAINTREE, MASS.

FOR ALBERT F. MCKENNEY  
SCALE: 1" = 20' APR. 25, 1966



APPROVAL UNDER THE SUBDIVISION CONTROL LAW NOT REQUIRED May 10, 1966  
*Joseph M. Maguire*  
PLANNING BOARD - TOWN OF BRAINTREE

LAMONT R. HEALY, INC. - LAND SURVEYORS  
50 WEYMOUTH, MASS.

NOTE: ALL LOT CORNERS HAVE BEEN STAKED.