

Approval under Subdivision
Control Law not required

Raymond P. Sullivan Jr.
Harold Tallman
William W. Woodson
John Lee

Foxborough Planning Board
Date: April 1, 1965

MECHANIC STREET

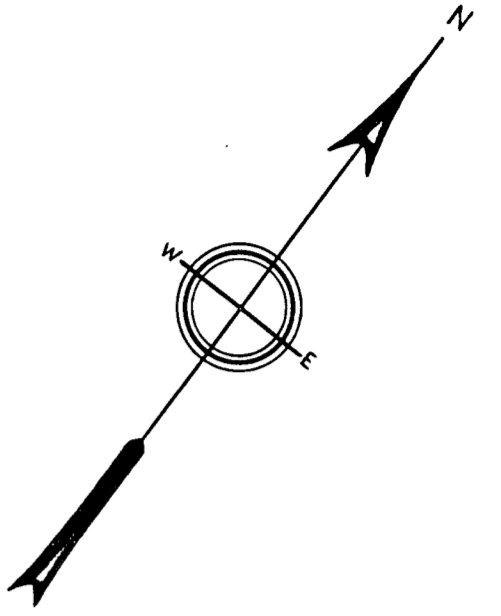

OAK STREET

(PUBLIC)
Norfolk County Layout - Nov. 18, 1952

OAK STREET

S.B. (found)

537.56'

N 37°-22'-10" W

155.00'

S.B. (found)

126.00'

100.00'

100.00'

100.00'

100.00'

11.56'

LOT 8

Walter & Grace L. Cleveland
3614-542

LOT 7

Robert J. & Eleanor A. Bent
3943-226

LOT 6

Nelson B. & Dorothy B. Craver
3412-368

LOT 5

Aime W. & Mary A. Bureau
3436-366

LOT 4

J. B. & Margaret E. Mac Donald et ux.
L.C. Cert. No. 74306
L.C.C. No. 32376

LOT 9A

John H. & Priscilla K. Ohlson
3891-383

LOT 11

24,762 sq. ft.

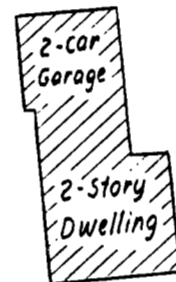

Charles J. & Marlene J. Henrich
3873-8

LOT 12

21,750 sq. ft.

Roy N. & Lovell M. Carlson
3871-59



LOT 13

John D. Mc Carthy
4229-106

N 52°-37'-50" E
135.83'

N 37°-22'-10" W

N 52°-37'-50" E
150.00'

S 52°-37'-50" W
150.00'

DRIVE

(PUBLIC)

CHERYL

R=200.00'
Δ=7°-02'-33"
L=31.92'

58.71'

145.00'

S 37°-22'-10" E

True location of P.C. according to plan of lots

d.h. in S.B.

These lots are shown on a plan by Norwood Eng'g Co. recorded in Norfolk Registry of Deeds in Plan Book 202, Plan No. 991 of 1956

33772A



I certify that this actual survey was made on the ground in accordance with the Land Court Instructions of 1959 on March 20, 1965

Date April 2, 1965

John P. Liensch
Registered Land Surveyor

5-5-65
R.C.C.
Norf. Co. Pl. 44
filed
1. 11. 1965
need

MAP OF LAND
IN
FOXBOROUGH, MASSACHUSETTS

JOHN P. LIENSCH, SURVEYOR

SCALE 1" = 40' MARCH 26, 1965