

330,866 S.F.

LINDEN STREET

BERLIN STREET

WESTON AVE.

Plan of Land in Quincy, Mass.
 Scale 40 feet to an inch
 January 15, 1965
 Ernest W. Branch Inc., Civil Engineers
 301 Adams Building, Quincy

I certify that this actual survey was made on the ground in accordance with Land Court Instructions of 1959 between Dec. 28 and Dec. 31, 1964, Jan. 15, 1965 Robert S. Booth Jr. C.E.

Approval Under Subdivision Control Law Not Required
 Date: 1/20/65
 [Signature]
 Chairman of Planning Board

316+00.00 Bd. Fd. under Tie Nail Fd. in tie

L.C. No. 18269A

The Murray Co. of Texas Inc.

Gerald M. Crosby et ux. Gertrude M.

Elizabeth Bradley

Walter M. Hannon et ux Patricia A.

Kenneth H. Riggs

John E. Johnson et ux Natalie P.

Louis F. Beckas et ux Alice T.

Richard P. Cloutier William F. Whalen Jr.

Lillian H. Rutter

Parish of St. Chrysoston

HANCOCK ST.

Monumented Railroad Base Line
 Trees N.Y. N.H. et H. R.R. Co.

N 25-30-14 W 666.25

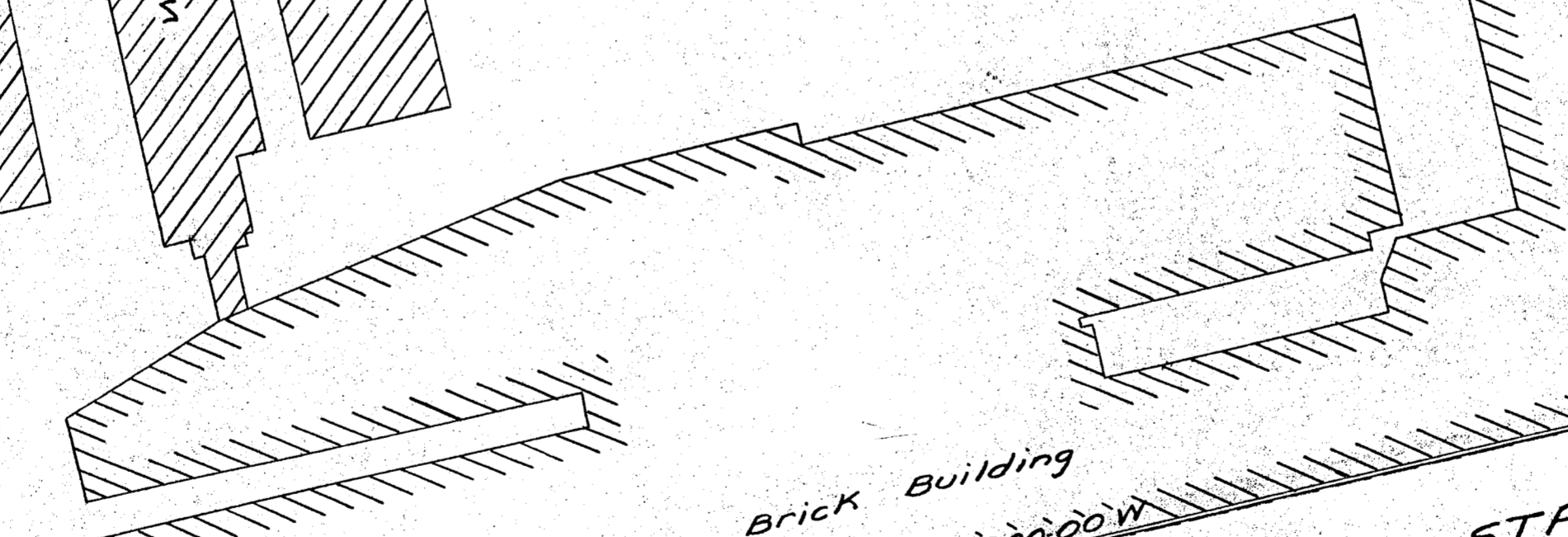
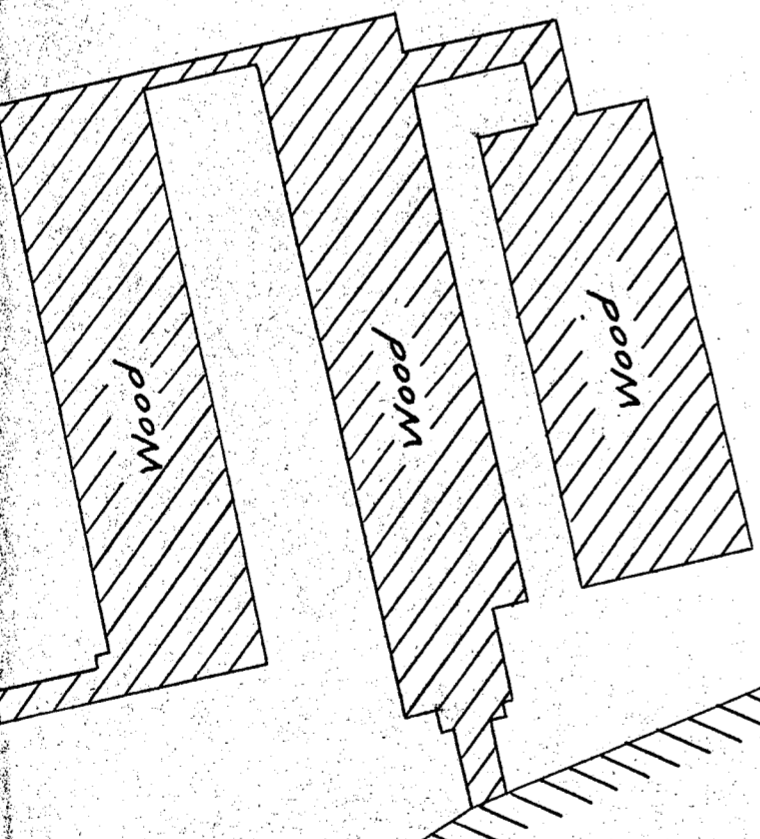

Brick Building
 (Public - 40.00 Feet Wide)
 N 52-00-00 E

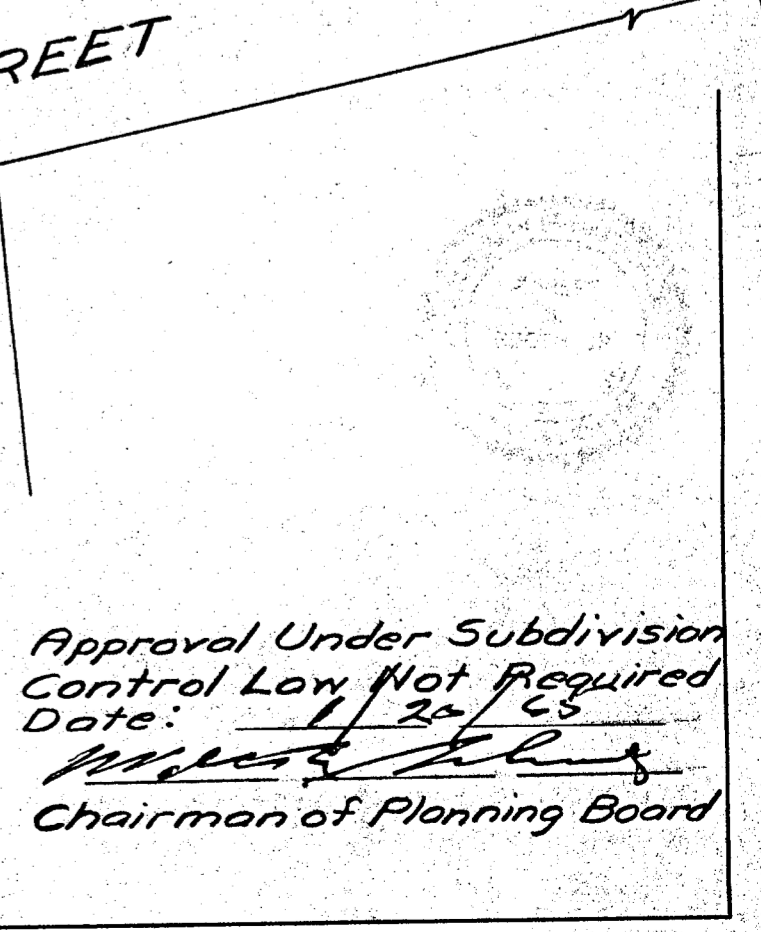

Bd. Fd. 347+00.00

4555A