

# PLAN OF LAND IN STOUGHTON MASS. BELONGING TO HERBERT L. & EDNA B. VILK

SCALE 1" = 40'                      OCT. 31 1960

EDWARD C. PETERSON REG. LAND SURVEYOR

I CERTIFY THAT THIS ACTUAL SURVEY  
WAS MADE ON THE GROUND IN ACCORDANCE  
WITH THE LAND COURT INSTRUCTIONS OF  
1959 ON OR BETWEEN FEB. 18 1960 AND  
OCT. 3 1960.

OCT. 31 1960      Edward C. Peterson      74 LINCOLN ST.  
REG. LAND SURVEYOR                      STOUGHTON MASS.

DIST.	BEAR	LAT		DEP.	
		N.	S.	E.	W.
100.00	S. 05° 42' 00" W.	-	99.50	-	9.93
47.00	S. 71° 47' 58" W.	-	14.68	-	44.65
103.00	S. 64° 30' 58" W.	-	44.32	-	92.98
173.41	N. 00° 33' 43" W.	173.40	-	-	1.70
150.00	S. 84° 18' 00" E.	-	14.90	149.26	-
		173.40	173.40	149.26	149.26

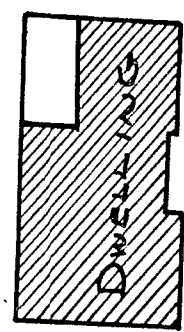
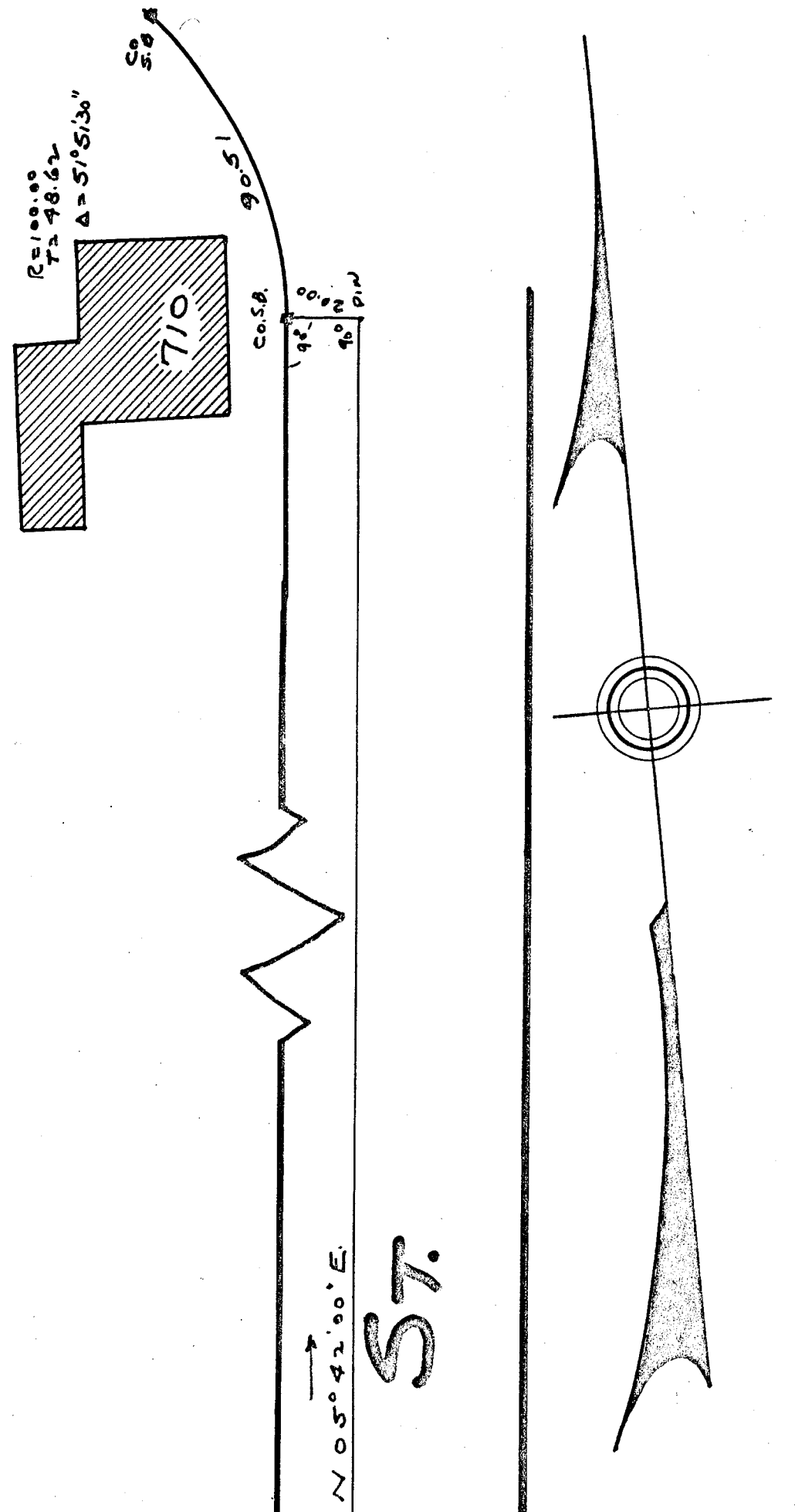

PLANNING BOARD APPROVAL UNDER  
SUBDIVISION CONTROL LAW NOT  
REQUIRED.

DATE November 3, 1960      Paul D. Zimmerman      Sec.  
PLANNING BOARD  
TOWN OF STOUGHTON MASS.

APPROVED: \_\_\_\_\_  
\_\_\_\_\_  
\_\_\_\_\_

DATE \_\_\_\_\_      BOARD OF HEALTH  
TOWN OF STOUGHTON MASS.

