

I certify that this actual survey was made on the ground in accordance with the Land Court Instructions of 1950 on or between 9/8/54 and 8/29/55
 Date: 3/12/57 Deuklin
 20 Washington St. Natick, Mass.

James E. Jr. & Mary J. Moran
 Plan Ref.
 Plan # 2940 of 1941
 Bk # 2326 pg # 406
 Norfolk Reg. of Deeds

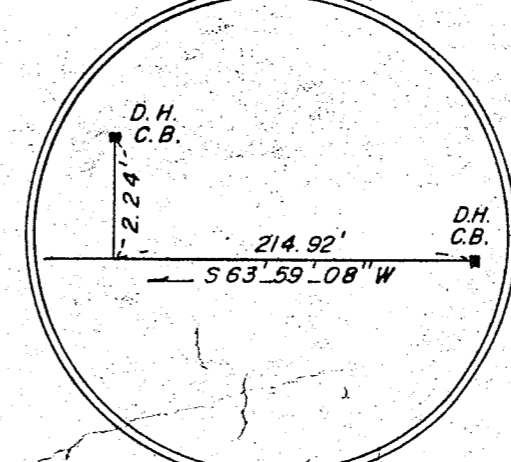

Approval under the sub-division control law not required
 Dover Planning Board
 Date: _____

Plan of Land in Dover, Mass.

LD CT 27.459-A
 Scale: 1" = 40' Mar. 8, 1957

Survey by: MacCarthy Engineering Service Inc.
 Natick, Mass.

Plan Ref.
 Plan # 1619 of 1955
 Bk # 20
 Norfolk Reg. of Deeds