

RALPH J. NASON
MECHANIC ST.
BELLINGHAM, MASS.

JOSEPH USTINOWICH
MECHANIC ST.
BELLINGHAM, MASS.

RICHARD AMBLER
MECHANIC ST.
BELLINGHAM, MASS.

WILLIAM ALLIE
BLACKSTONE ST.
BELLINGHAM, MASS.

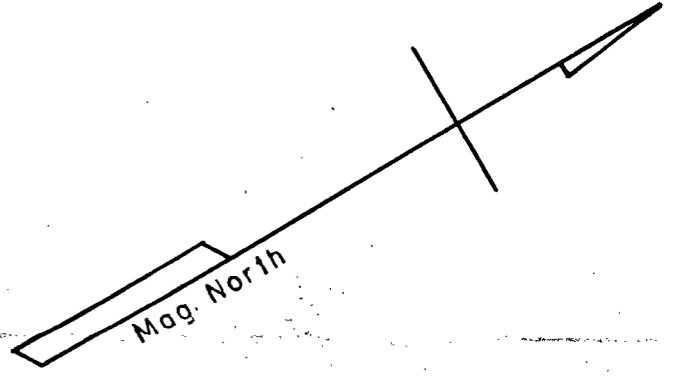

6.04
Acres

I certify that this plan was made on the ground
in accordance with the Land Court Instructions
of 1950, between July 8, 1957 and July 23, 1957.

Norman R. Vadenais

SURVEY SHOWING LAND
BELONGING TO
MARION G. SIMONEAU
BLACKSTONE ST. BELLINGHAM, MASS.
Surveyed by N.R. Vadenais, L.S.
July, 1957.
Scale: 1 inch = 40 feet.

APPROVAL NOT REQUIRED
UNDER SUBDIVISION LAW
BELLINGHAM PLANNING BOARD

Wendell J. Bates Chairman
Harold E. Phelps
Clifford E. Stines
Henry H. Spierin

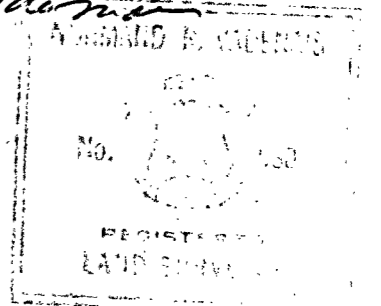

*6.04 Acres
Marion G. Simoneau
Blackstone St.
Bellingham, Mass.
- 8291 -
1/22/57*

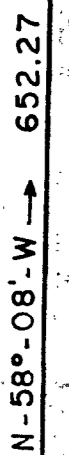
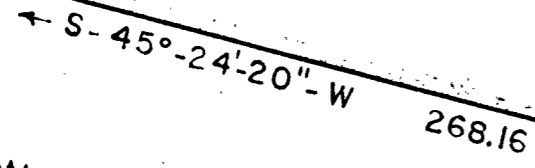
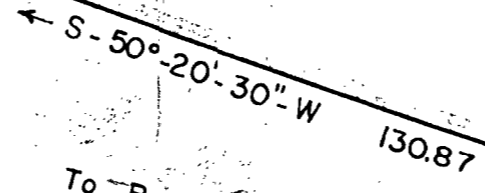
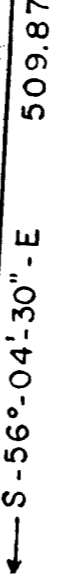
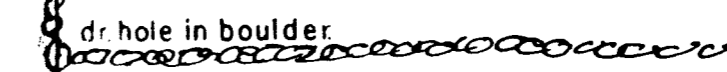
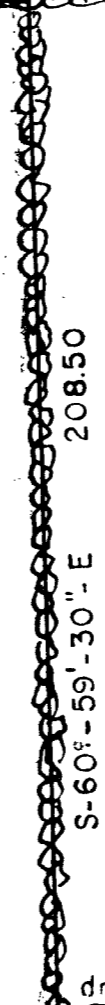
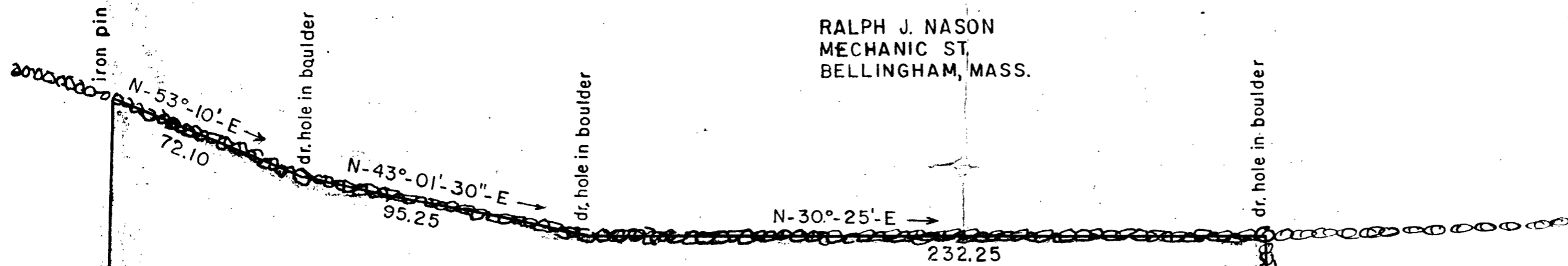

BLACKSTONE STREET
This is a public road.