

TRAVERSE TABLE

Bearing	Dist.	N	S	E	W
S 41° 42' 50" W	100.00		74.65		66.54
S 48° 17' 10" E	146.30		97.35	109.21	
N 43° 01' 52" E	100.03	73.12		68.26	
N 48° 17' 10" W	148.60	98.88			110.93
		172.00	172.00	177.47	177.47

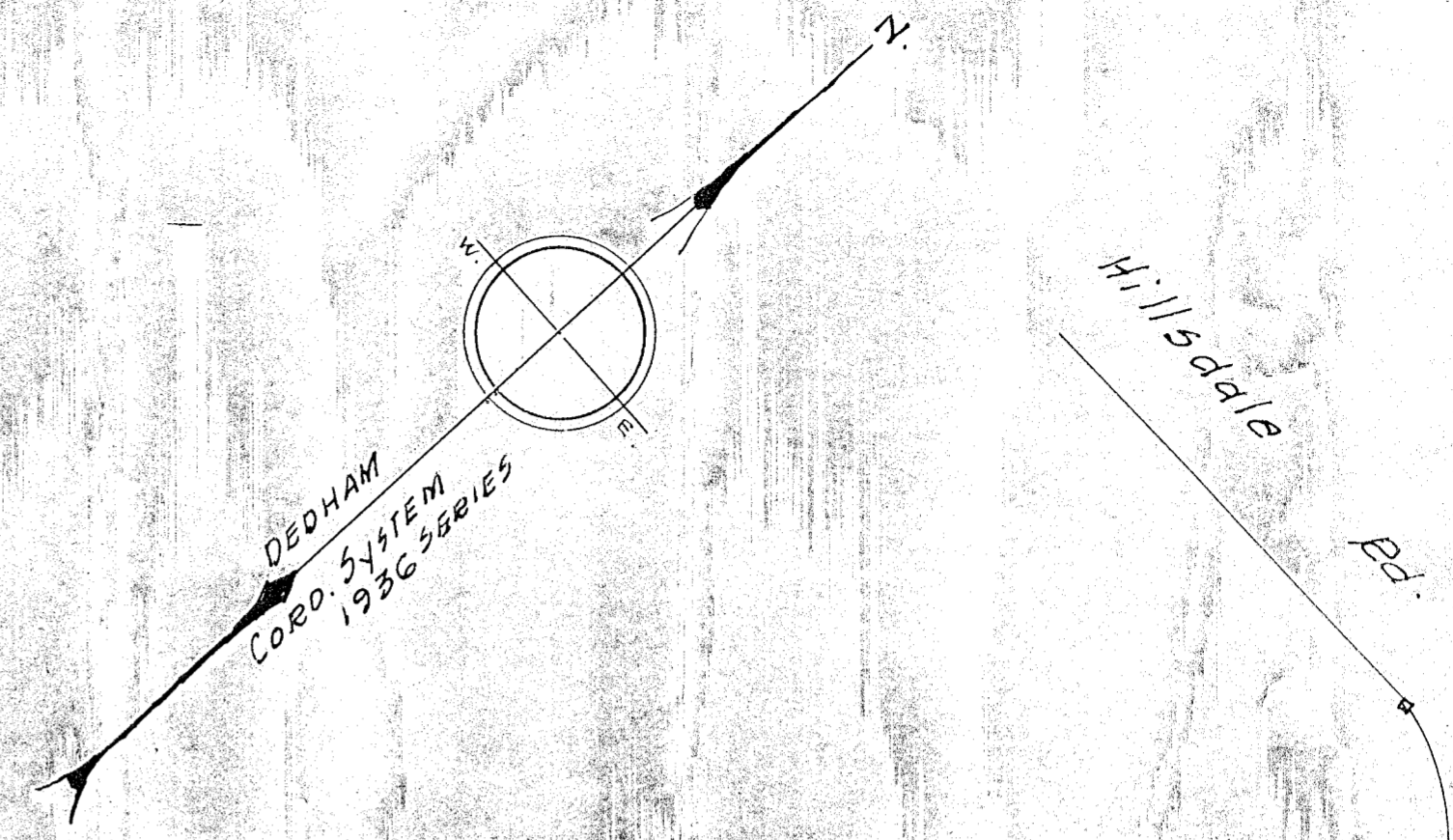

Town of Dedham

Hillary Scott SEE L.C. # 23565 A

BONHAM

Private (Public) RD.

40.00 100.00 110.00 430.53

N 41° 42' 50" E

100.00 CONC. BD.

40.00

20.00

M^S Elroy

Hoban

Lionel N 48° 17' 10" W

Catherine J.

146.30

14,745. SQ. FT.

N 43° 01' 52" E

148.60 CONC. BD.

Charles Kubilis Frank Boska

Plan of Land located in Dedham Mass.
 Scale 20ft to the inch March 29, 1958
 Charles E. Brewer C.E.
 304 Lamartine St.
 Jamaica Plain
 Mass.

Note:
 Being Lots #1071 to #1075 inc. as shown on a plan called Readville Gardens
 filed in Registry of Deeds, Norfolk County

I certify that this actual survey was made on the ground in accordance with Land
 Court Instructions of 1950 between March 15 and March 29 1958
 March 29 1958 Charles E. Brewer C.E.