

I  
82.5 ACRES

L.C. No 411E  
Lot A<sup>2</sup>  
5.4 ACRES

II  
0.5 ACRES

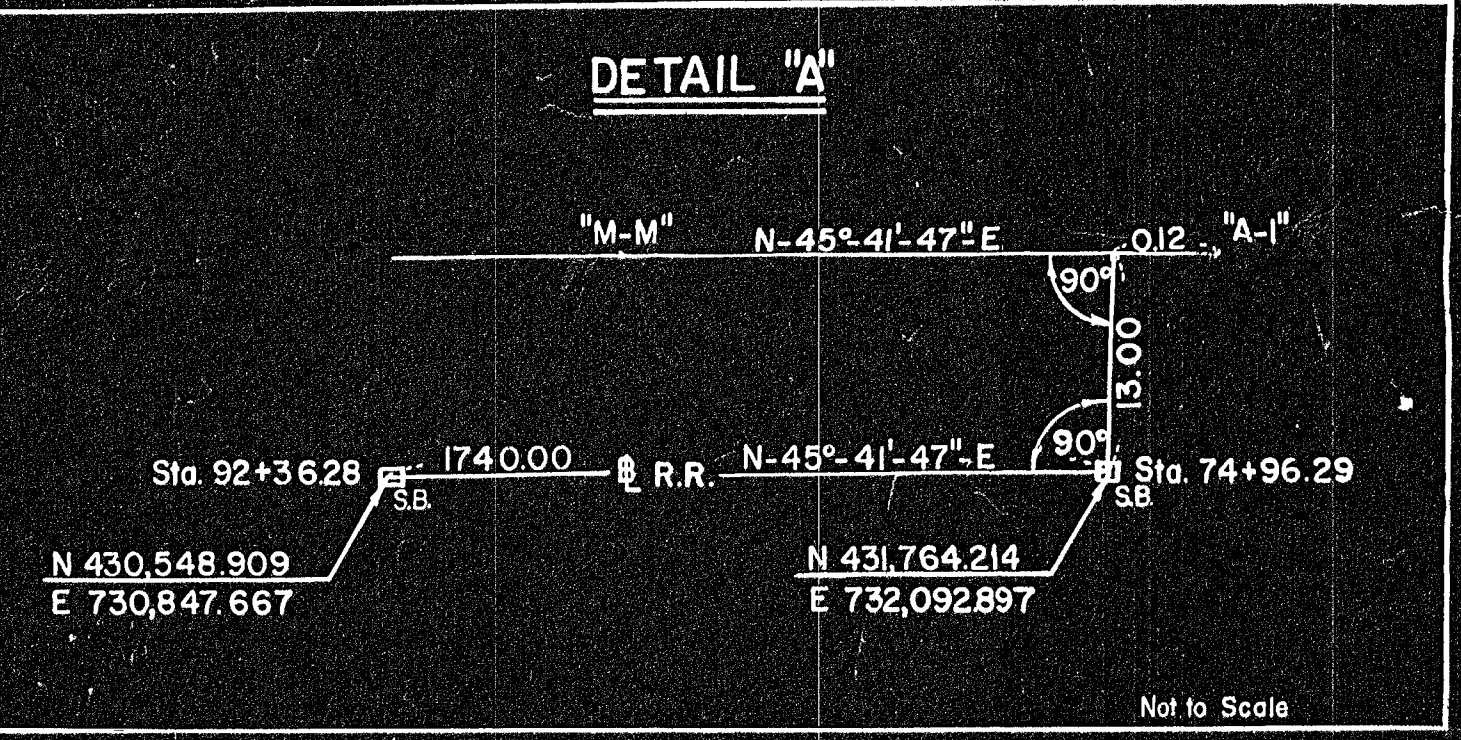

I certify that this actual survey was made on the ground in accordance with the Land Court Instructions of 1950 between June 1957 and August 1957.  
 Aug 28, 1957  
 Lucius H. Holman  
 Engineer



APPROVED UNDER THE SUBDIVISION ACT OF 1957  
 OF 26 157  
 William B. Oyer  
 William B. Oyer  
 Planning Board

Revisions of Dec. 27, 1957 Acknowledged  
 Frederick J. Day  
 Edward J. Ryan  
 William B. Oyer  
 Dec. 31, 1957.

28089  
 MAY BE FILED  
 12-31-57  
 Date By WLS  
 Braintree 1048  
 1053  
 1054

PLAN OF LAND  
 BRAINTREE MASS.  
 Scale 1"=100' August 19, 1957  
 Harry R. Feldman Inc., Engineers  
 27 School St. Boston, Mass.

NOTE: A.G.T. Co. Gas Easement and Portion of Railroad Property Line Revised as of December 27, 1957

Revised December 27, 1957.