

PLAN OF LAND IN
BROOKLINE

NORFOLK COUNTY, MASS.

SCALE 1" = 20' OCT. 21, 1957.

THE SCHUYLER CLAPP COMPANY.

BRAINTREE, MASS.

I CERTIFY THAT THIS ACTUAL SURVEY WAS MADE
 ON THE GROUND IN ACCORDANCE WITH THE LAND
 COURT INSTRUCTIONS OF 1950. ON OCT. 10 1957.

CLASS A

by *Frederick T. Webb*
 REGISTERED LAND SURVEYOR

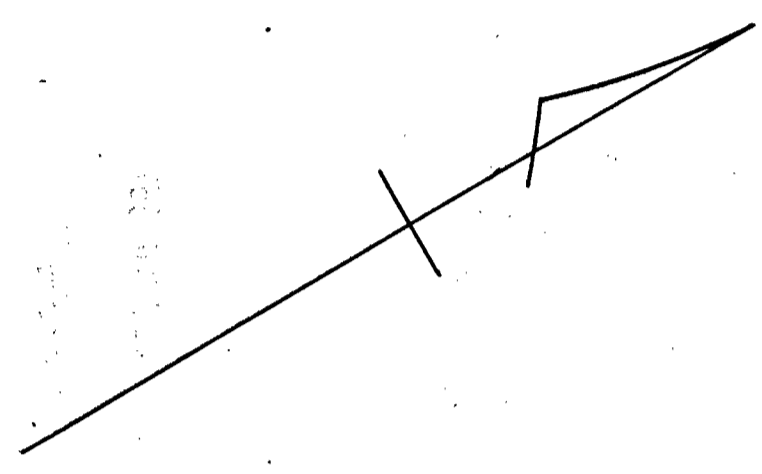

FELEX M. ORLANDELLA ET. AL. TRS.

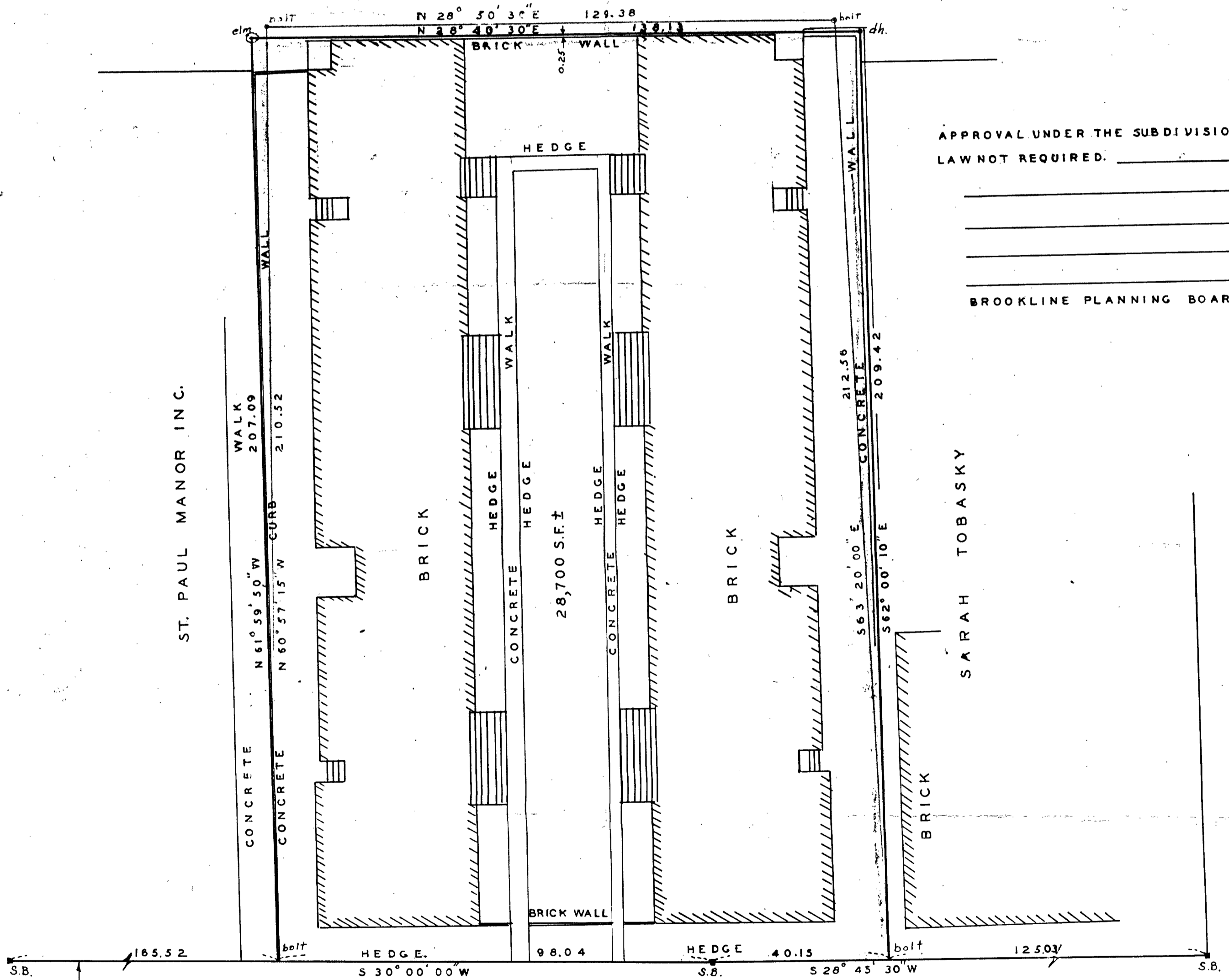

APPROVAL UNDER THE SUBDIVISION CONTROL
 LAW NOT REQUIRED. _____ 1957.

BROOKLINE PLANNING BOARD.

ST. PAUL STREET

ALTON PLACE