

40.00

SANFORD (Public) ROAD

40.00

N. 56°16'30"E.

62.50

125.00

Conc. Bd. (Plug)

T.S.

T.S.

(5)

(6)

Brick Steps

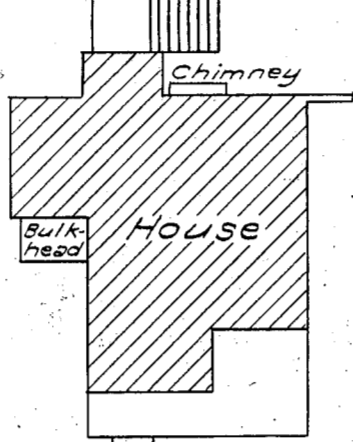

2
8750 Sq. Ft.

Anthony P. and Eleanor M. Camarra

N. 33°27'00"W.
140.00

9
8750 Sq. Ft.



Tool Shed

Old Picket Fence

125.00

N. 56°16'30"E.

(2)

Drill Hole in Stone

70.00

70.00

70.00

Jennie M. Dugan

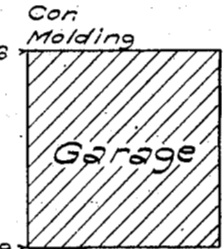

N. 33°27'00"W.
140.00

(3)

62.50

N. 56°16'30"E.

Lot 11A L.C. Plan 14708B
Jennie M. Dugan Cert. 20/89

Lot B.
Frank J. Brown Jr and Christine C. Brown
Land Court Cert. 37337
Land Court Plan 14708D

Class A Survey

Sta	Interior Angle	Defl. Angle	Azimuth	Dist	+Sine	-Sine	+Cos.	-Cos.
1	90°16'30"	89°43'30"	56°16'30"	125.00	103.96		69.40	
2	269°43'30"	-89°43'30"	326°33'00"	70.00		38.58	58.41	
3	90°16'30"	89°43'30"	56°16'30"	62.50	51.98		34.70	
4	89°43'30"	90°16'30"	146°33'00"	140.00	77.17			116.81
5	90°16'30"	89°43'30"	236°16'30"	187.50		155.95		104.10
6	89°43'30"	90°16'30"	326°33'00"	70.00		38.58	58.41	
	720°00'00"	360°00'00"			233.11	233.11	220.92	220.91

Land Court Case No. 14708

136.05

N. 32°57'00"W.

Drill Hole in Ledger

SHERMAN STREET

(Public)

(Variable widths)

SHERMAN STREET

PLAN OF LAND IN CANTON, MASS.

Scale: 20 feet to an inch. December 3, 1956.
Lewis W. Perkins & Son, Eng'rs., Hingham, Mass.

I certify that this actual survey was made on the ground in accordance with the Land Court Instructions of 1950 on December 1, 1956.

December 3, 1956. William W. Perkins Eng'r, Hingham, Mass.