

WESTWOOD PLANNING BOARD  
 Approval Under Subdivision  
 Control Law Not Required  
 Dated: Dec 8, 1955  
*Myron C. Hamer*

CANTON PLANNING BOARD  
 Approval Under Subdivision  
 Control Law Not Required  
 Dated: Dec 8, 1955  
 By *Eugene J. Galligan*  
 Town Council  
 Authorized Agent

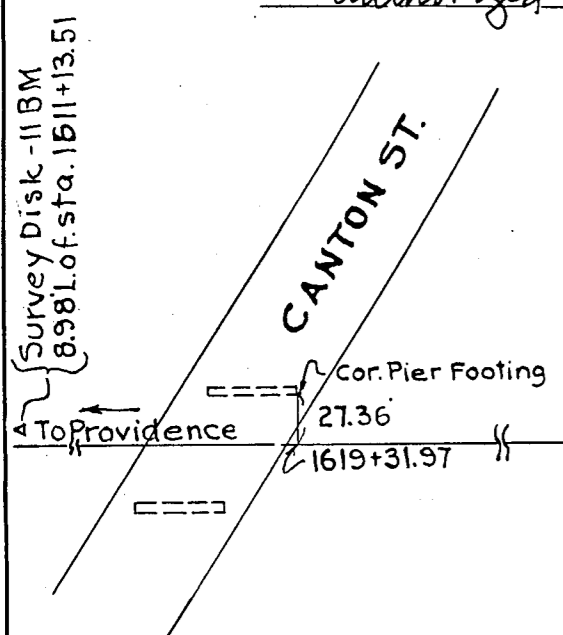

STA.	INT. ANGLE	DEF. ANGLE	BEARING	DISTANCE	+SINE	-SINE	+COSINE	-COSINE	REMARKS
1	90°-00'-00"	90°-00'-00"	NORTH	748.02			748.02		
2	117°-50'-53"	62°-09'-07"	N62°-09'-07" W	372.67	329.51		174.09		
3	222°-50'-27"	42°-50'-27"	N19°-18'-40" W	209.88	69.41		198.07		
4	127°-22'-38"	52°-37'-22"	N71°-56'-02" W	236.07	224.43		73.21		CHORD
5	139°-22'-52"	40°-37'-08"	S67°-26'-50" W	28.54	26.36		10.95		
6	252°-20'-30"	72°-20'-30"	N40°-12'-40" W	39.14	25.27		29.89		
7	150°-55'-15"	29°-04'-45"	N69°-17'-25" W	26.75	25.02		9.46		CHORD
8	69°-17'-25"	110°-42'-35"	SOUTH	1221.79				1221.79	
9	90°-00'-00"	90°-00'-00"	EAST	700.00		700.00			
TOTAL	1260°-00'-00"				700.00	700.00	1232.74	1232.74	

I hereby certify that this actual survey was made on the ground in accordance with the Land Court Instructions of 1950 on or between July 17, 1955 and Nov. 17, 1955.  
*Edward H. Thompson, Surveyor*

PLAN OF LAND  
 IN  
 WESTWOOD AND CANTON, MASS.  
 SCALE 1"=100'  
 NOV. 1955

Surveyed by: Edward H. Thompson  
 Office of Engineer-Real Estate Surveys  
 N.Y. N.H. & H.R.R. Co. South Station, Boston, Mass.

Mon. 1700+00, 0.73 L. of E.