

PLAN OF LAND IN STOUGHTON, MASS.
 Scale of 1"=50' Sept. 23, 1953.
 L.W. DeCELLE & SONS · LAND SURVEYORS
 QUINCY, MASS.

Approval Under Subdivision
 Control Law Not Required
Arthur J. Eccleston
Thomas M. Page
Charles C. Rhodes, Jr.
Richard Leonard
Amos W. Buckley
 Stoughton Planning Board Nov. 4, 1953



M.H.B. 58.8
 Nail in lead plug
 764.40
 S 1° 41' 00" W
 WASHINGTON (STATE HIGHWAY) STREET
 15 N 1° 41' 00" E
 73.50
 87.21
 60.00
 S 88° 19' 11" E
 To Stoughton Center

JAMES F. & ELSIE Mc GONAGLE
 PARCEL "A"

DONALD H. & FREDA L. MARTIN
 PARCEL "B"

PARCEL "C"
 1.54 Acres

*44
 BERNARD & IRENE A. STEINBERG

*43
 BERNARD J. RASMUSEN

ADELINA SIMONDS

81.61
 PARCEL "A"
 82.30

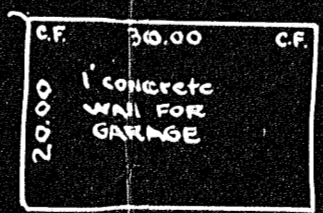
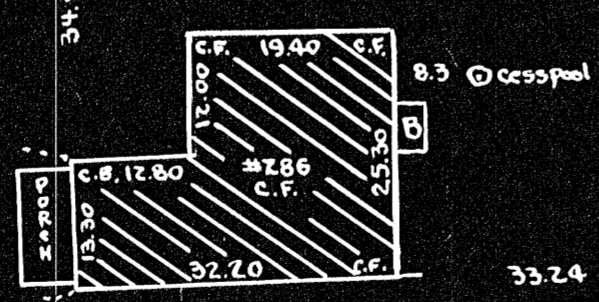
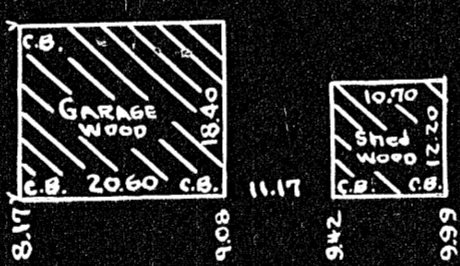

BEARING	DISTANCE	N+	S-	E+	W-
N 1° 41' E	73.50	73.468		2.159	
S 88° 22' E	932.71		26.585	932.331	
S 31° 09' W	84.46		72.282		43.689
N 88° 22' W	891.16	25.400			890.797
		98.868	98.867	934.490	934.486

WASHINGTON ST.

Scale of this sketch 1"=20'

MAY BE FILED
 Date 11/53 by JRP

I certify that this actual survey was made on the ground in accordance with the Land Court Instructions of 1950 between Sept. 17, 1953 and Sept. 20, 1953.
 Lawrence W. DeCelle, Jr.
 SURVEYOR

24636