

21848A

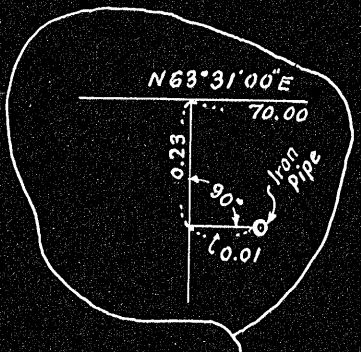

Douglas V. Green et ux.

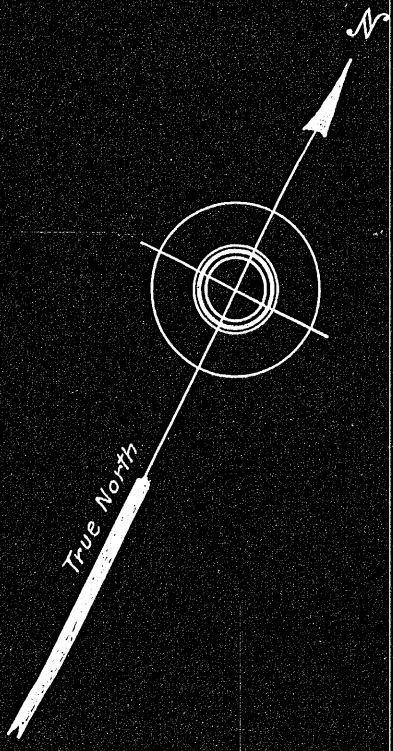
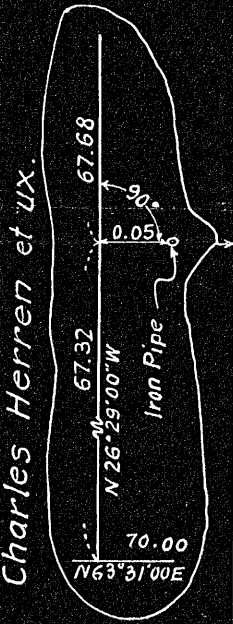
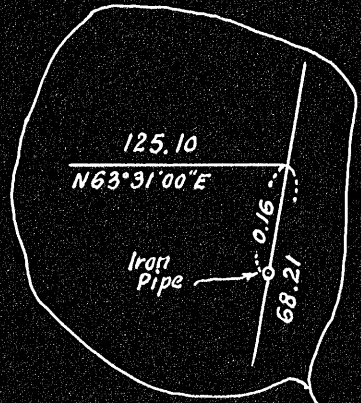

Charles Herren et ux.

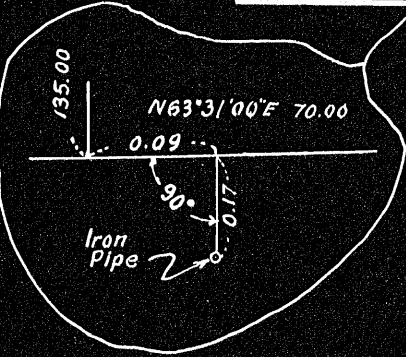

OAKVIEW

AVENUE

(TOWN WAY LAYOUT OF FEB. 16, 1948)

AREA = 9,450 Sq. Ft.

AREA = 8,113 Sq. Ft.

AREA = 7,264 Sq. Ft.

STREET

(COUNTY RE-LOCATION OF JULY 23, 1929)

EXCHANGE

PLAN OF LAND IN
MILLIS, MASSACHUSETTS

SCALE : 1" = 20'

MAY 12, 1949

Kenneth E. McIntyre - Walpole, Mass.
Reg. Civil Engineer & Reg. Land Surveyor

ORDERED	YES
INVERSE FLAG	YES
APPROVED	
DATE	
BY	
REASON	
APPROVED	

C.H.B. #21848

I certify that this survey was made in accordance with Land Court requirements.

Kenneth E. McIntyre
Reg. Civil Engineer & Reg. Land Surveyor

21848A