

671

**NATIONAL**  
410  
**CROSS SECTION BOOK**



671/2 WALPOLE AGGIE SCHOOL

Inst.	Tape	Wthr & Temp	Date	Crew
TS16		50° P. CLOUDY	4/28/2020	KTF
8167	FILE:1082-TRAV			CP MJ JM

STARTING PTS FROM BARN TOPO  
IN NB662/115

TI @ 11100 HI 5.55

BS 20104 @ 5.46

FS 1 @ 5.44 SN/SET

HZ & 145.51.34 DIST 1066.006

TI @ 11100 / BS 1 / FS 20104

HZ & 214.08.25 DIST 580.660

TI @ 5.44

BS 11100 @ 5.55

FS 2 @ 5.34 SN/SET

HZ & 146.24.34 DIST 272.605

TI @ 1 / BS 2 / FS 11100

HZ & 213.35.26 DIST 1066.006

## SOLAR PROJECT

671/3

Inst.	Tape	Wthr & Temp	Date	Crew
-------	------	-------------	------	------

SEE  
NB662  
P 115

SN  
11100

SCHOOL →

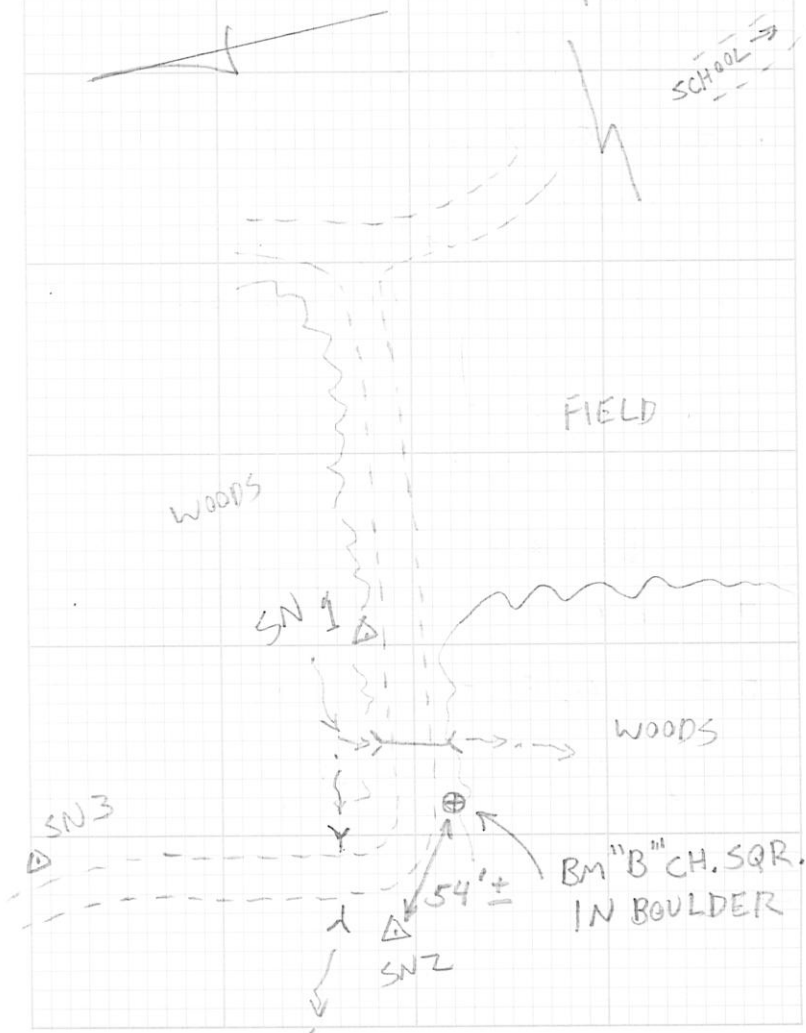

671/4 WALPOLE AGGIE SCHOOL

Inst.	Tape	Wthr & Temp	Date	Crew
TS 16 8157	108Z-TRAV		4/28/2020	RJK CP MJ JM

TCZ H1 5.34

BS 1 @ 5.44

FS 3 @ 5.32 SN/SET

HZ & 251.57.10 DIST 335.799

TCZ/BS 3/FS 1A

HZ & 108.02.49 DIST 272.601

TCZ H1 5.32

BS 2 @ 5.34

FS 4 @ 5.08 SN/SET

HZ & 171.29.16 DIST 412.610

TCZ/BS 4/FS 2A

HZ & 188.30.44 DIST 335.800

# SOLAR PROJECT

671/5

Inst.	Tape	Wthr & Temp	Date	Crew
-------	------	-------------	------	------

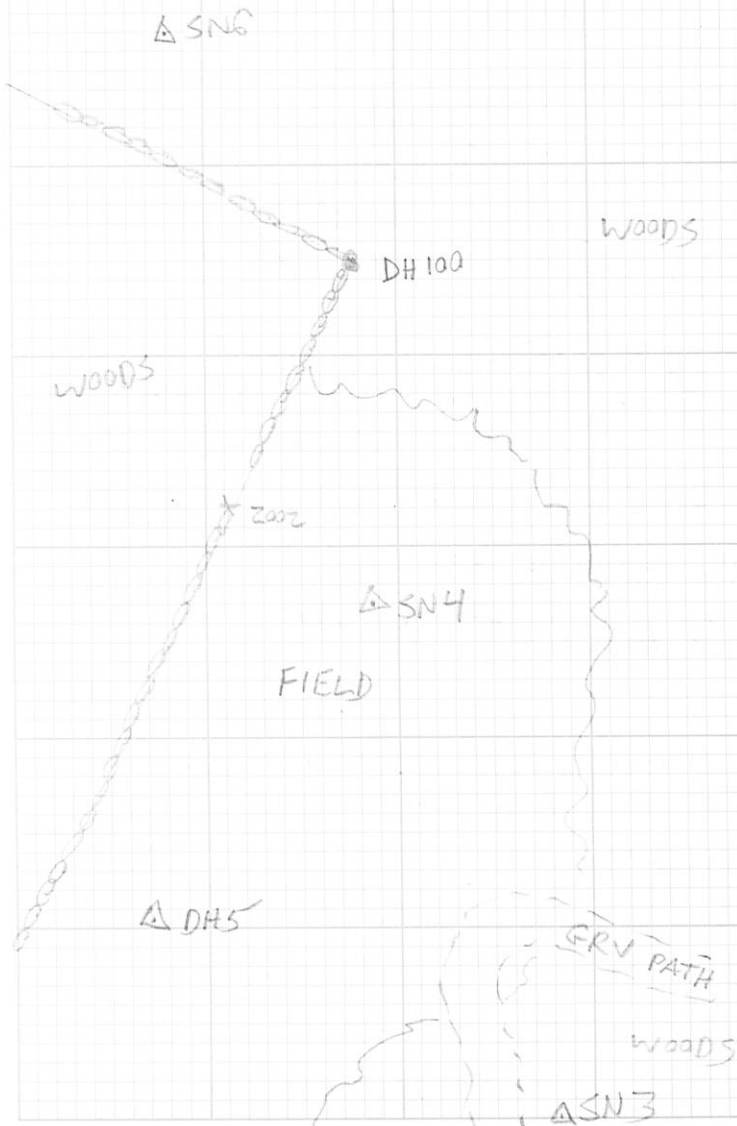



## 671/6 WALPOLE AGGIE SCHOOL

Inst.	Tape	Wthr & Temp	Date	Crew
TS16			4/28/2020	RTF
8167	FILE:1082-TRAV			CP MJ JM

T@4 HI 5.08

BS 3 @ 5.32

FS 5 @ 5.01 DH/SET

FS 6 @ 5.14 SN/SET

5: HZ &amp; 47.50.24 DIST 227.64Z

6: HZ &amp; 169.55.16 DIST 297.007

T@4/BS6/FS3A

HZ &amp; 190.04.45 DIST.

FS 5A: HZ &amp; 237.55.08 DIST.

FILE:1082 SS

T@4 HI 5.08

BS 3 @ 5.32

FS 100 @ 9.00 DH/FND

HZ &amp; 189.00.40 DIST. 193.336

SHOTS ON WALL 2000-2005

CALC DH @ 2006 STKED @ 2007

## WALPOLE AGGIE SCHOOL

671/7

Inst.	Tape	Wthr & Temp	Date	Crew
TS16		<del>45</del>	4/29/2020	RTF
8167	FILE 1082 TRAV			CP MJ JM

T@ SN-6 HI (5.30)  $H^2 = 0.004$ BS SN-4 MD (5.27)  $V = 0.002$ SN-7 239-52-24 249.231'  
(5.37)~~FILE 1082 SS~~

T@ SN-6 BS SN-4

2008 - 2012 STONE WALL

2013 MFLY SN-4 ✓OK

~~FILE 1082 TRAV~~T@ SN-7 (5.37)  $H^2 = 0.0001$ BS SN-6 (5.30)  $V = 0.0001$ SN-8 96-43-36 213.205  
(5.29)T@ SN-8 (5.29)  $H^2 = 0.00$ BS SN-7 (5.37)  $V = 0.004$ SN-9 152-52-44 169.930  
(5.02)

671/8

## WALPOLE AGGIE SCHOOL

Inst.	Tape	Wthr & Temp	Date	Crew
TS16		X 50°	4/29/2020	RF
5167	# FILE	1082 55 #		CP
				MJ
				JM
		X @ SN-8 (5.29)		
		BS SN-7 (5.37)		
101		268-44-48	73.615	

XCUT FND IN STONE WALL

102 138-06-07 145.258

DH IN STONE WALL

2014-2018 SHOTS ON STONEWALL

2019 O/MFLY ON SN-7

# FILE 1082 TRAY #

X @ SN-9 (5.02)

BS SN-8 (5.29)

SN-10 88-40-36 392.000  
(5.24)

# FILE 1082 55 #

X @ SN-9 (5.02)

BS SN-8 (5.29)

103 294-56-52 75.288

DH IN STONE WALL

104 224-50-16 94.184

DH IN STONEWALL

WALPOLE  
AGGIE SCHOOL

671/9

Inst.	Tape	Wthr & Temp	Date	Crew
			4/27/2020	RF
		FILE 1082 55		CP
		X @ SN-9 BS SN-8 (CONT.)		MJ
105		212-40-54	130.764	
		DH IN STONEWALL	1	

2020 SHOT ON STONE WALL

2021-2022 OPENING IN STONE WALL

2023-2025 SHOTS ALONG ON STONEWALL

2026 MFLY O/V ON SN-8

FILE: 1082-TRAY

X @ 10 H 5.24

BS 9 @ 5.02

FS 11 @ 5.19 SN/SET

H2# 124.01.40 DIST. 238.466'

FILE: 1082-55

X @ 10 / BS 9

FS 106 DH/FND X= 24" 18"-29"

FS DIST= 26.126'

2027-2029

2030 MFLY

671/10 WALPOLE AGGIE SCHOOL

Inst.	Tape	Wthr & Temp	Date	Crew
TS16		45° RAIN	4/30/2020	ATP
8157	FILE:1082-TRAV			MT CP

TE11 HI 5.14

BS 10 @ 5.16

FS 12 @ 5.20 SN/SET

HZ 177.18.23 DIST. 133.196

TE 12 HI 5.20

BS 11 @ 5.14

FS 4A @ 5.42

HZ 131.35.57 DIST. 123.624

TE 4 @ 5.42

BS 12 @ 5.20

FS 6A @ 5.32

FS 3B @ 5.28

6A HZ 5 18.39.24 DIST 27.944

7B HZ 2 258.39.02 DIST 40.599

SOUTH PROJECT

671/11

Inst.	Tape	Wthr & Temp	Date	Crew
			4/30/2020	

TE 4 @ 5.42

BS 3 @ 5.16

FS 12 @ 5.20

HZ 131.35.57 DIST 123.624



671/14

VOID  
WALPOLE SOLAR

Inst.	Tape	Wthr & Temp	Date	Crew
LS15		CLEAR 60°	5/4/2020	CP RF MJ
		1082-SOLAR.		
		LINE 001		

DIST	BS	HI	FS	DIST
160.41	5.3544	175.4999		
111.44	4.8352	174.9752		
118.67	2.4474	171.7279	5.6946	114.08
77.32	5.8329	171.3304	6.2304	133.68
84.52	1.321	167.3098	5.3420	80.13
<del>164.11</del>	<del>5.750</del>	<del>160.4409</del>	<del>9.8786</del>	<del>102.18</del>
			<del>3.9430</del>	<del>175.23</del>
		LINE 003		

85.47	1.1987	167.1871		
180.17	6.0987	163.2199	10.0658	111.422
147.31	9.4055	162.8655	3.7600	195.99
187.48	2.8073	166.7947	5.3780	184.93
130.06	3.2417	160.3245	9.2119	187.16
24.71	5.6641	158.7247	7.2639	142.70
69.56	3.0916	158.3859	3.4304	29.51
111.53	11.4291	156.7378	1.6534	88.46
199.75	7.6364	174.6232	1.1748	111.85
30.39	6.2673	177.4802	3.4103	181.55
			3.9620	25.60

VOID

671/15

Inst.	Tape	Wthr & Temp	Date	Crew
-------	------	-------------	------	------

(NAVD 88)

ELEV.	REMARKS
170.14	MAG NL # 4 (BY WINDMILL) (20104)
170.1400	MAG NL # 4 (20104) (BY WINDMILL)
169.2806	MAG NL # (20103)
165.4975	TURTEL (1000)
165.9884	STN (11100)
<del>166.1912</del>	<del>TURTEL (1001)</del>
<del>164.3839</del>	<del>TURTEL (1002)</del>
165.9884	STN (11100)
157.1213	TURTEL (1001)
159.4600	TURTEL (1002)
163.4874	TURTEL (1003)
157.0828	MSTN (1)
153.0606	MSTN (2)
155.2943	MBRK. (1004) (CHS 52) Bm "B" SKETCH P. 3
156.7326	TURTEL (1005)
166.9869	MSTN (3)
171.2129	<del>MSTN (4)</del> TURTEL (1006)
173.5183	MSTN (4)



671/16

VOID  
WALPOLE AGGREG SOLAR.

Inst. Tape Wthr & Temp Date Crew  
 LS15 CLEAR - 60° 5/4/2020  
 1082-SOLAR. CP/RF/MT

DIST	BS	HI	FS	DIST
115.29	3.6817	177.1999		
34.86	4.4544	176.1162	5.5382	127.20
			4.6857	40.10
115.15	10.2329	181.6634	3.4344	133.98
114.22	3.6168	181.8459	3.5493	98.99
73.22	4.5790	182.8756	9.5619	96.79
16.25	6.1969	179.5106	2.5727	18.58

LS15

CLEAR 33°  
 1082-SOLAR. S/S/2020

DIST	BS	HI	FS	DIST
21.36	2.5083	179.4462		
112.31	3.1783	176.4909	6.1336	14.40
83.06	6.9623	175.1941	8.2591	117.14
50.89	4.9088	176.5559	3.5469	79.94
47.76	3.6149	171.5925	8.5783	42.94
66.49	8.0898	170.5314	9.1508	52.03
60.05	6.5895	174.9213	2.1996	67.72
53.51	6.5212	177.5099	3.9326	95.29
93.60	3.4080	177.0991	3.8188	51.57
100.24	10.1138	176.8957	10.3174	100.33
171.74	3.6718	174.3765	6.910	118.57
			7.3948	159.69

VOID

671/17

Inst. Tape Wthr & Temp Date Crew  
 LINE 003 (NAVD 88)

ELEV.	REMARKS
173.5183	MSTN (4)
171.6617	TURTEL (1007)
171.4305	MSTN (6)
178.2291	MSTN (7)
178.2966	MSTN (8)
173.3138	MSTN (9)
176.9379	MBMK (1008) MAG SPIKE N.E. SIDETWIN OAK 20+ 14 1' FT UP. BM "D" SKETCH P. 13

LINE 003 (NAVD 88)

ELEV.	REMARKS
176.9379	MBMK (1008)
173.3126	MSTN (9)
168.2318	TURTEL (1009) T.P.
171.6472	MSTN (10)
167.9776	TURTEL (1010)
162.4416	MBMK CHISEL SQ (1011) BM "C" SKETCH P. 13
168.3318	MSTN (11)
170.9887	MSTN (12)
173.6911	MBMK (1012) BM "A" SKETCH P. 24
166.7818	MDL (1013)
170.7046	TURTEL (1014)
166.9817	MSTN (3)

671/18

VOID

Inst. Tape Wthr &amp; Temp Date Crew

DS	BS	HI	FS	DIST
86.62	1.7551	168.7368		
59.36	1.3244	160.9059	9.1553	106.67
26.19	5.5704	158.6122	7.8640	88.93
34.88	3.8920	159.1778	3.3264	27.48
66.95	5.7594	160.9961	3.9412	58.24
266.70	10.4523	167.5171	3.9312	68.22
94.28	3.7203	167.8873	3.3502	259.98
152.59	2.2403	160.6773	9.45029	113.254
84.53	6.6219	163.5427	3.7565	169.58
39.45	8.5707	169.2442	2.8692	79.48
138.62	4.4400	170.4107	3.2735	34.28
77.28	5.0601	171.4348	4.0360	141.64
113.64	5.8126	175.1361	2.1712	63.73
			5.0143	112.17

VOID

671/19

Inst. Tape Wthr &amp; Temp Date Crew

ELEV.	REMARKS.
166.9817	MSTN (3)
159.5815	TURTEL (1014)
153.0419	MSTN (2)
155.2859	MBMK (1004)
155.2307	TURTEL (1015)
157.0649	MSTN (1)
164.1670	TURTEL (1016)
158.4370	TURTEL (1017)
156.9208	TURTEL (1018)
160.6735	TURTEL (1019)
145.9707	MSTN (11100)
166.3747	TURTEL (1020)
169.2635	MAG. (20103)
170.1218	MAG. (20104)
	(0.018)

671/20

WALPOLE

AGGIE SCHOOL

Inst.	Tape	Wthr & Temp	Date	Crew
TSIC		P. CLOUDY 50'S	5/6/2020	RTF
8167		FILE: 108Z TOPO 050620		CP MJ

TC5 HI 4.78 BS4 @ 5.50

P#2031 MBMK "A" RIVIT IN LEDGE  
GOOD ELEV. CHECK

2031 - 2039 STONE WALL

2039 CART PATH 8' WIDE

2095 MFLY SN-4  $\checkmark$   $H = 0.02$   
 $V = 0.00$

TC SN-12 HI 4.99  
BS SN-11 @ 5.50

P#S 2096 - 2132 2133 MFLY 4

2110-2113 OLD STONE FOUNDATION

671/21

Inst.	Tape	Wthr & Temp	Date	Crew
-------	------	-------------	------	------





671/22 WALPOLE AGGIE SCHOOL

Inst.	Tape	Wthr & Temp	Date	Crew
TS16		P. CLOUDY 50'S	5/7/2020	RTF
8167		FILE: 1082TOP00050720		MJ CP

KE3 HI 5.21

BS2 @ 6.0

PTS 2134-2268  
2269 MFLY #2

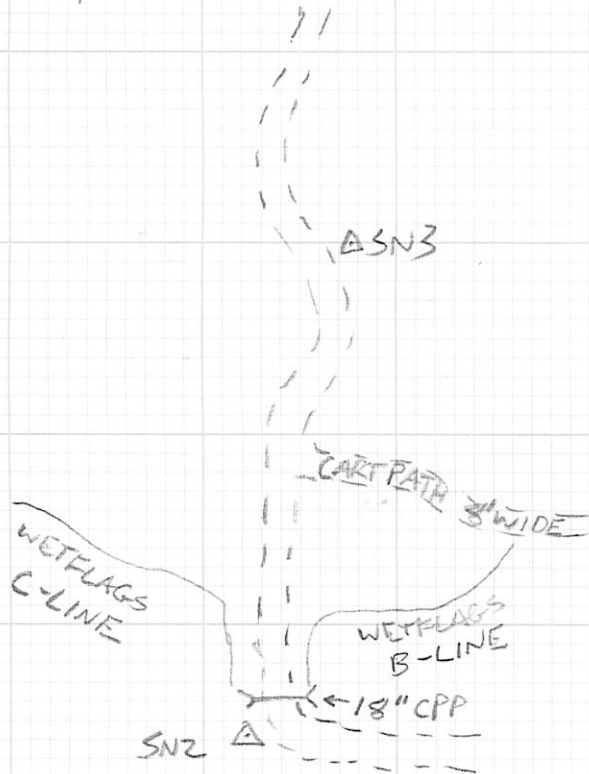

WALPOLE AGGIE SCHOOL

671/23

Inst.	Tape	Wthr & Temp	Date	Crew
TS16		☀ 50-60	5/3/2020	MJ
8167		FILE: 1082TOP00050820		CP RTF

KE @ SN-4 (5.09)

BS SN-3 (6.00)

2270 START TOPO 2387 END TOPO

SN-13 334-46-21 225.087  
SET EL = 167.987  
(6.00 T.H.)

2385 MFLY DH-5 H=0.01 ✓  
V=0.004 ✓

KE SN-13 (5.19)  
BS SN-4 (6.00)

\* INV ✓ ON BS H=0.00  
V=0.008 \* ✓ MD

2386 START TOPO MFLY SN-4  
H=0.01 V=0.09 ✓

2387 START TOPO

2469 END TOPO

2470 MFLY SN-4 ✓ H=0.02  
V=0.07

671/24

WALPOLE AGGIE SCHOOL

Inst.	Tape	Wthr & Temp	Date	Crew
		OVERCAST 50°		

WALPOLE AGGIE TOPO

671/25

Inst.	Tape	Wthr & Temp	Date	Crew
TS16		CLOUDY 50'S	5/8/2020	RTF
2997		FILE:108Z-TOPO-2997		MJ CP

$\pi @ 2$  H15.30 BS1@6.0

PTS 6000-6055 MFLY#3 (6056)

$\pi @ 11$  H15.28 BS12@6.0

PTS 6057-6096 MFLY#10 (6097)

$\pi @ 10$  H15.31 BS11@6.0

PTS 6098-6169 MFLY#9 (6170)



671/26

WALPOLE, AGGIE TOPO

Inst.	Tape	Wthr & Temp	Date	Crew
TS 16	25	45-55	5/12/2020	MJ
8167	FILE: 1082-TOPO050820			RT CP

T @ SN-6 (5.12)  
 BS SN-4 (6.00)

2471 - 2563 TOPO  
 2564 MFLY SN-7 INV ✓  
 $H < 0.006V$   
 $V < 0.005V$

T @ SN-7 (4.88) INV ✓  
 BS SN-6 (6.00)

2565 - <sup>2615</sup>2616 TOPO

2616 MFLY SN-8 INV ✓  $H = 0.01$  ✓  
 $V = 0.01$  ✓

TS 16 50° P. CLOUDY 5/12/2020  
 2997 FILE: 1082-TOPO-2997

T @ 9 HI 5.47  
 BS 8 @ 6.0

PTS 6171-6264  
 6265 MFLY 8

6260 BM "D" MAG SPIKE

WALPOLE, AGGIE

671/27

Inst.	Tape	Wthr & Temp	Date	Crew
TS 16	29	55°	5/19/2020	MJ
2997	FILE: 1082-TOPO051920			CP

T @ DH 5 (4.78)  
 BS SN-4 (7.00)

SN-14 241-37-28 148.344  
 (7.00)

2617 MFLY SN-4 ✓

T @ SN-14 (5.16)

BS DH-5 (6.92)

2618 - 2634 TOPO / WET FLAGS

2635 MFLY DH-5 INV ✓ GOOD

T @ SN-9 (5.17)  
 BS SN-8 (6.00)

2636 - 2639 TOPO / WET FLAG

2640 MFLY SN-10 (6.00) INV ✓  
 $H = 0.02$   
 $V = 0.01$



671/30 BROOKLINE

Inst.	Tape	Wthr & Temp	Date	Crew
GS16 6646		P. CLOUDY 80'S	7/8/2020	RTF MJ
TS16 8167	RTK FILE: 1080-7-8-2020			
2 MIN. RTK ON SN1, SN2, BND3				
DC FILES: 1080-TRAV/1080-SS				

$\pi$ @ SN2 HI = 5.17  
 BS SN1 @ 3.55  
 FS BND3 @ 5.31

HZ  $\times$  170.48.00  
 DIST 328.315

$\pi$ @ Z

BS 3  
 FS 1  
 HZ  $\times$  189.12.00  
 DIST. 347.964

$\pi$ @ Z BS 1 FS 3A

$\pi$ @ Z BS 1	SIDESHOTS		
FS 100-5.10	HZ $\times$ 7.38.24	DIST 90.99	
101-5.10	HZ $\times$ 21.03.29	DIST 247.81	
102-5.35	HZ $\times$ 151.54.38	DIST 165.94	

WASHINGTON ST

671/31

Inst.	Tape	Wthr & Temp	Date	Crew
-------	------	-------------	------	------

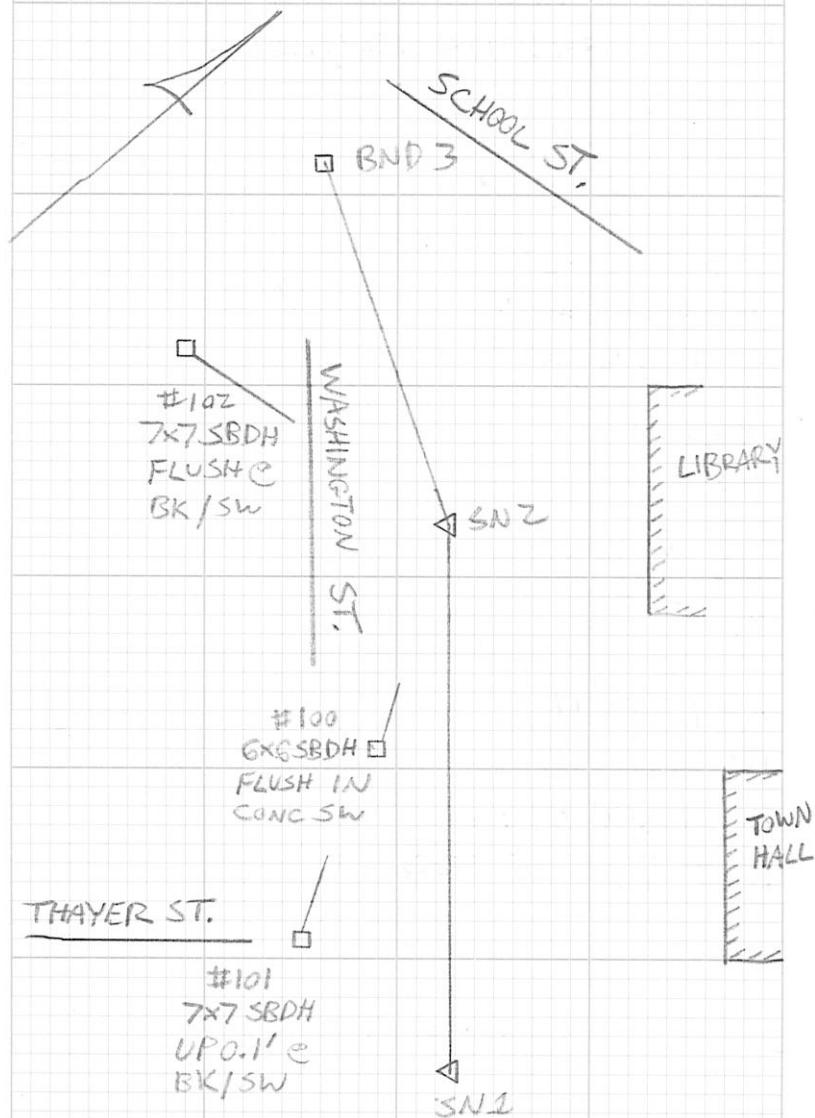

#102  
 7x7 SBDH  
 FLUSH @  
 BK/SW

#100  
 6x6 SBDH  
 FLUSH IN  
 CONC SW

#101  
 7x7 SBDH  
 UP 0.1' @  
 BK/SW

671/32

## BROOKLINE

Inst.	Tape	Wthr & Temp	Date	Crew
TSIG		P. CLOUDY 80's	7/10/2020	RXF
8167		FILE: 1080-TRAV/1080-SS		MJ
				CP

Tel HI = 4.95

BS 2 @ 4.24

FS 4 @ 5.27 DH SET IN BRICK

HZ &amp; 171.36.15

DIST 306.337

Tel

BS 4

FS 2

HZ &amp; 188.23.47

DIST. 347.960

Tel BS 4

SIDESHOT

FS 103

HZ &amp; 346.51.15

DIST 93.187

671/33

Inst.	Tape	Wthr & Temp	Date	Crew
		SN 2		

▲ SN 2

▲ SN 1

#103

HOLDEN ST.

DH 4

#284  
WASHINGTON  
ST.TOWN  
HALL

671/34

## BROOKLINE

Inst.	Tape	Wthr & Temp	Date	Crew
TS1C			7/10/2020	RTE
8167				MJ
				CP

Te4 H1 5.67

BS1 @ 4.95

FS 5 @ 6.34 MN FND

HZ &amp; 170.29.25

DIST. 163.100

Te4

BS 5

FS 1A

HZ &amp; 189.30.36

DIST 306.372

Te4 BS1 SIDESHOTS

FS 104 5.10 HZ &amp; 84.23.55 DIST 53.564

105 5.10 HZ &amp; 10.03.40 DIST 115.287

Te5 H1 5.63 HZ &amp; 231.24.57

BS4 @ 6.12 DIST 400.154

FS 6 @ 5.26

Te5 HZ &amp; 128.35.03

BS6 DIST 163.100 096

FS 4A

671/35

## WASHINGTON ST

Inst.	Tape	Wthr & Temp	Date	Crew
-------	------	-------------	------	------

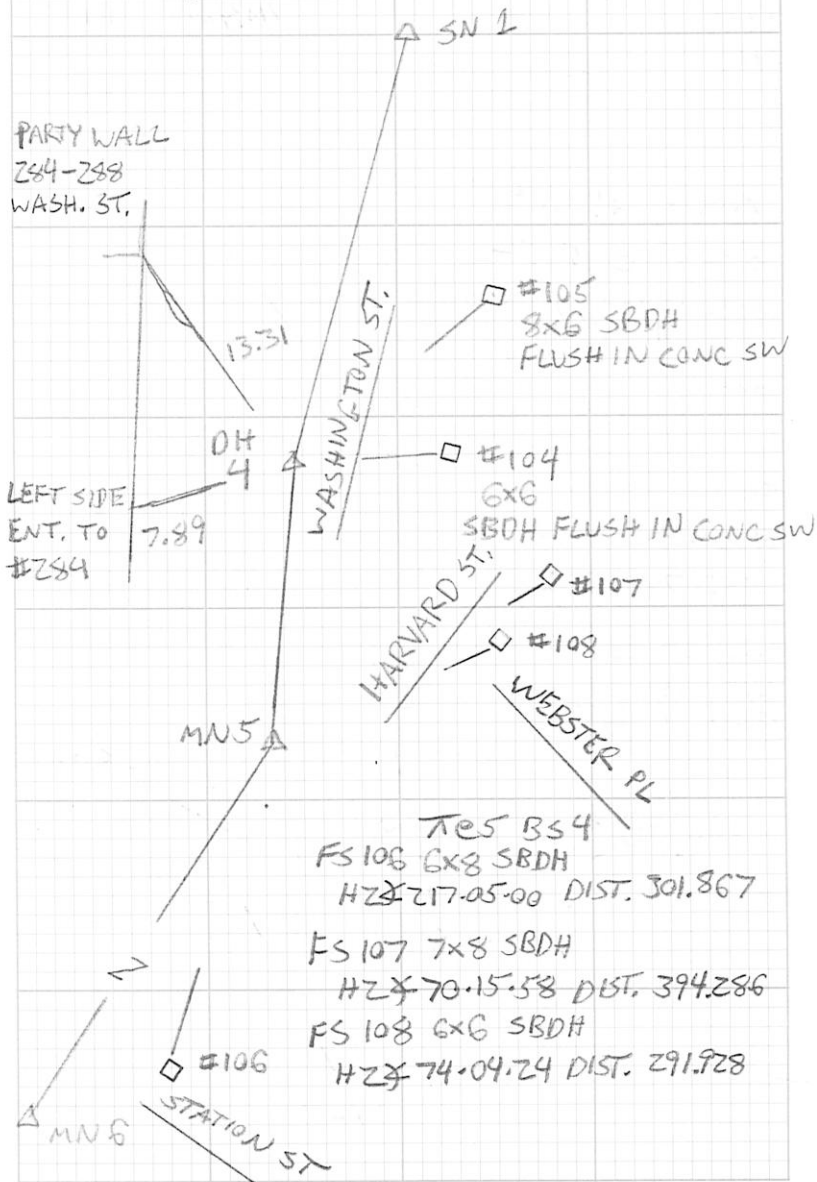



671/36 BROOKLINE

Inst.	Tape	Wthr & Temp	Date	Crew
TS16		CLOUDY 80'S	7/13/2020	RFF
8167		FILE:1080_SS		MJ
				CP

Te6 HI=5.40

B35 @ 5.55

FS 109-5.10 6x6 SBDH FLUSH IN CONC SW  
HZ & 291.39.14 DIST. 105.032

FS 110-5.10 8x8 SBDH FLUSH IN CONC SW  
HZ & 48.55.04 DIST. 178.035

FS 111-7.0 6x6 CBDH  
HZ & 4.54.44  
DIST 786.582

112-BM 884  
ROC/BBS  
#235 WASH. ST.

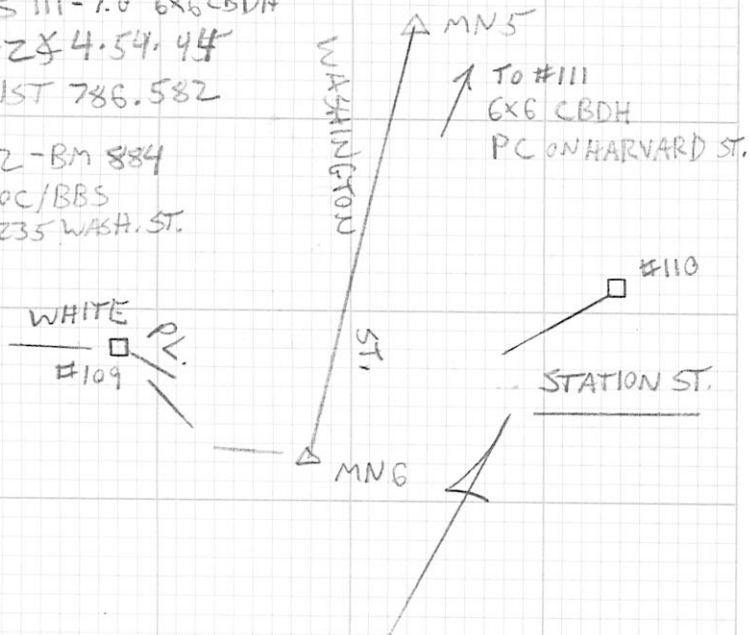

WASHINGTON ST.

671/37

Inst.	Tape	Wthr & Temp	Date	Crew

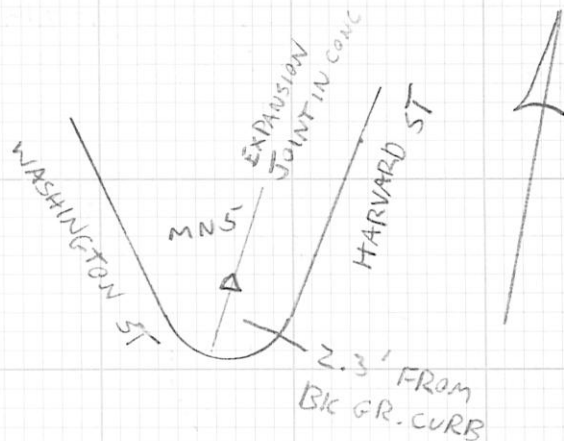
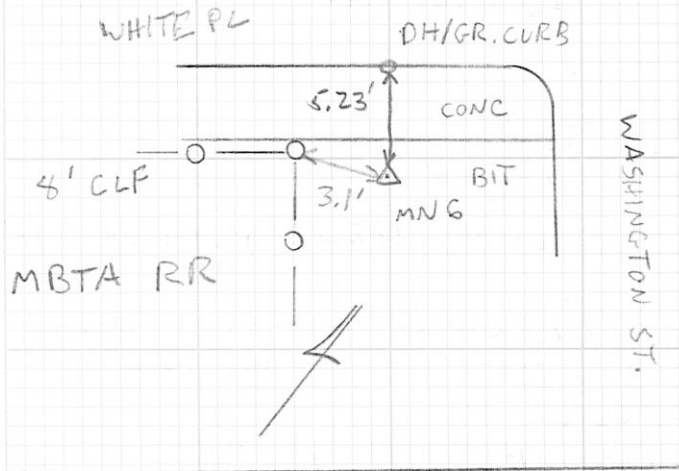



671/38

## BROOKLINE

Inst.	Tape	Wthr & Temp	Date	Crew
TS16		P. CLOUDY 80'S	7/14/2020	RTP
8167	FILE:1080-TRAV			MJ
	1080-SS			CP

Te3 H14.87

BSZ @ 5.25 #7 = DH/SET

FS 7 @ 5.16 HZ &amp; 162.59.54 DIST. 244.504

Te3/BS7/FS 2AHZ &amp; 197.00.06 DIST. 328.31Z

Te3/BSZ

SIDESHOTS

FS 113 - 8.0 HZ &amp; 117.16.00 DIST. 68.939

FS 114 - 5.1 HZ &amp; 245.37.58 DIST. 46.423

FS 115 - 5.1 HZ &amp; 297.22.12 DIST. 214.85Z

FS 116 - 5.1 HZ &amp; 277.37.17 DIST. 155.181

FS 117 - 5.1 HZ &amp; 284.10.29 DIST. 222.006

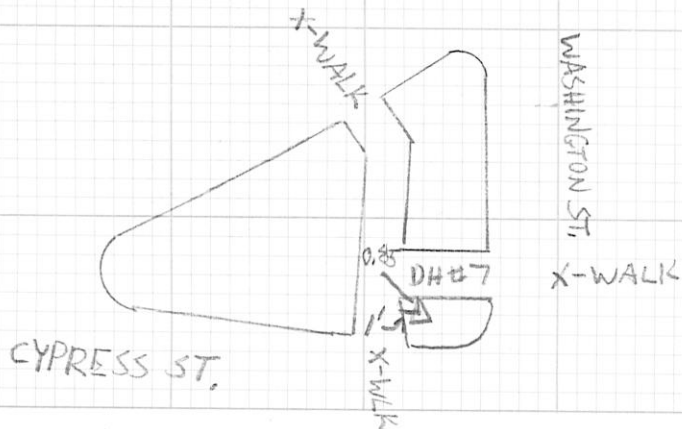

671/39

## WASHINGTON ST.

Inst.	Tape	Wthr & Temp	Date	Crew
-------	------	-------------	------	------

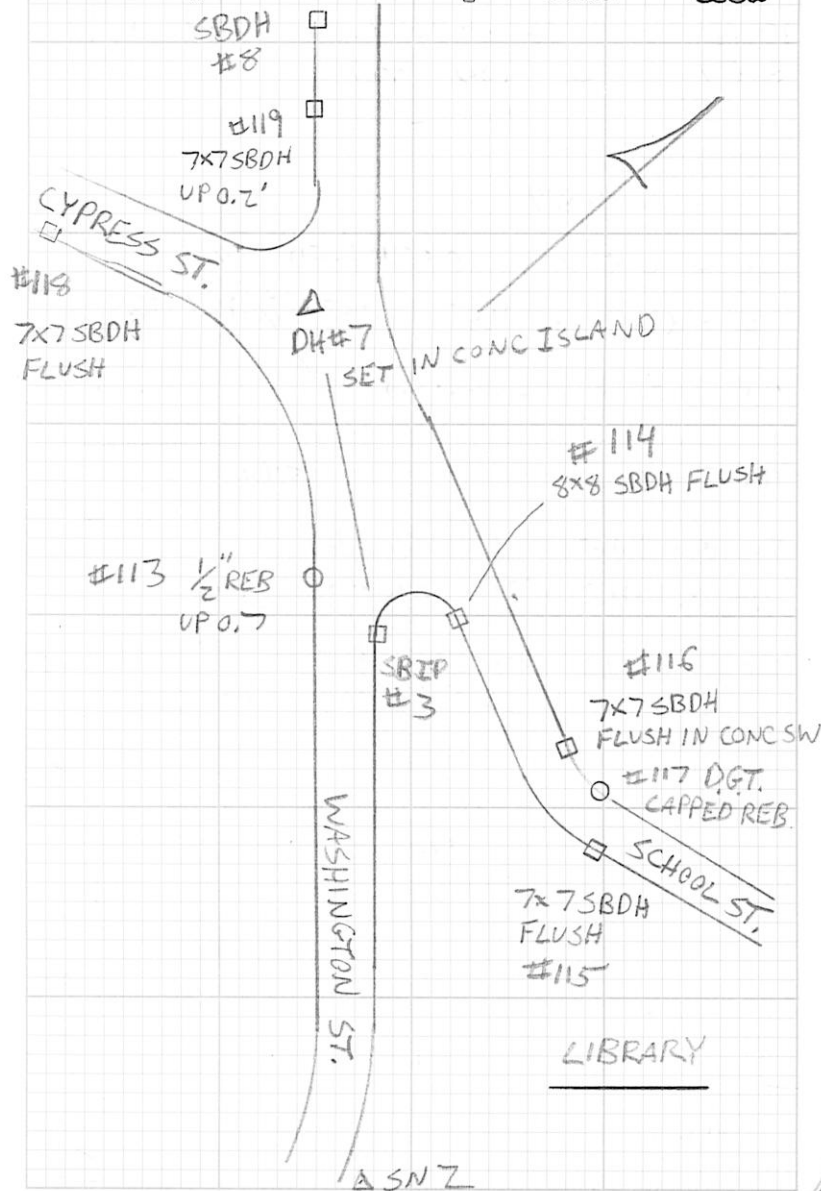

671/40 BROOKLINE

Inst.	Tape	Wthr & Temp	Date	Crew
TS16		P. CLOUDY 80'S	7/14/2020	RIF
8167		1080-TRAV		MS
		1080-SS		CP

πe7 HI 5.16

BS 3 @ 4.87

FS 8 @ 5.35 6x6 SBDH-FD

HZ &amp; 191.16.25 DIST 261.792

πe7/BS 8/FS 3B HZ &amp; 168.43.34 DIST 244.504

πe7/BS 3

SIDESHOTS

FS 118-5.10 7x7 SBDH FLUSH

HZ &amp; 101.24.53 DIST 235.178

FS 119-5.10 7x7 SBDH UP 0.2'

HZ &amp; 190.40.37 DIST. 190.117

WASHINGTON ST.

671/41

Inst.	Tape	Wthr & Temp	Date	Crew
TS16		CLOUDY 70'S	7/15/2020	RIF
8167	FILE:	1080-TRAV		MS
		1080-SS		CP

πe8 HI=5.56

BS 7 @ 5.44

FS 9 @ 5.33 DH-SET

HZ &amp; 201.14.33 DIST 276.549

πe8/BS 9/FS 7A

HZ &amp; 158.45.26 DIST 261.788

πe8/BS 9

FS 120-5.10 5x6 SBDH FLUSH IN

CONC SW

HALF UNDER CONC CURB

HZ &amp; 58.52.45 DIST 58.000

#416 WASHINGTON

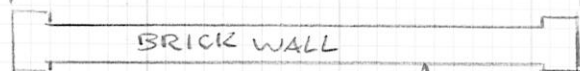
BRICK  
WALKGRV  
DW

BIT WALK

2.37' 9.40'  
BND #8

671/42 BROOKLINE

Inst.	Tape	Wthr & Temp	Date	Crew
TS16 S167		CLOUDY 70'S	#416	CHURCH OF CHRIST
DH# 7A			SBDH #119	BND #8
				WASHINGTON ST
			SBDH #120	

Te9 HI 5.33  
 BS8 @ 5.56  
 FS10 @ 5.25  
 HZ# 200.18.39 DIST. 387.580

Te9/BS10/FS8A  
 HZ# 159.41.21 DIST. 276.550

Te9/BS10 SIDESHOTS

FS 121 - 5.10 HZ# 245.48.33 DIST. 47.258

FS 122 - HZ# 173.06.56 DIST. 137.573

FS 123 - 6.0 HZ# 6.25.29 DIST. 246.235

Te10 HI = 5.25/BS9 @ 5.33/FS11 @ 5.52

HZ# 162.44.13 DIST 333.015

Te10/BS11/FS9A

HZ# 197.15.47 DIST 387.576

WASHINGTON ST.

671/43

Inst.	Tape	Wthr & Temp	Date	Crew
			7/15/2020	RTF MJ CP

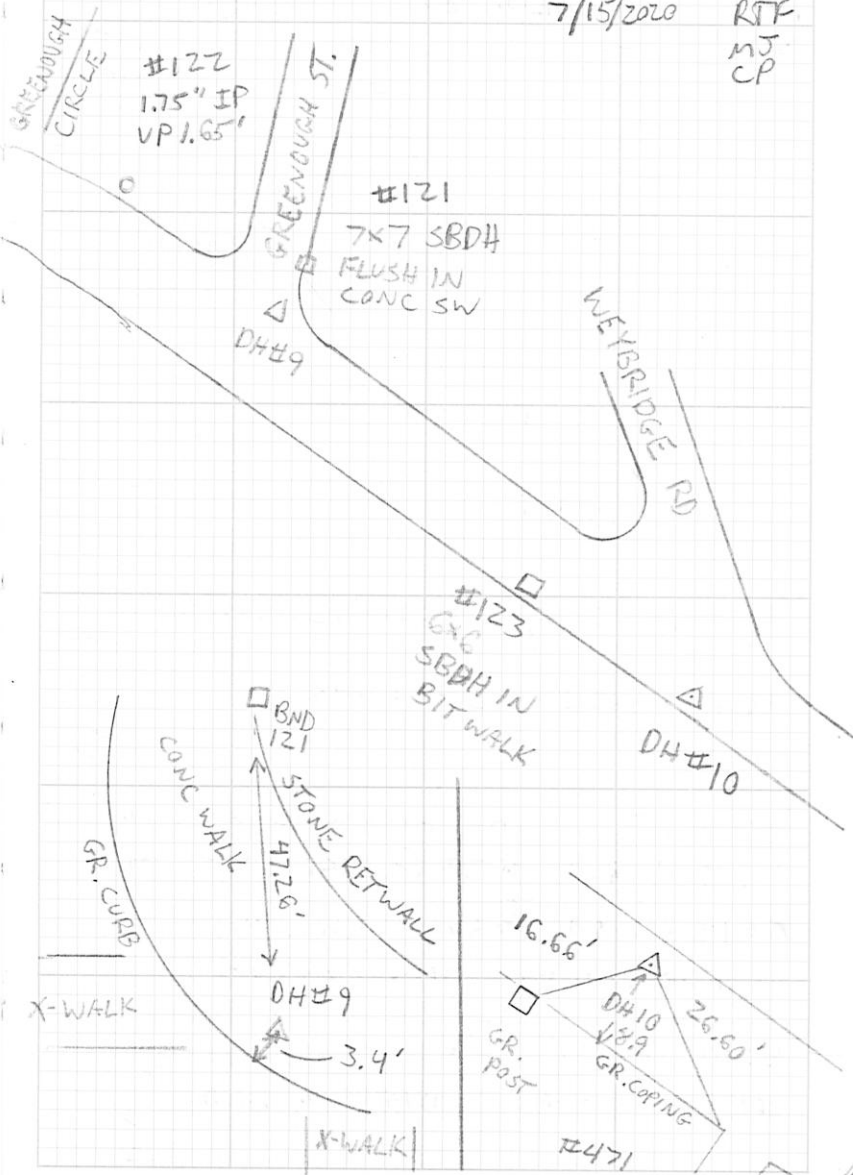

671/44 BROOKLINE

Inst.	Tape	Wthr & Temp	Date	Crew
TS16 8167		CLEAR 80'S	7/16/2020	RTF MT CP

FILE: 1040-TRAV  
1080-SS

#496

13.30' CUR RET WALL  
LOC BBS 9.12'

DH10

PARK ST.

124

125

MN12

131

GRACES RD

TE11 HI=5.36/BS10@5.8/FS12@5.42  
HZ# 202.02.21 DIST. 207.256

TE11/BS12/FS 10A  
HZ# 157.57.39 DIST 333.016

TE12 HI=5.42/BS11@5.36/FS13@5.19  
HZ# 144.52.13 DIST. 386.092

TE12/BS13/FS 11A  
HZ# 215.07.48 DIST 207.254

#130 BM 356 - CH. SQ. / BRADLEY HEAD  
#132 & 133 - FRONT CORNERS OF BND 131

WASHINGTON ST.

671/45

Inst.	Tape	Wthr & Temp	Date	Crew
-------	------	-------------	------	------

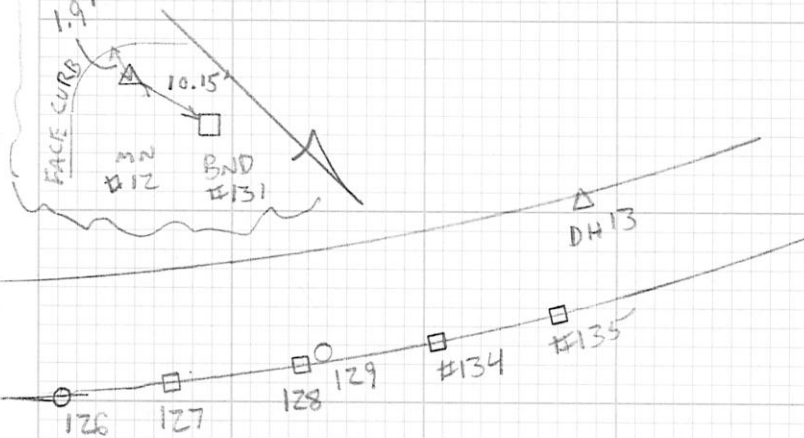

TE12/BS13

SIDESHOTS

FS 124-5.10 7x7 SBDH

HZ# 200.29.41 DIST 81.393

FS 125-0.34

HZ# 177.01.52 DIST 48.394

FS 126-5.10 3/4" REB

HZ# 21.35.44 DIST 44.868

FS 127-5.10 7x7 SBDH

HZ# 16.22.20 DIST 99.047

FS 128-5.10 7x7 SBND CENTER

HZ# 14.55.13 DIST 135.367

FS 129-1.44 3/4" REBAR

HZ# 14.28.02 DIST 136.012

FS 131-1.44 7x7 SBND FRONT/CENTER

HZ# 41.20.28 DIST 10.158

671/46

## BROOKLINE

Inst.	Tape	Wthr & Temp	Date	Crew
TS16		CLEAR 80'S	7/16/2020	RTF MJ CP

8167

#30  
GARDNER

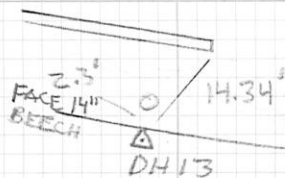

#135

#136

WASHINGTON

 $\pi e13 H1 = 5.19$  BS12 @ 5.42 / FS14 @ 5.23

 $HZ \& 179.31.24$  DIST 276.477

 $\pi e13 / BS14 / FS12A$ 
 $HZ \& 180.28.34$  DIST 386.094

SIDESHOTS

 $\pi e13 / BS14$ 

FS134 - 6.0 7x7 SBDH FLUSH

 $HZ \& 167.28.17$  DIST 194.798

FS135 - 5.10 7x7 SBDH UP 0.2'

 $HZ \& 125.57.34$  DIST 70.321

FS136 - 6.0 7x7 SBDH FLUSH

 $HZ \& 31.49.05$  DIST 105.381

#137 - 5.10 BM 355 CH. SQR THROAT STONE

## WASHINGTON ST,

671/47

Inst.	Tape	Wthr & Temp	Date	Crew
			7/16/2020	

GARDNER RD

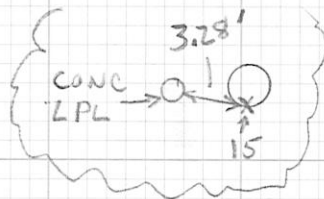
 PUNCH  
MARK  
EMH  
RIM

#138

ST

513

 MN14 (1' OFF BIK WALK)  
PAVER WALK TO #563

#139

 $\pi e14 H1 = 5.23$  / BS13 @ 5.19 / FS15 @ 5.42

 $HZ \& 132.51.09$  DIST 480.321

 $\pi e14 / BS15 / FS13A$ 
 $HZ \& 227.08.52$  DIST 276.477

 $\pi e14 / BS15$ 

SIDESHOTS

FS138 - 0.3 7x7 SBDH DOWN 0.2'

 $HZ \& 340.17.23$  DIST 113.440

FS139 - 5.10 7x7 SBDH FLUSH

 $HZ \& 5.51.44$  DIST 202.198



671/48

## BROOKLINE

Inst.	Tape	Wthr & Temp	Date	Crew
TSIG SIG7		CLOUDY 70'S	7/17/2020	RTE MS CP
FILE: 1080-TRAV 1080_SS				

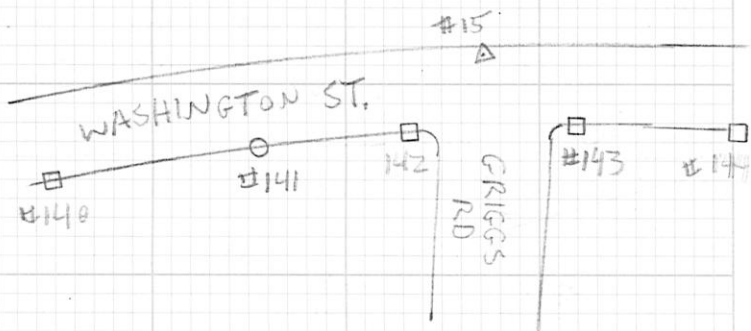

TC 15 HI = 5.25 / BS 14 @ 5.63 / FS 16 @ 5.28  
 HZ & 203.07.00 DIST. 250.403

TC 15 / BS 16 / FS 14 A  
 HZ & 156.53.01 DIST. 480.321

TC 15 / BS 16

FS 140 - 5.10 7x7 SBDH  
 HZ & 152.28.10 DIST 263.267

FS 141 - 5.10 CAPPED REBAR (ROBER)  
 HZ & 144.21.19 DIST 127.489

FS 142 - 5.10 7x7 SBDH  
 HZ & 116.54.05 DIST 65.201

FS 143 - 5.31 7x7 SBDH  
 HZ & 57.50.26 DIST. 59.378

FS 144 - 5.10 7x7 SBDH  
 HZ & 20.18.21 DIST 138.856

WASHINGTON ST.

671/49

Inst.	Tape	Wthr & Temp	Date	Crew
-------	------	-------------	------	------

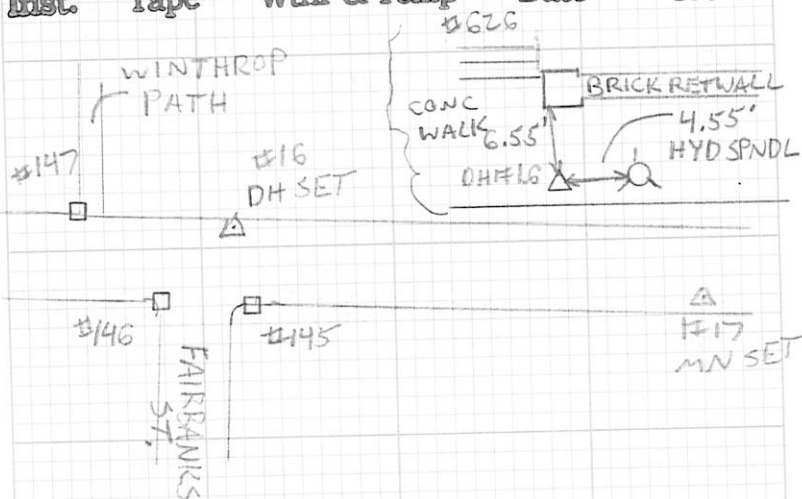

TC 16 HI = 5.28 / BS 15 @ 5.25 / FS 17 @ 5.17  
 HZ & 191.04.33 DIST. 316.591

TC 16 / BS 17 / FS 15 A  
 HZ & 168.55.27 DIST 250.403

TC 16 / BS 17

FS 145 - 5.10 7x7 SBDH  
 HZ & 66.09.29 DIST. 55.029

FS 146 - 5.10 7x7 SBDH  
 HZ & 115.31.07 DIST. 64.341

FS 147 - 0.1 7x7 SBDH  
 HZ & 178.55.29 DIST. 50.987

#148 - 5.10 BM 905 = BND #147

671/50

## BROOKLINE

Inst. Tape Wthr &amp; Temp Date Crew

TS 16  
8167 HHT 90'S 7/20/2020 RTF  
MS  
CPFILE: 1080 - TRAV  
1080 - SS  
#648

#666

DH 18

HYD

37.8'

HYD

#152

#151

FIRE  
STA.MN 17  
1.8' OFF BK CURB

#149/150

 $\pi$ e 17 HI = 5.23 BS 16 @ 5.22 / FS 18 @ 5.48

HZ# 160.45.20 DIST. 260.260

 $\pi$ e 17 / BS 18 / FS 16A

HZ# 199.14.40 DIST. 316.594

 $\pi$ e 17 / BS 18 SIDESHOTS

#149 - 5.40 6x7 SBND CLBK

HZ# 177.46.32 DIST. 40.008

#150 - 5.10 SBND CENTER

HZ# 178.03.09 DIST. 39.940

671/51

## WASHINGTON ST

Inst. Tape Wthr &amp; Temp Date Crew

#672

#682

BEACON ST.

GREEN LINE MBTA

INCR. CURB  
D-STONE  
DH 19#153  
6x7 SBNDH

DH 20

 $\pi$ e 18 HI = 5.48 BS 17 @ 5.23 / FS 19 @ 5.73

HZ# 195.23.35 DIST. 146.107

 $\pi$ e 18 / BS 19 / FS 17A

HZ# 164.36.23 DIST. 260.258

 $\pi$ e 18 / BS 19 SIDESHOTS

FS 151 - 5.40 BROOKLINE F.D. DISK

HZ# 113.11.14 DIST. 58.091

FS 152 - 5.40 3/4" I. ROD

HZ# 145.31.27 DIST. 109.319

 $\pi$ e 19 HI = 5.73 / BS 18 @ 5.48 / FS 20 @ 5.45

HZ# 194.02.46 DIST. 408.152

 $\pi$ e 19 / BS 20 / FS 18A

HZ# 165.57.15 DIST. 146.106

 $\pi$ e 19 / BS 18

FS 153 - 7.0 HZ# 193.52.19 DIST. 289.496

671/52 BROOKLINE

Inst.	Tape	Wthr & Temp	Date	Crew
TSIC		HHH	7/20/2020	RJF MJS CP
8167				

Te 20 HI = 5.45 BS19 @ 5.73 FS21 @ 5.62  
 HZ & 212.05.39 DIST. 200.239

Te 20 / BS21 / FS19A  
 HZ & 147.54.21 DIST. 408.151

Te 20 / BS21  
 FS 154 - 8.0 7x7 CBDH  
 HZ & 325.28.28 DIST. 156.089

FS 155 - 5.10 - 7x7 SBDH  
 HZ & 11.59.08 DIST. 142.011

FS 156 - 5.10 7x7 SBDH  
 HZ & 33.17.38 DIST. 129.419

#157 - BM

FS 22 5.07 DH SET  
 HZ & 106.24.48 DIST. 507.443

Te 20 / BS22 / FS19B  
 HZ & 41.29.34 DIST. 408.151

WASHINGTON ST. 671/53

Inst.	Tape	Wthr & Temp	Date	Crew
-------	------	-------------	------	------

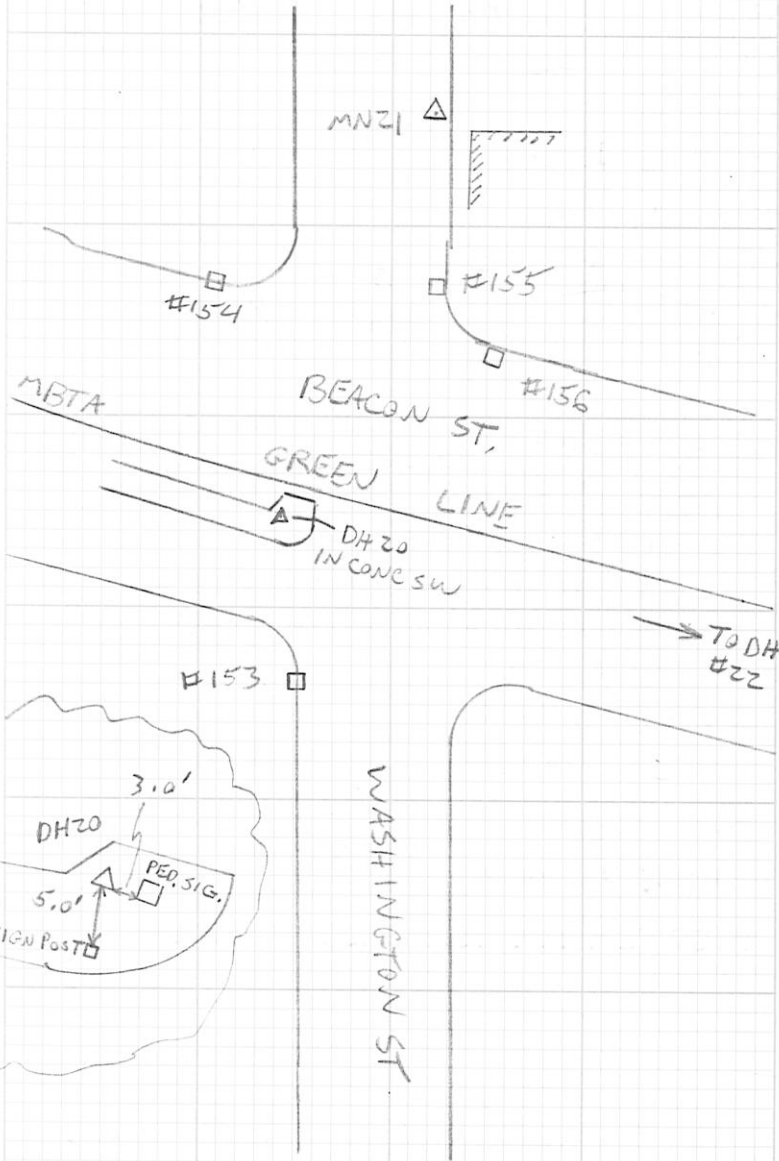



671/54

## BROOKLINE

Inst.	Tape	Wthr & Temp	Date	Crew
T316 8167		CLEAR 80'S	7/21/2020	RTF MJ CP
FILE: 1080-TRAV 1080-SS				

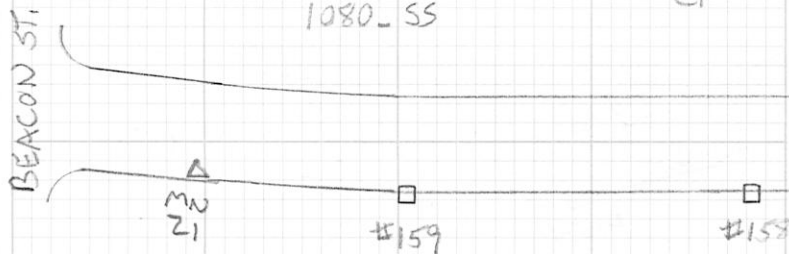

$\pi e z 1$  HI = 5.35 / BS Z0 @ 5.63 / FS Z3 @ 5.42  
 HZ & 157.30.30 DIST. 400.098  
 $\pi e z 1$  / BS Z3 / FS Z0 A  
 HZ & 202.29.29 DIST. 200.234

$\pi e z 1$  / BS Z3 SIDESHOTS  
 FS 158 - 5.40 6x6  
 HZ & 7.47.00 DIST. 297.765

FS 159 - 5.40 6x7  
 HZ & 10.08.14 DIST. 93.060

#160 - Bm 164 ROC / BCS #724 WASH. ST.  
5.40

671/55

## WASHINGTON ST

Inst.	Tape	Wthr & Temp	Date	Crew
			7/21/2020	

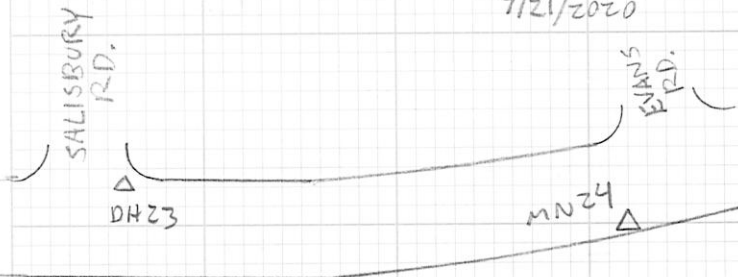

$\pi e z 3$  HI = 5.42 / BS Z1 @ 5.35 / FS Z4 @ 5.46  
 HZ & 192.30.52 DIST. 395.295, 594

$\pi e z 3$  / BS Z4 / FS Z1 A  
 HZ & 167.29.09 DIST. 400.099

$\pi e z 3$  / BS Z4 SIDESHOTS  
 #161 - 5.10 Bm 172 ROC BOT SLATE STEP #736 WASH,  
 #162 - 5.10 Bm 171 ROC / BCS #750 WASH.

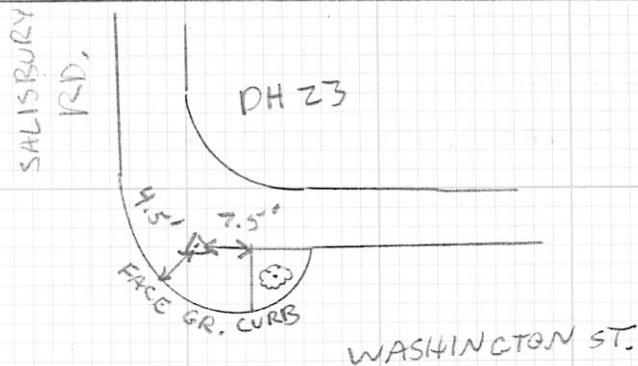

671/56

## BROOKLINE

Inst.	Tape	Wthr & Temp	Date	Crew
			7/21/2020	RTF MJ CP

EVANS  
RD.MN24  
△

#163

BARTLETT  
ST.

$\pi$ e 24 H 15.46 / BS 23 @ 5.42 / FS 25 @ 5.53  
 HZ & 151.08.30 DIST. 358.003

$\pi$ e 24 / BS 25 / FS 23A  
 HZ & 208.51.30 DIST. 295.591

$\pi$ e 24 / BS 25 SIDESHOTS  
 FS 163 - 5.10 7x7 SBDH  
 HZ & 1028.13.23 DIST. 83.788

#164 - 5.10 BM 163 ROC/BCS #782 WASH.  
 (THIS BM IS QUESTIONABLE)

MN24 / 1.4" FROM FACE / CURB

BIT WALK 7.9' → 13.4' → SMH

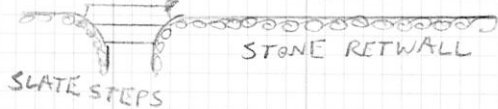

HSE #765

671/57

## WASHINGTON ST.

Inst.	Tape	Wthr & Temp	Date	Crew
			7/21/2020	

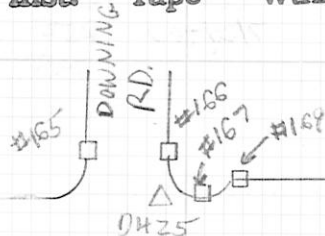

$\pi$ e 25 H 1 = 5.53 / BS 24 @ 5.46 / FS 26 @ 5.80  
 HZ & 201.38.08 DIST. 400.702

$\pi$ e 25 / BS 26 / FS 24A  
 HZ & 158.21.52 DIST. 358.003

$\pi$ e 25 / BS 26 SIDESHOTS

FS 165 - 5.40 6x6 SBDH  
 HZ & 195.37.20 DIST. 44.965

FS 166 - 5.40 6x6 SBDH  
 HZ & 258.39.43 DIST. 28.181

FS 167 - 5.40 6x6 SBDH  
 HZ & 341.39.33 DIST. 24.195

FS 168 - 5.40 6x6 SBDH  
 HZ & 52.29.15 DIST. 60.923

FS 169 - 5.40 6x6 SBND CLBK  
 HZ & 338.15.19 DIST. 30.335

#170 - 5.40 CENTER OF BND #169

671/58

## BROOKLINE

Inst.	Tape	Wthr & Temp	Date	Crew
TS16		HHH 80'S	7/23/2020	RTF
8167		FILE: 1080-TRAV		MT
		1080-SS		

π@26 H1=5.98 BS 25@5.70/FS 27@5.33

HZ & 29.35.17 DIST. 81.157

π@26/BS 27/FS 25A

HZ & 330.24.43 DIST. 400.703

π@26/BS 25 SIDESHOT3

FS 171-5.10 6x6 SBND CENTER (BOS/BROOK)

HZ & 308.09.30 DIST. 8.832

FS 172-8.0 6x6 SBDH

HZ & 184.03.31 DIST 126.796

π@27 H1 5.33/BS 26@5.98/FS 28@5.48

HZ & 60.13.11 DIST 166.828

π@27/BS 28/FS 26A

HZ & 299.46.49 DIST 81.158

π@27/BS 28

FS 173-6.5 6x6 SBDH

HZ & 333.19.33 DIST. 83.717

π@28 H1=5.48 BS 27@5.33

\*FS 174A-5.10 6x6 SBDH

HZ & 243.22.44 DIST 65.201

FS 175-5.10 6x6 SBDH

HZ & 270.03.37 DIST 142.265

FS 176-5.50 8x8 SBDH

HZ & 260.38.54 DIST. 412.686

671/59

## WASHINGTON ST.

Inst.	Tape	Wthr & Temp	Date	Crew
-------	------	-------------	------	------

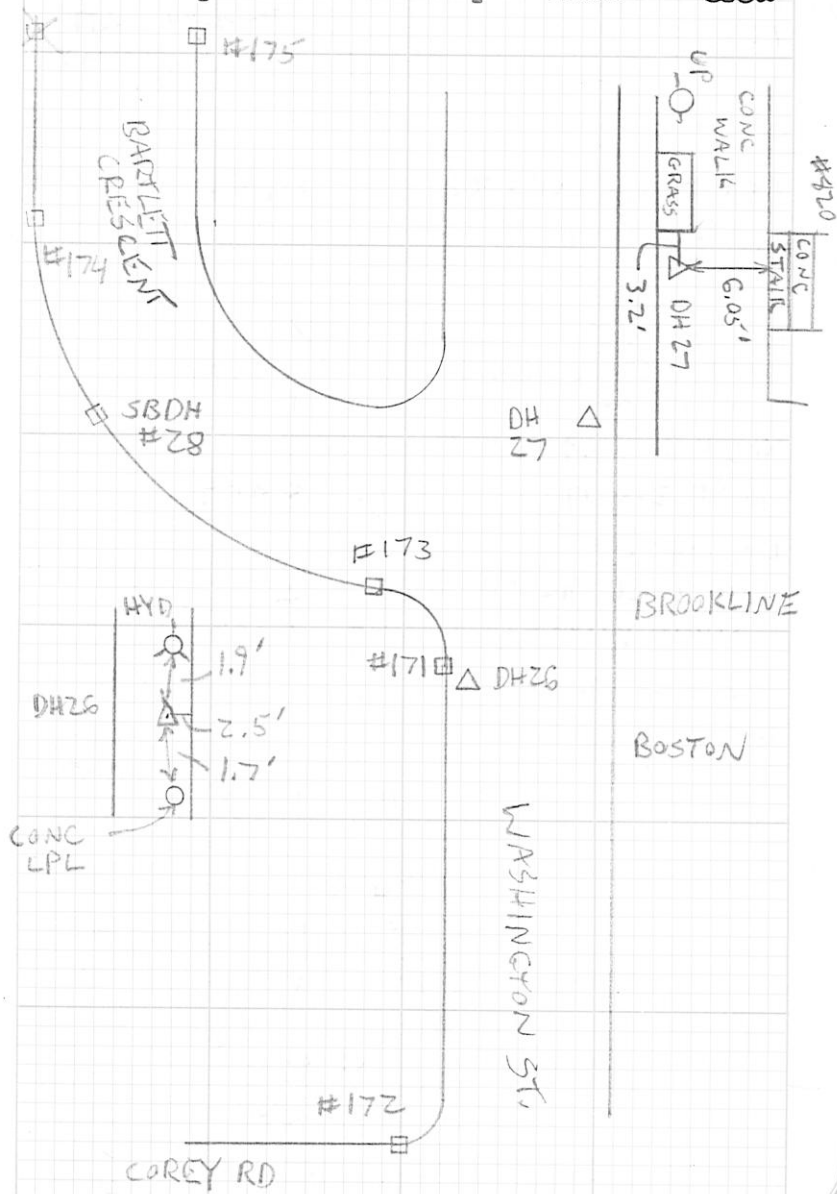

671/60

## BROOKLINE BARTLETT CRESCENT

Inst.	Tape	Wthr & Temp	Date	Crew
TS16/8167			7/23/2020	RTE MJ

T@28/BS27

FS 177-5.5 6x6 SBDH

HZ# 261.08.17

DIST. 353.341

FS 178-5.5

CAPPED REBAR O'BRIEN  
SURVEYING

HZ# 263.29.51

DIST. 295.198

FS 179-5.5

CAPPED REBAR O'BRIEN  
SURVEYING

HZ# 266.23.21

DIST. 231.281

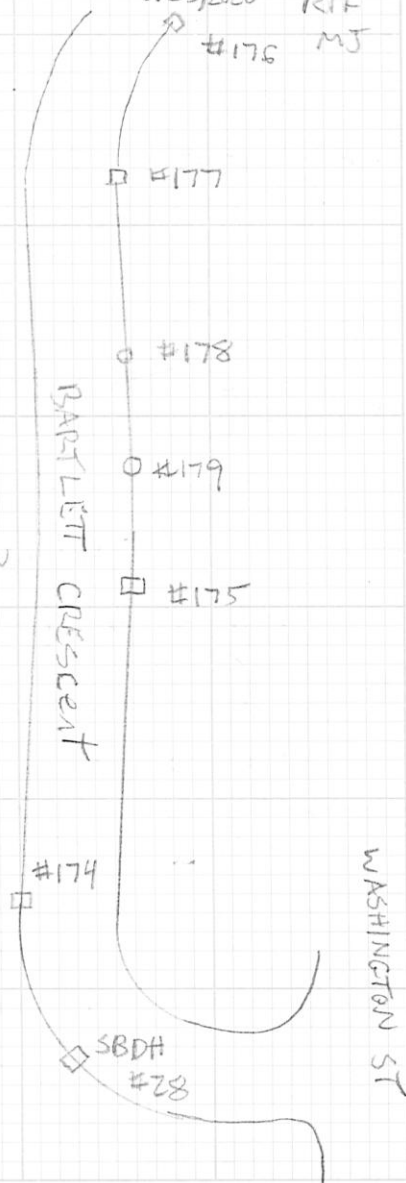

## BROOKLINE BEACON ST.

671/61

Inst.	Tape	Wthr & Temp	Date	Crew
TS16		P. CLOUDY 70'S	7/24/2020	RTE MJ CP
8167		FILE: 1080-TRAV		
		1080_55		

#1577 #1581

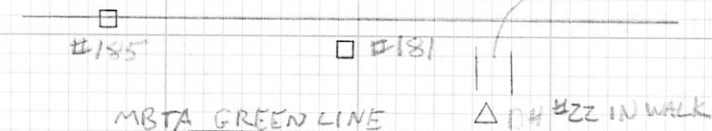

T@2241 5.31/BS20@5.65

FS 180-7.0 7x7 SBDH FLUSH

HZ# 96.19.10 DIST 123.915

FS 181-5.10 6x6 SBDH IN CONC WALK

HZ# 235.32.43 DIST 92.152

#182-7.0 BM 157 HIGH PT ON BN

#183-5.10 BM 372 Roc/BCS #11

FS 184-7.0 7x7 SBDH FLUSH

HZ# 103.16.36 DIST

FS 185-5.10 5x5 SBDH FL

HZ# 211.53.51 DIST

FS 186-5.10 7x7 SBDH

HZ# 101.43.04 DIST

WINTHROP ST

671/60

## BROOKLINE BARTLETT CRESCENT

Inst.	Tape	Wthr & Temp	Date	Crew
TS16	18167		7/23/2020	RTE MJ

T@28/35.27

FS 177-5.5 6x6 SBDH

HZ &amp; 261.08.17

DIST. 353.341

FS 178-5.5

CAPPED REBAR O'BRIEN  
SURVEYING

HZ &amp; 263.29.51

DIST. 295.198

FS 179-5.5

CAPPED REBAR O'BRIEN  
SURVEYING

HZ &amp; 266.23.21

DIST. 231.281

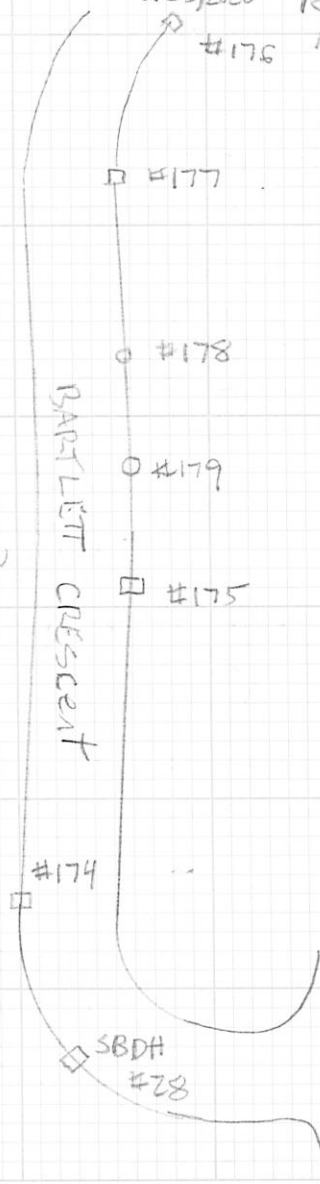

## BROOKLINE BEACON ST.

671/61

Inst.	Tape	Wthr & Temp	Date	Crew
TS16	8167	P. CLOUDY 70'S	7/24/2020	RTE MJ CP

FILE: 1080-TRAV  
1080\_SS

#1577 #1581

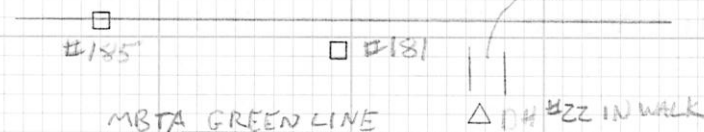

T@22415.31/BS2025.65

FS 180-7.0 7x7 SBDH FLUSH

HZ &amp; 96.19.10 DIST 123.915

FS 181-5.10 6x6 SBDH IN CONC WALK

HZ &amp; 235.32.43 DIST 92.152

#182-7.0 BM 157 HIGH PT ON BND 180

#183-5.10 BM 372 ROC/BCS #1589 BEACON

FS 184-7.0 7x7 SBDH FLUSH

HZ &amp; 103.16.36 DIST. 123.779

FS 185-5.10 5x5 SBDH FLUSH

HZ &amp; 211.53.51 DIST. 198.002

FS 186-5.10 7x7 SBDH

HZ &amp; 101.43.04 DIST 174.132

671/62

## BROOKLINE

Inst.	Tape	Wthr & Temp	Date	Crew
TS16	8167		7/24/2020	RJE MJ CP

$\pi e 20 HI = 5.65$  BS 19 @ 5.46 FS 29 @ 5.17  
 HZ & 136.32.19 DIST 260.166

(B)  
 $\pi e 20 / BS 29 / FS 21 @ 5.75$   
 HZ & 75.33.09 DIST. 200.238

$\pi e 29 HI = 5.17 / BS 20 @ 5.65$

FS 187-7.0 4x4 SBDH

HZ & 43.32.53 DIST 107.053

FS 188-5.10 6x6 SBDH

HZ & 196.17.45 DIST. 242.780

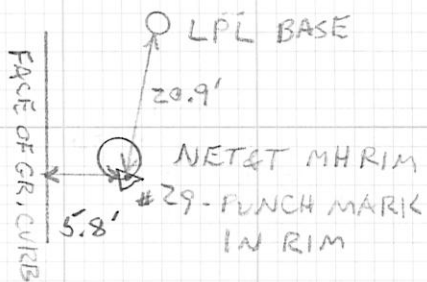

## BEACON ST.

671/63

Inst.	Tape	Wthr & Temp	Date	Crew
				DH19

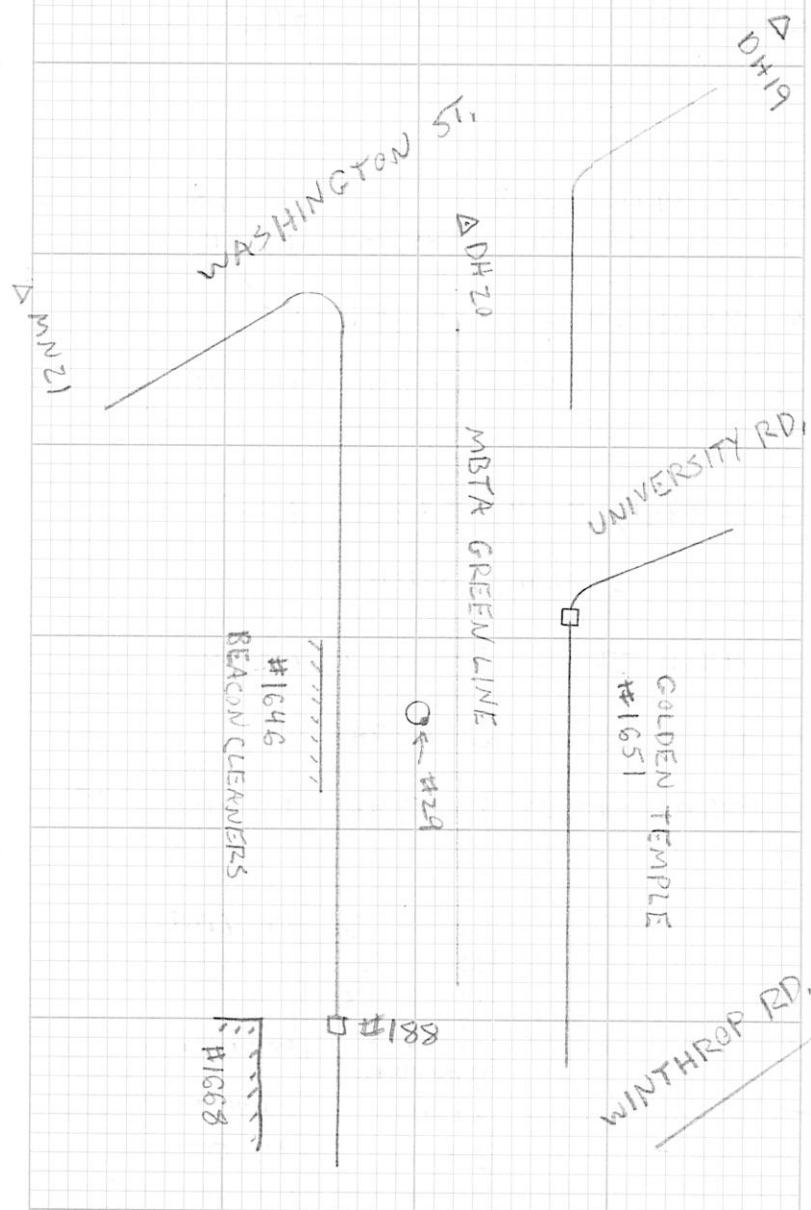



## 671/64 BROOKLINE

Inst. Tape Wthr & Temp Date Crew  
 LS15 LEVEL CLEAR 80'S 7/29/2020 RTE  
 1080 - BROOKLINE LINE 0001 M5  
 CP

DIST	BS	HI	FS	DIST	ELEV	ADJ. ELEV
22	5.7154	112.6344			106.919	
55	6.3832	114.1991	4.8185	39	107.8158	
67	6.3722	117.0257	3.4956	37	110.7035	
66	7.5302	121.9120	2.6459	61	114.3818	
92	9.0885	126.8902	4.1103	59	117.8016	
47	6.0388	130.2479	2.6810	81	124.2091	
53	2.7821	130.1715	2.8585	53	127.3894	
73	6.4934	134.0646	2.6003	45	127.5712	
162	6.7681	136.9734	3.8593	71	130.2054	
59	4.7679	137.3465	4.3948	171	132.5786	
81	4.0865	137.2810	4.1431	81	133.2035	
75	4.5061	137.7510	4.0450	74	133.2449	
171	4.4313	137.0127	5.1625	57	132.5815	
67	4.0445	134.2514	6.8058	162	130.2069	
46	2.5785	130.1504	6.6785	78	127.5719	
78	2.9443	127.0031	6.0916	57	124.0588	
66	3.9003	121.7027	9.2007	95	117.8024	
70	3.1088	117.5212	7.2904	63	114.4123	
50	3.1732	113.8708	6.8236	57	110.6976	
4160	4.7535	112.5657	6.0586	43	107.4122	
111	3.0199	109.9365	5.0491	21	106.9165	
88	4.5802	109.1073	5.4093	93	104.5272	
102	2.9701	106.0782	5.9992	82	103.1081	
100	2.5419	99.5761	9.0440	107	97.0342	
53	6.5039	101.2109	4.8390	118	94.7371	
38	6.4621	104.2205	3.4826	49	97.7584	
49	5.2621	106.2641	3.2189	44	101.0020	

## WASHINGTON ST.

671/65

Inst. Tape Wthr & Temp Date Crew  
 7/30/2020

PT#	DESC.
161	BROOKLINE BM 172 ROC BSS #736 WASH ST.
23	DH #23 (P.55)
162	BROOKLINE BM 171 ROC BCS #750 WASH ST.
1000	TURTLE
24	MN #24 (P.56)
1001	TURTLE
164	BRO BM ROC BCS #782 WASH ST.
1002	BM LOC BGS #782 WASH ST.
25	DH #25 (P.57)
27	DH #27 (P.59)
26	DH #26 (P.59)
171	BOSTON/BROOKLINE TL BND #171 (START * 7/30/2020)
27	DH #27
25	DH #25
1002	BM LOC BGS #782 WASH ST. *
1003	TURTLE
24	MN #24
1004	TURTLE
162	BROOKLINE BM 171
23	DH #23
161	BM 172
160	BROOKLINE BM 164 ROC BCS #724 WASH ST.
21	MN #21 (P.53)
1005	TURTLE
1006	TURTLE
1007	TURTLE
162	BROOKLINE BM 157 HI PT BND @ SUMMIT PATH

\*NOTE: NOT  
 BROOKLINE TOWN BMS

671/66

## BROOKLINE

Inst. Tape Wthr & Temp Date Crew  
 LS15 1080-BROOKLINE  
 LINE 0001

DIST.	BS	HI	FS	DIST.	ELEV	ADJ ELEV
49	5.2621	106.2841			101.0020	
36	2.5737	97.7056	11.1322	26	95.1319	
50	4.9939	96.4759	6.2239	25	91.4820	
126	2.3812	95.5179	3.3392	52	93.1367	
113	8.5416	101.1093	2.9502	157	92.5677	
<del>7812</del>	6.1637	105.5858	1.6872	95	99.4221	
86	8.8394	111.1934	3.2318	75	102.3540	
53	7.1915	116.4086	1.9764	83	109.2170	
52	2.7941	116.3528	2.8998	52	113.5587	
74	2.3410	111.1643	7.5295	60	108.8233	
79	2.5307	104.8857	8.5093	89	102.3550	
97	3.4546	100.3520	7.9883	108	96.8974	
97	4.3211	97.2902	7.3829	125	92.9691	
82	5.9637	97.3681	5.8858	75	91.4044	
140	1.5190	92.3481	6.5410	68	90.8270	
62	4.2575	87.7579	9.4457	125	82.9004	
93	3.9201	84.3769	7.3011	91	80.4569	
22	5.5853	82.5270	7.4352	94	76.9417	
88	4.1932	80.5410	6.1792	29	76.3478	
107	3.5182	76.3032	7.7559	112	72.7850	
137	3.0944	72.5230	6.8746	125	69.4286	
140	4.1277	69.7175	6.9353	134	65.5897	
57	5.8073	68.8206	6.7041	120	63.0133	
168	3.5762	66.7391	5.2577	50	63.1629	
59	5.1318	65.5719	6.2990	150	60.4401	
101	4.9662	64.1499	6.3882	77	59.1837	
			6.5011	113	57.6488	

## WASHINGTON ST.

671/67

Inst. Tape Wthr & Temp Date Crew  
 LS15 CLOUDY 80'S 8/4/2020  
 RTE  
 MJ  
 CP

PT#	DESC.
152	
1008	TURTLE
22	DH#22 (P.61)
183	BROOKLINE Bm 372 ROC BCS #1589 BEACON ST.
1009	TURTLE
1010	TURTLE
20	DH#20 (P.53)
1011	TURTLE
29	MTRV #29 PUNCH MARK MH RIM (P.63)
1012	TURTLE
20	DH#20 (START 8/4/2020)*
1013	TURTLE
19	DH#19 (P.51)
368	BROOKLINE Bm 368 LOC BGS #671 WASH ST.
18	DH#18 (P.50)
17	MN#17 (P.50)
1014	TURTLE
16	DH#16 (P.49)
148	BROOKLINE Bm 905 BND @ WINTHROP PATH
15	PUNCH MARK EM RIM #15 (P.47)
1015	TURTLE
14	MN#14 (P.47)
137	BROOKLINE Bm 355 CH. SQR THROAT STONE
13	DH#13 (P.46)
12	MN#12 #1016 TURTLE
12	MN#12 (P.44)
11	MN#11 (P.44)



671/68

## BROOKLINE

Inst. Tape Wthr & Temp Date Crew  
 LS15 Cloudy 80's 8/4/2020 RTF  
 MJ  
 CP  
 ADJ.  
 ELEV

1080-BROOKLINE LINE0001

DIST	BS	HI	FS	DIST	ELEV	ADJ. ELEV
166	4.2788	61.9277			57.5488	
196	2.9192	57.5328	7.3141	172	54.6135	
131	3.7699	54.3064	6.9962	195	50.5365	
129	3.6686	51.0967	6.8783	151	47.4280	
127	5.1739	51.7248	4.5457	133	46.5509	
158	6.0378	54.0082	3.7545	124	47.9704	
124	2.7974	54.2907	2.5149	171	51.4934	
57	2.5049	50.1922	6.9035	131	47.3872	
49	7.4199	50.0842	2.5280	49	42.6642	
79	6.1481	53.5410	2.6912	57	47.3929	
81	1.6186	52.6228	2.5368	85	51.0042	
75	4.5131	50.8256	6.3103	105	46.3125	
80	4.3874	48.4757	6.7373	61	44.0883	
67	2.7841	44.1562	7.1036	100	41.3721	
22	4.7426	42.1042	6.7946	<del>3863</del>	37.3616	
73	4.1115	41.4669	4.7488	24	37.3534	
62	5.0908	42.6134	3.9443	78	37.5226	
90	3.1503	42.0590	3.7047	70	38.9087	
69	5.2883	41.6110	5.7363	71	36.3227	
84	8.0027	45.8821	3.7317	82	37.8794	
31	6.2072	49.1177	2.9716	72	42.9105	
71	6.9531	51.0426	5.0281	35	44.0896	
92	6.0926	52.6161	4.5192	82	46.5235	
175	5.6544	56.6574	1.6131	82	51.0030	
157	1.9285	53.4273	5.1587	173	51.4987	
127	3.9204	51.8893	5.4582	171	47.9690	
			5.3430	125	46.5463	

## WASHINGTON ST

671/69

Inst. Tape Wthr & Temp Date Crew  
 CLOUDY 80's 8/7/2020 RTF  
 MJ  
 CP

PT#	DESC.
11	MN#11
10	DH#10 (P.43)
9	DH#9 (P.43)
8	SBDH#8 (P.42)
7	DH#7 (P.39)
3	SBND-IP-XCUT #3 (P.39)
2	SN#2 (P.31)
101	SBDH#101 (P.31)
268	BROOKLINE BM 268 LOC BGS #6 THAYER ST.
101	SBDH#101
1	SN#1 (START 8/7/2020)*
1017	TURTLE
4	DH#4 (P.35)
5	MN#5 (P.37)
1018	TURTLE
112	BROOKLINE BM 884 ROC BBS #235 WASH ST
1019	TURTLE
6	MN#6 (P.37)
1020	TURTLE
1021	TURTLE
1022	TURTLE
4	DH#4 (P.35)
1023	TURTLE
1	SN#1 (P.33)
2	SN#2 (P.31)
3	SBND-IP-XCUT #3 (P.39)
7	DH#7 (P.39)

## 671/70 BROOKLINE

Inst. Tape Wthr & Temp Date Crew  
 LS15 P.CLOUDY 70's 8/17/2020 RTF  
 MS  
 CP

1080-BROOKLINE /LINE 0001

DIST	BS	HI	FS	DIST	ELEV	ADJ ELEV.
138	4.7985	51.3448			46.5463	
139	6.9983	54.4212	3.9218	123	47.4230	
196	6.8730	57.4020	3.8923	142	50.5289	
172	6.4186	61.0258	2.7948	195	54.6072	
173	6.2046	63.9062	3.3842	166	57.6415	
134	5.6545	66.3146	3.2461	165	60.6601	
126	5.4558	68.6110	3.1595	121	63.1552	
131	5.9609	71.5467	3.0251	151	65.5858	
100	6.7726	76.0044	2.3150	142	69.2318	
120	6.9780	79.7586	3.2237	130	72.7806	
157	7.9003	84.8980	2.8210	132	76.9376	
128	9.6805	92.5681	2.0104	163	82.8876	
73	6.3398	97.1566	1.7513	138	90.8168	
53	6.1589	99.1171	4.1984	73	92.9582	
60	5.6420	100.9845	3.7746	64	95.3425	
60	5.8586	103.3882	3.4550	72	97.5295	
127	6.7551	105.6210	4.5322	86	98.8559	
83	5.9901	109.0827	2.5264	101	103.0926	
117	5.6659	110.1914	4.5572	87	104.5255	
			3.2785	99	106.9130	
CLEAR 80'S				8/19/2020		
FILE: 1080-8-19						
63	4.7794	77.5644			72.7850	
86	6.6357	77.0998	7.1003	81	70.4641	
			4.3183	61	72.7815	

## WASHINGTON ST.

671/71

Inst. Tape Wthr & Temp Date Crew

PTH	DESC.
7	DH#7
8	SBDH#8 (P.42) *START 8/17/2020
9	DH#9 (P.43)
10	DH#10 (P.43)
11	MN#11 (P.44)
130	BROOKLINE BM #356 CH. SQR/BRADLEY HEAD
13	DH#13 (P.46)
14	MN#14 (P.47)
1024	TURTLE
15	PUNCH MARK EMH RIM#15 (P.47)
16	DH#16 (P.49)
17	MN#17 (P.50)
18	DH#18 (P.50)
19	DH#19 (P.51)
1025	TURTLE
1026	TURTLE
1027	TURTLE
21	MN#21 (P.53)
160	BROOKLINE BM 164 ROC BCS #724 WASH. ST
161	BROOKLINE BM 172 ROC BSS #736 WASH. ST
15	PUNCH MARK EMH RIM#15 (P.47)
190	BROOKLINE BM 354 CH SQR THROAT STONE (P.73)
15	

671/72 BROOKLINE

Inst.	Tape	Wthr & Temp	Date	Crew
TSIC 8167		CLEAR 80's	8/19/2020	RTE CP

FILE: 1080-8-19-2020

TC MN11 HI 5.77 (P.44)

BS MN12 @ 5.23 (P.45)

FS 189 7x7 SBDH FLUSH ROD=9.00

HZ 99.29.45 DIST. 56.133

GRIGGS  
RD.

#497

SBDH 189

MN12

WASHINGTON ST

MN11

WASHINGTON ST

671/73

Inst.	Tape	Wthr & Temp	Date	Crew
			8/19/2020	

TC 15 HI=5.67

BS 16 @ 5.97

FS 190 @ 6.00

BROOKLINE BM 354

CH SQR THROAT STONE #599 WASH. ST.

FS 191 MFLY MN #14

GRIGGS  
RD

#599

#190-CH SQR

WASHINGTON ST.



#15  
PUNCH MARK  
EMH RIM

671/74 BROOKLINE

Inst.	Tape	Wthr & Temp	Date	Crew
TS16		CLEAR 70'S	8/26/2020	RJK
8167	FILE: 1080-8167			CP

TC1 HI 5.01 / BS2/5.10 PTS 2000-2170

MFLY BND #101 @ 6.0 - PT# 2000

#2170 MFLY Z



WASHINGTON ST.

671/75

Inst.	Tape	Wthr & Temp	Date	Crew

1080-8167 8/28/2020

TC@STK1 -> ON DH.4 START PRT  
 5.12 6.0 2171 - 2496  
 MFLY 2490 - BND 101

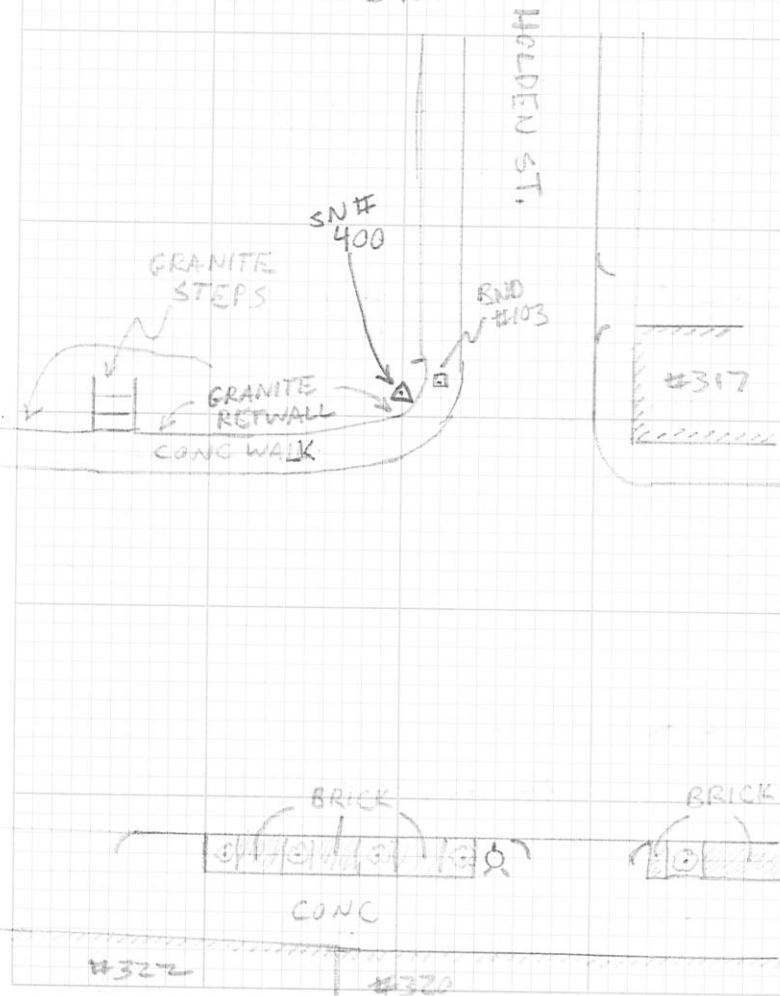

671/76 BROOKLINE

Inst.	Tape	Wthr & Temp	Date	Crew
TS16		P.CLOUDY 70'S	8/29/2020	RTE MJ CP
2997	FILE:1080-2997 DETAIL			

Te SN 2 HI 5.31 BS 3 @ 5.10  
 10000-10133 10133 MFLY 3  
 10000 MFLY SBDH #100

TS16	CLEAR 65°	8/31	
8167	FILE 1080-8167		MJ CP

STK 1 → DN 4  
 4.94 6.50

2497-2648

PARK SPACES @ METERS:  
 MFLY ON SBDH 101-2648

TS16	CLOUDY 70'S	9/2/2020	RTE
2997	FILE:1080-2997 DETAIL		MJ

Te 2 HI 5.44 BS 3 @ 5.10  
 10134-10234 10234 MFLY 3

WASHINGTON ST,

671/77

Inst.	Tape	Wthr & Temp	Date	Crew
TS16		CLEAR 70'S	9/4/2020	RTE MJ CP
2997	FILE:1080-2997 DETAIL			

Te 2 HI 5.51 BS 1 @ 4.29  
 FS SN/SET 500 @ 5.21 HZ 1.47-21  
 DIST 212.919'

Te 500 HI 5.21 BS 2 @ 5.51 \*10285'  
 NO SPLINE  
 10235-10371 \*10289.890  
 10371 MFLY 2 ENDSPLINE

TS16	CLEAR 70'S	9/4/2020	RTE
8167	FILE:1080-8167		MJ CP

Te 1 HI 4.29 BS 2 @ 5.51  
 FS 400 SN/SET @ 4.82 HZ 162.16.13  
 DIST. 86.184'  
 2649-2683

Te 400 HI 4.82 BS 1 @ 6.0  
 2684-2713 2713 MFLY 1

\*9/10/2020 SN 400 DISTURBED  
 RE-SHOT AS #401



671/78 BROOKLINE

Inst.	Tape	Wthr & Temp	Date	Crew
Z997		CLOUDY 70'S	9/10/2020	RTE
TS16	FILE:1080-2997		DETAIL	CP

ⓧ @ 500 H 15.18 BS Z @ 5.40

10372-10585

10585 MFLY Z

\*10578 RIGHT O/S (OK)

8167			9/10/2020	
TS16	FILE:1080-8167			

ⓧ @ 1 H 14.36 BS Z @ 5.40

FS 401 @ 5.15 HZ 16Z-18-25 D=86.1411

\*401 REPLACES SN 400 (DISTURBED)

ⓧ @ STK 1 → STK 401  
4.36 5.15

STK 2B. 5.40

A=197-41-36 D=347.9538

ⓧ @ STK 401 → STK 1  
5.15 4.36

D=86.1411

STANTS 2714 - 3262

WASHINGTON ST.

671/79

Inst.	Tape	Wthr & Temp	Date	Crew
Z997		P. CLOUDY 60'S	9/17/2020	RTE
TS16	FILE:1080-2997		DETAIL Z	CP MJ

ⓧ @ 2 H 15.46 BS 3 @ 5.10

10586-10895 10895 MFLY BND 3

8167			9/17/2020	
TS16	FILE:1080-8167			

ⓧ @ 1 H 15.44 BS 4 @ 6.0

3262-3384 3384 MFLY DH#4

ⓧ @ 500 H 15.43 BS Z @ 1.67

3385-3448 3448 MFLY SN Z



671/80

## BROOKLINE

Inst. Tape Wthr &amp; Temp Date Crew

LIBRARY

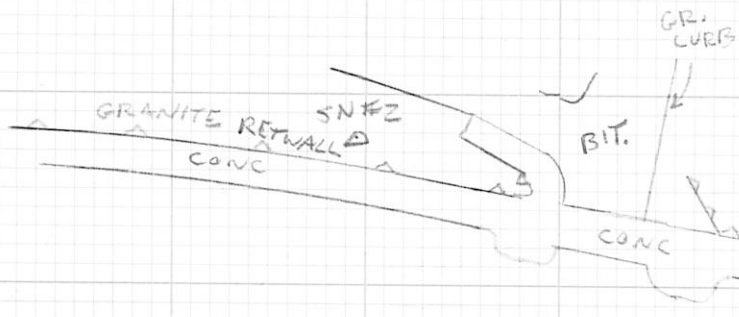

WASHINGTON ST

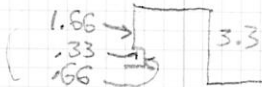
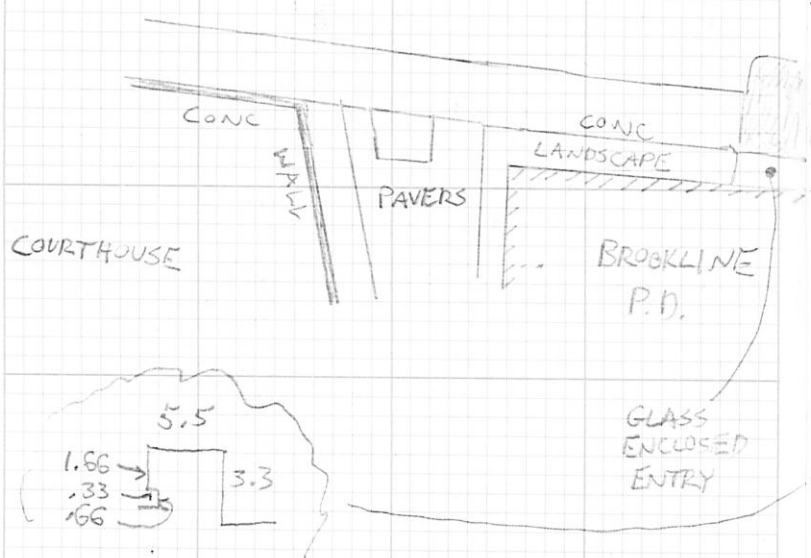

671/81

Inst. Tape Wthr &amp; Temp Date Crew

TOWN HALL

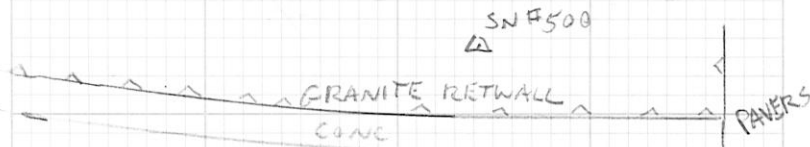

PAVERS

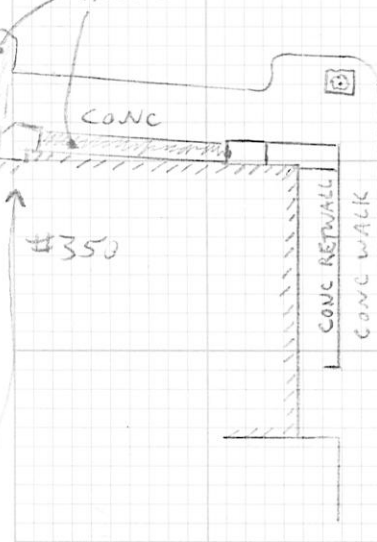

#350

THAYER ST.

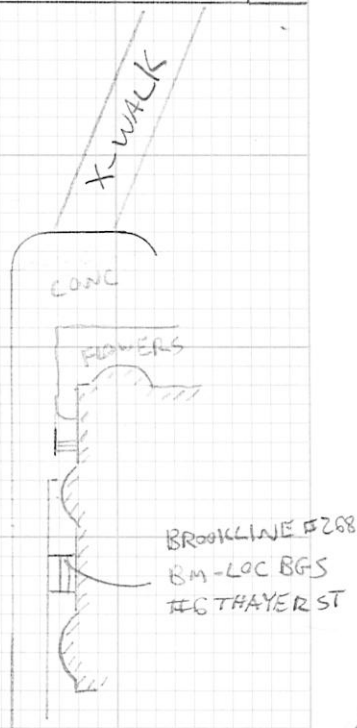
BROOKLINE #268  
BM-LOC BGS  
#EG THAYER ST

671/82

## BROOKLINE

Inst.	Tape	Wthr & Temp	Date	Crew
T31G		CLOUDY 60°	9/18/2020	RTE
2997				MJ

FILE: 1080-2997 DETAIL Z

π@ DH#4 HI 6.01 BS 5@ 6.5  
10896-11145 11145 MFLY MN5

\* DELETE PTS 2952 & 2953

Inst.	Tape	Wthr & Temp	Date	Crew
T31G		CLEAR 50'S	9/21/2020	RTE
2997				MJ

FILE: 1080-2997 DETAIL Z

π@ MN#5 HI=5.90 BS DH#4@6.5  
PTS 11146-11393 11393 MFLY 4

501 DH SET@5.47 HZ 127.38-20 D.153.13  
502 DH SET@5.42 HZ 280.51.25 D.125.85

Inst.	Tape	Date
T31G		9/21/2020
8167	1080-8167	

π@ 1 HI 4.49 BS 2@ 5.5  
3449-3531 3531 MFLY 4

π@ 501 HI 5.47 BS 4@ 1.68  
3532-3782 3782 MFLY 5

## WASHINGTON ST.

671/83

Inst.	Tape	Wthr & Temp	Date	Crew
T31G		CLOUDY 60°	9/22/2020	RTE
2997				MJ

1080-2997 DETAIL Z

π@ 5 HI 6.01 BS 4@ 6.5

11394-11796 11796 MFLY 4

1082-8167 CP

π@ 501 DHL → ON 5 MAG.  
(5.32) (4.25)

3783-3895

3894 DELETED.

MAG 5 MFLY 3895 (7.5) 360 PRISM

Inst.	Tape	Wthr & Temp	Date	Crew
T31G		CLEAR 70'S	9/23/2020	RTE
2997				CP

FILE: 1080-2997 DETAIL Z

π@ 5 HI=5.78 BS 4@ 6.5

11797-12145 12145 MFLY 4

\* DELETE 11847

NEED ENTRY TO #202 FROM PT 46

Inst.	Date
8167	9/23/2020

π@ 502 HI 5.38 BS 5@ 0.33 FS MAG 503@ 5.1

HZ 44.12-55. DIST 210.918

PTS 4005-4146 MFLY 503

π@ 501 HI 5.32 BS 5@ 5.78 FS 192 SBND

HZ 254.25-57 DIST 46.61 PTS 3896-4004

671/84

## BROOKLINE

Inst. Tape Wthr &amp; Temp Date Crew

HOLDEN ST.

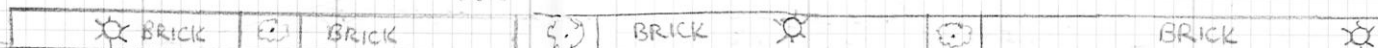
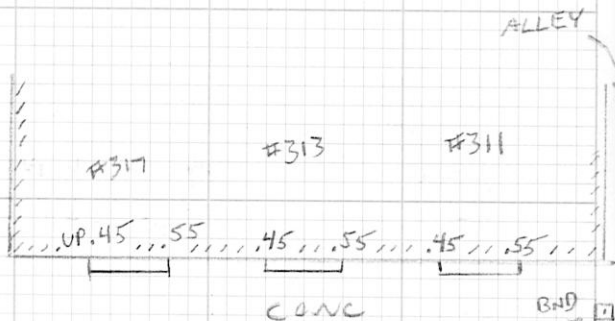

OUTDOOR DINING AREA

4' WOOD FENCE



CONC

ENTRY  
#312  
#314

ENTRY  
#306

ENTRY  
#300

ENTRY  
STAND  
PIPE  
#300

ENTRY  
#294

ENTRY  
#288

## WASHINGTON ST.

671/85

Inst. Tape Wthr &amp; Temp Date Crew

#305  
ENTRY

OH

OH

#295

ENTRY

671/86

## BROOKLINE

Inst.	Tape	Wthr & Temp	Date	Crew
TS16		CLEAR 80°	9/24/2020	RTE CP
2997	1080-2997 DETAIL Z			

$\pi$ @ 5 HI=5.32 BS 502@5.45  
 FS 504@5.43 DH/SET ON KENT ST. @ HARVARD  
 HZ & 207.18.44 DIST. 73.765

FS 505@5.50 MN/SET ON DAVIS CT. @ WASH.  
 HZ & 320.26.28 DIST. 172.473

$\pi$ @ 504 HI=5.43 BS 5@5.32

FS 193@5.50 6x6 SBDH UP 0.3'  
 HZ & 181.05.31 DIST.

STK DH 501@5.5 GOOD CHECK STORED @ 12146

PT 12147-12259 12259 MFLY 501

12260-12263 REFLECTORLESS SHOTS  
 OVHNG @ END OF MAST ARM

$\pi$ @ 505 HI=5.30 BS 5@5.32

PTS 12264-12421  
 12420 PK/FND 12421 MFLY 5

8167	1080-8167	9/24/2020
TS16		

$\pi$ @ 502 HI=5.45 BS 5@5.32  
 PTS 4147-4266 4266 MFLY 5

$\pi$ @ 503 HI=5.41 BS 502@5.5  
 PTS 4267-4418 4418 MFLY 502

## WASHINGTON ST

671/87

Inst.	Tape	Wthr & Temp	Date	Crew
TS16		CLEAR 80°	9/25/2020	RTE CP
2997	FILE: 1080-2997 DETAIL Z			

$\pi$ @ 6 HI=5.43 BS 5@5.54

FS 506@0.29 DH/SET  
 HZ & 269.12.09 DIST 44.422

FS 507@0.29 DH/SET  
 HZ & 354.24.54 DIST 33.617

FS 508@<sup>5.50</sup>~~5.08~~ DH/SET (IN BRICK)  
 HZ & 54.18.49 DIST 109.467

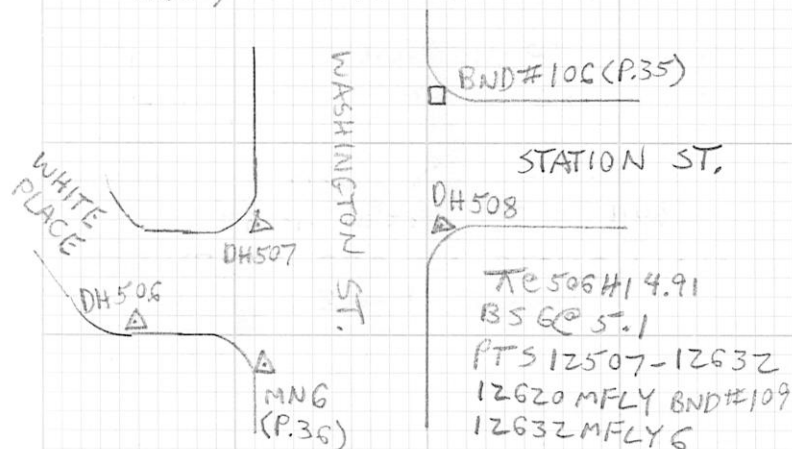

$\pi$ @ 507 HI 5.64 BS 6@5.10

STK 508@6.0 STORED@12422

$\pi$ @ 507 5.64 BS 508@6.0

STK 106@6.5 STORED@12423

PTS 12424-12506 12506 MFLY 6

671/88

WASHINGTON ST  
BROOKLINE

Inst.	Tape	Wthr & Temp	Date	Crew
TS 16	8167	CLEAR 69°	9/25/2020	CP RF MS
		1080-8167		

⊗ @ MDHL 502 → MMAG 5  
(5.175) (5.5)

SHOT #'S 4419 - 4449  
MFLY ON 503 (6.0) MMAG.  
(4449)

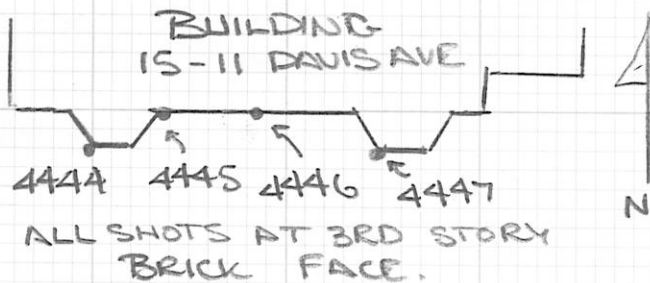

## BROOKLINE STATION ST 671/89

Inst.	Tape	Wthr & Temp	Date	Crew
TS 16	8167	P. CLOUDY 80°	9/29/2020	RTF CP
		FILE: 1080-8167		

⊗ @ DH 508 HI=5.43 BS 6 @ 6.0  
PTS 4450-4809 4809 MFLY 6

⊗ @ BND 110 HI=5.35 BS 106 @ 6.0  
PTS 4810-4856 4856 MFLY 106

TS 16	8167	P. CLOUDY 70's	9/29/2020	RTF CP
		FILE: 1080-8167		

⊗ @ DH 507 HI 5.62 BS 508 @ 7.0  
PTS 4857-4943  
4940 REFLECTORLESS  
END OF MAST ARM

671/90

## BROOKLINE

Inst.	Tape	Wthr & Temp	Date	Crew
			9/28/2020	RTF CP

WASHINGTON ST

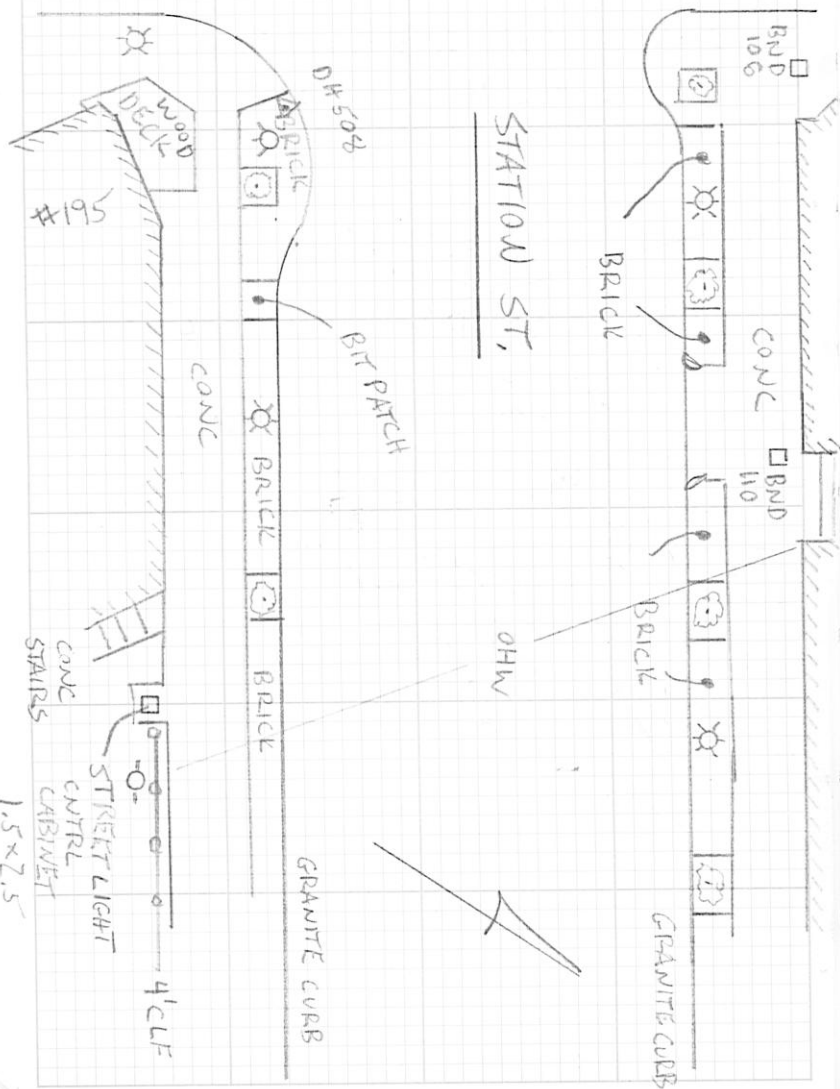

671/91

## BROOKLINE

Inst.	Tape	Wthr & Temp	Date	Crew
			9/28/2020	RTF CP

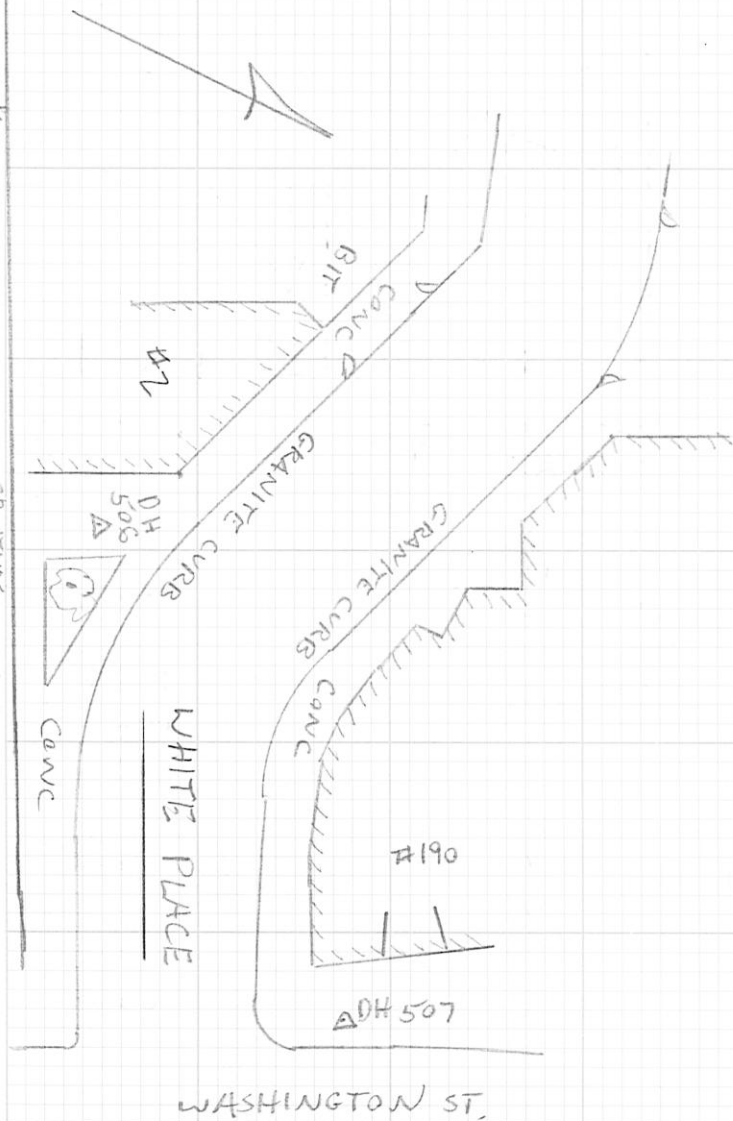



671/92

# BROOKLINE

WHITE PL.

Inst.	Tape	Wthr & Temp	Date	Crew
			9/28/2020	

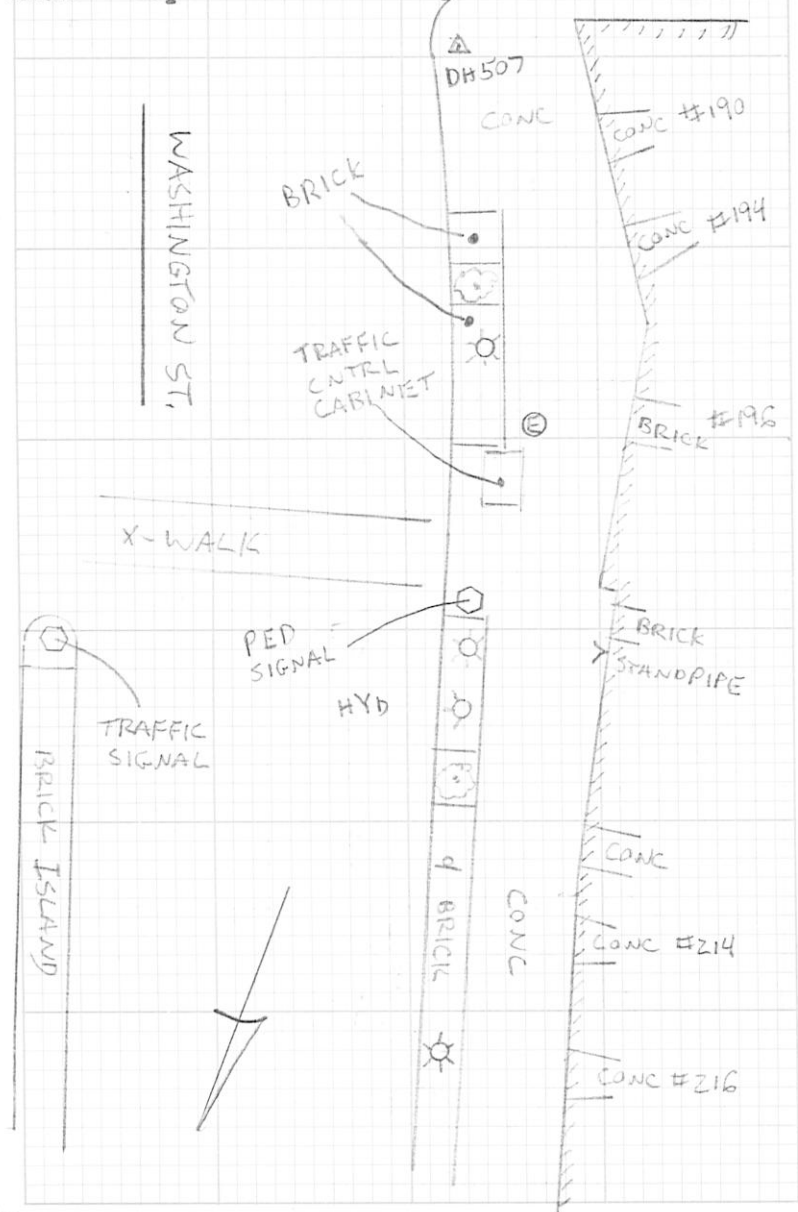

671/93

# BROOKLINE

Inst.	Tape	Wthr & Temp	Date	Crew
			9/28/2020	RJK CP

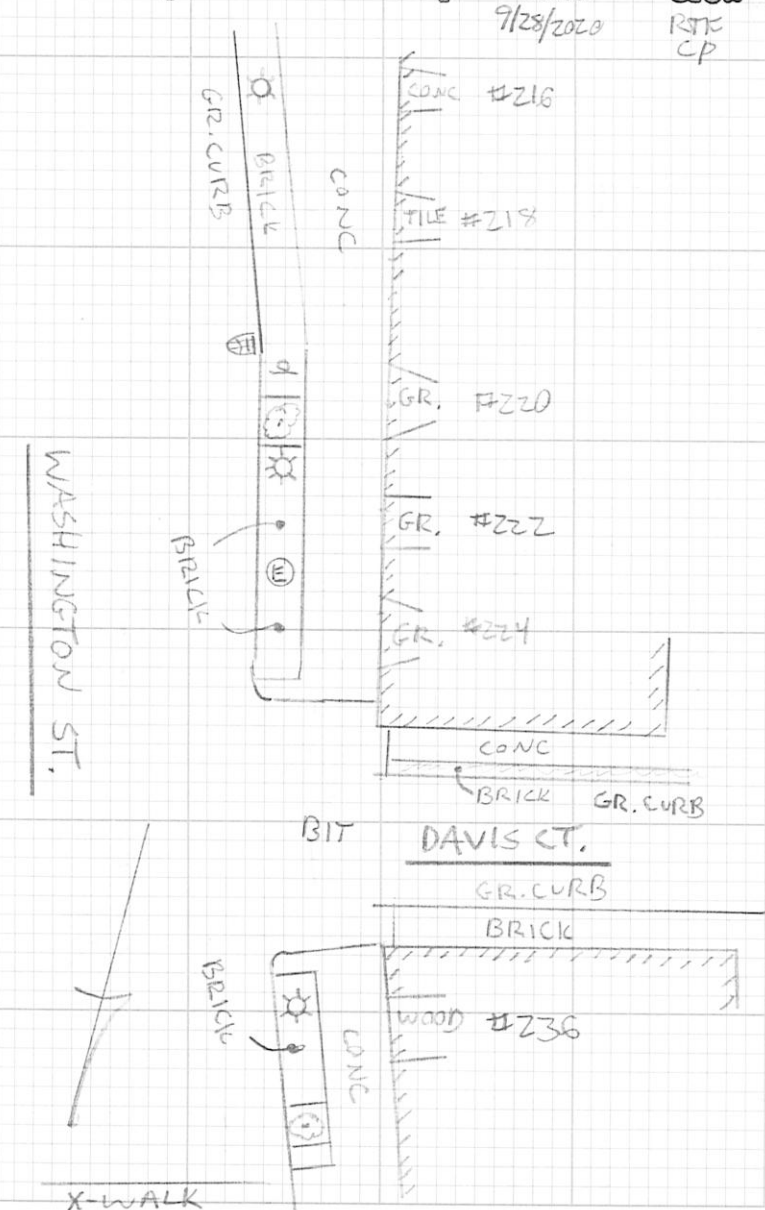

671/94

## BROOKLINE

9/28/2020

Inst. Tape Wthr &amp; Temp Date Crew

X-WALK

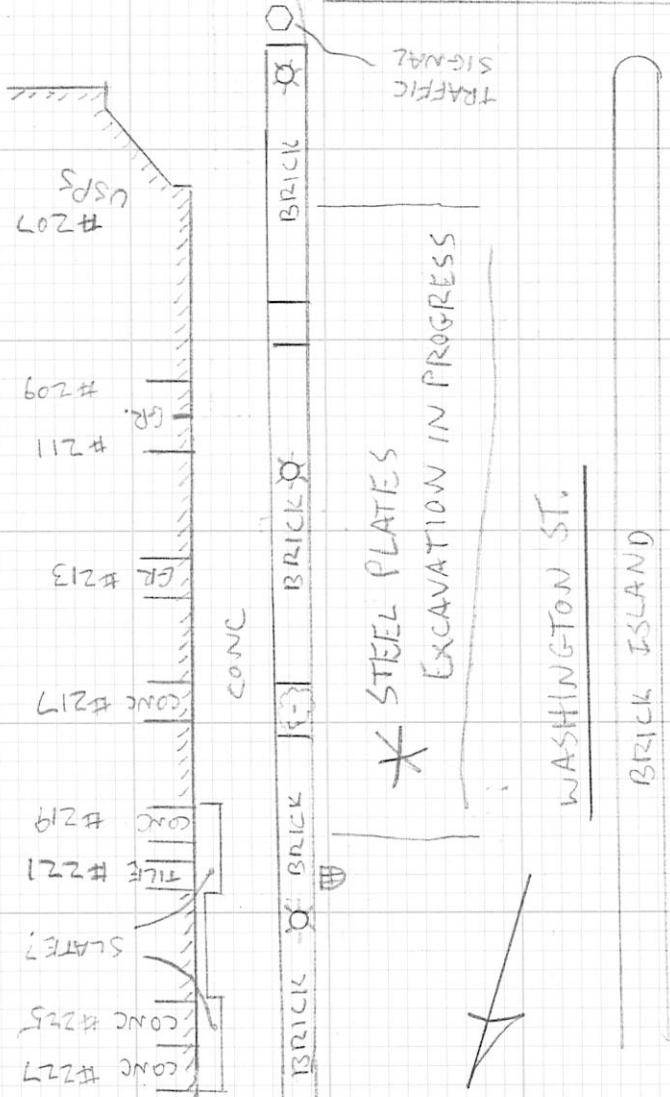

671/95

## BROOKLINE

Date Crew

9/29/2020

Inst. Tape Wthr &amp; Temp

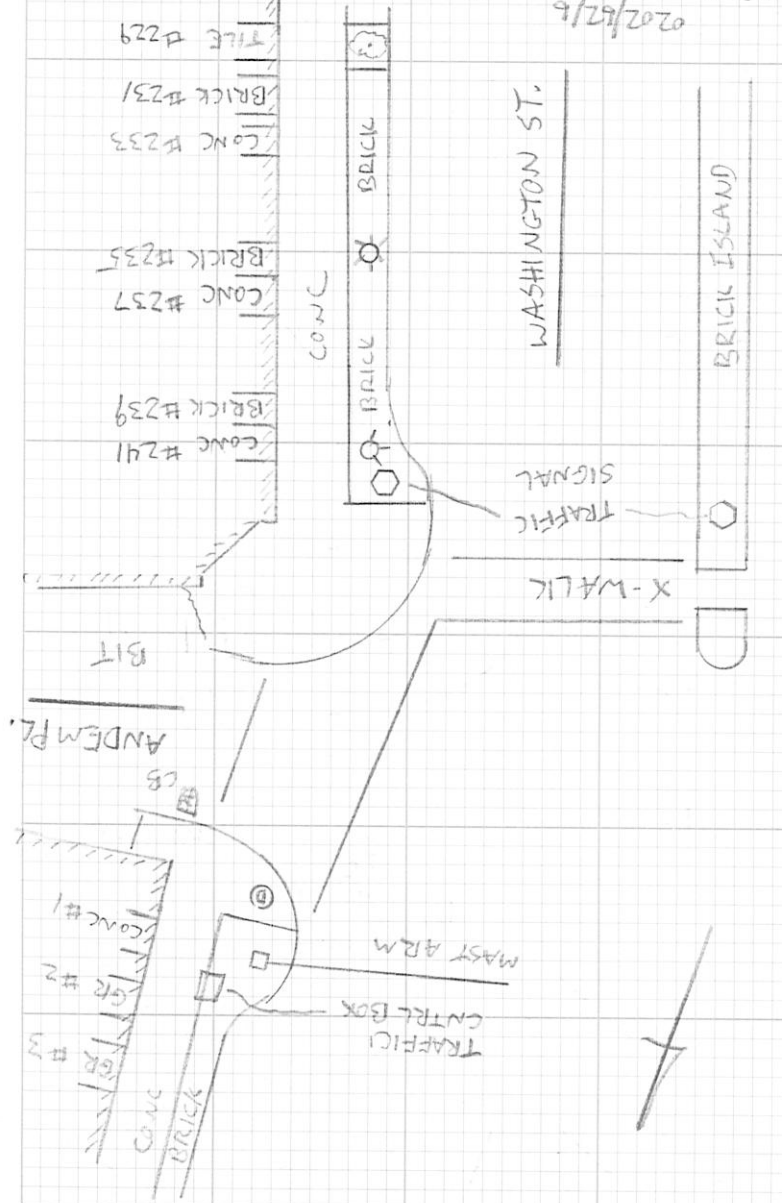

671/96

## BROOKLINE

Inst. Tape Wthr & Temp Date Crew  
 9/29/2020

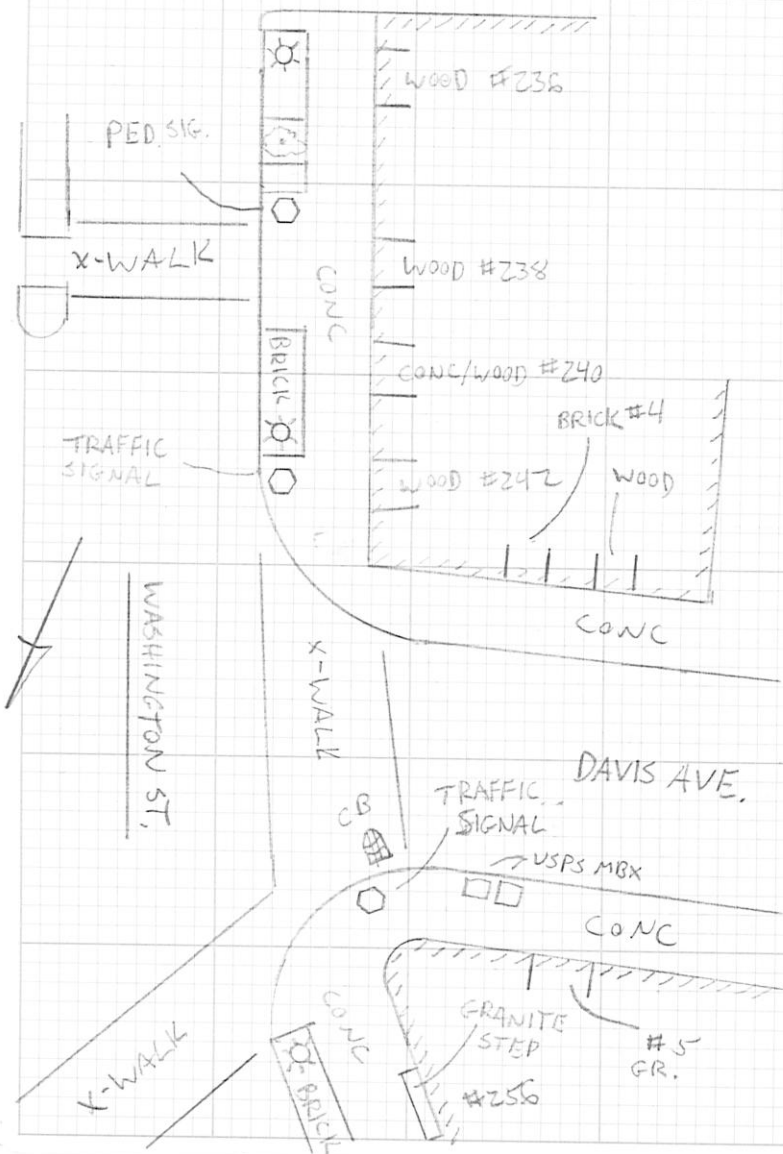

## BROOKLINE

671/97

Inst. Tape Wthr & Temp Date Crew  
 9/29/2020 RTF CP

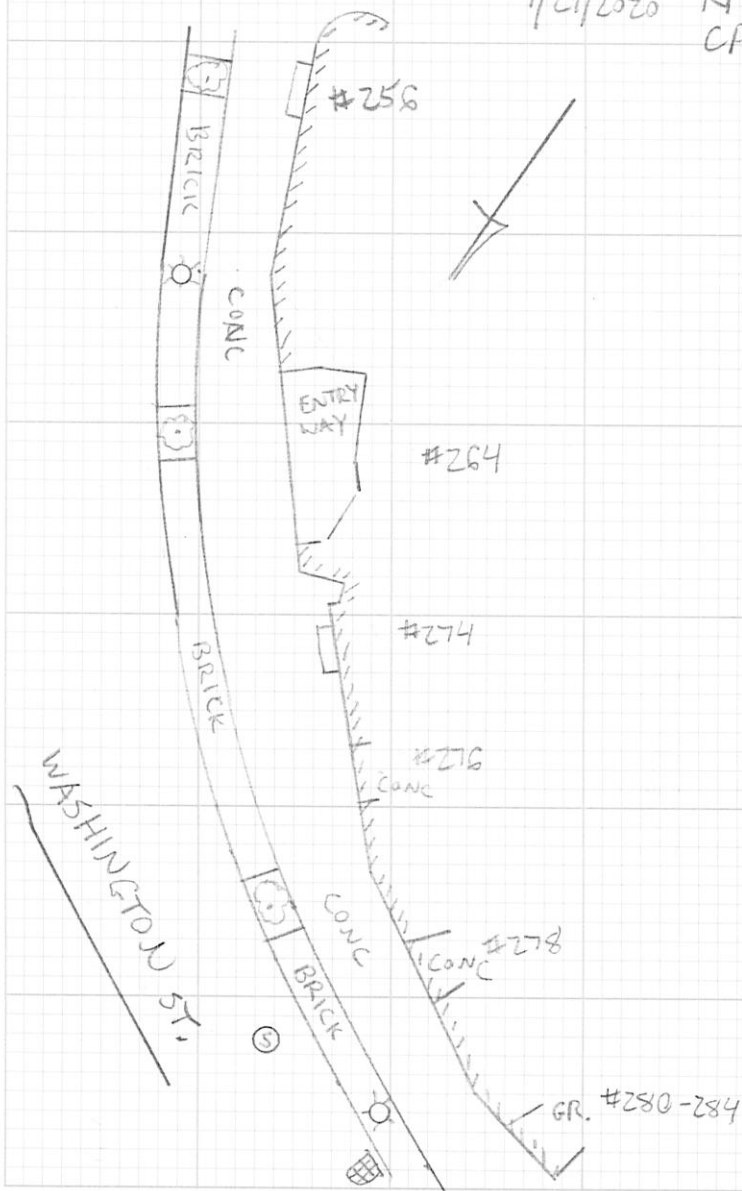

671/98

## BROOKLINE

Inst.	Tape	Wthr & Temp	Date	Crew



671/99

Inst.	Tape	Wthr & Temp	Date	Crew

9/29/2020

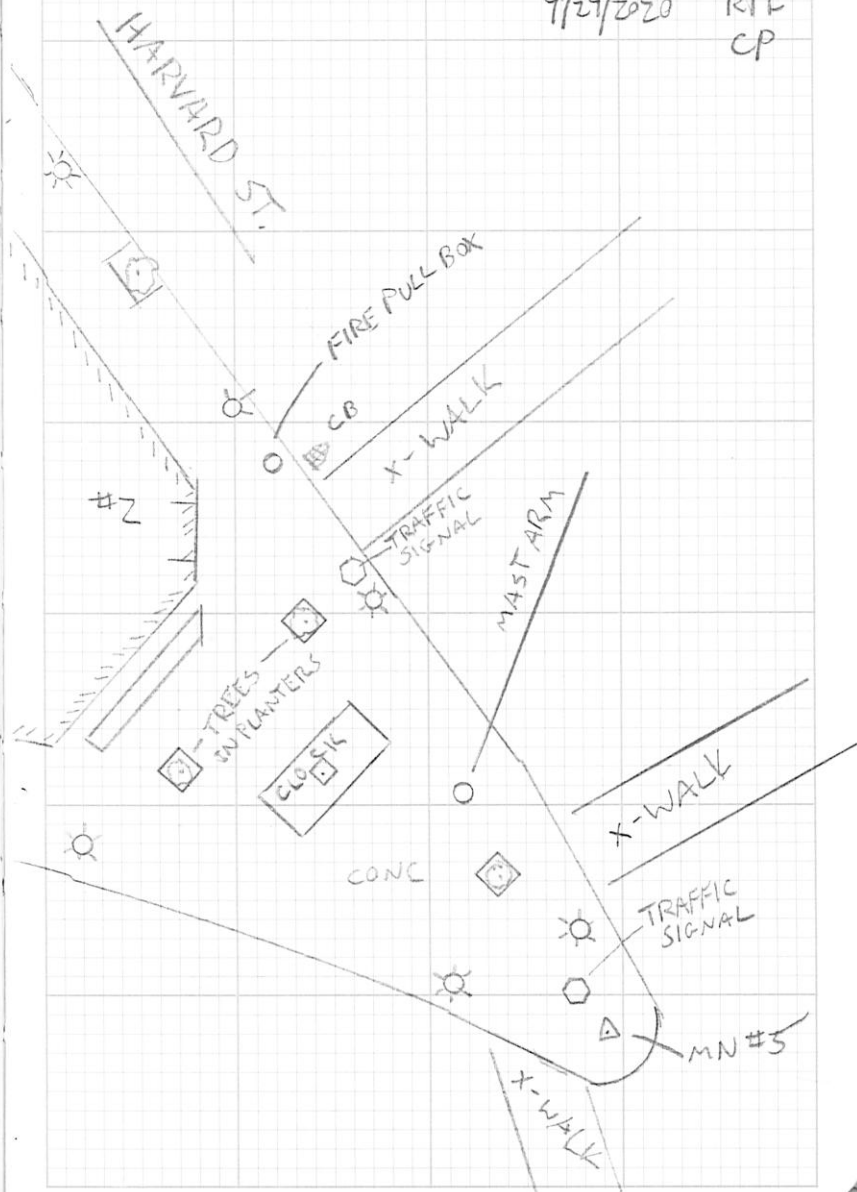
RTE  
CP

671/100

## BROOKLINE

Inst.	Tape	Wthr & Temp	Date	Crew
			10/1/2020	RTP

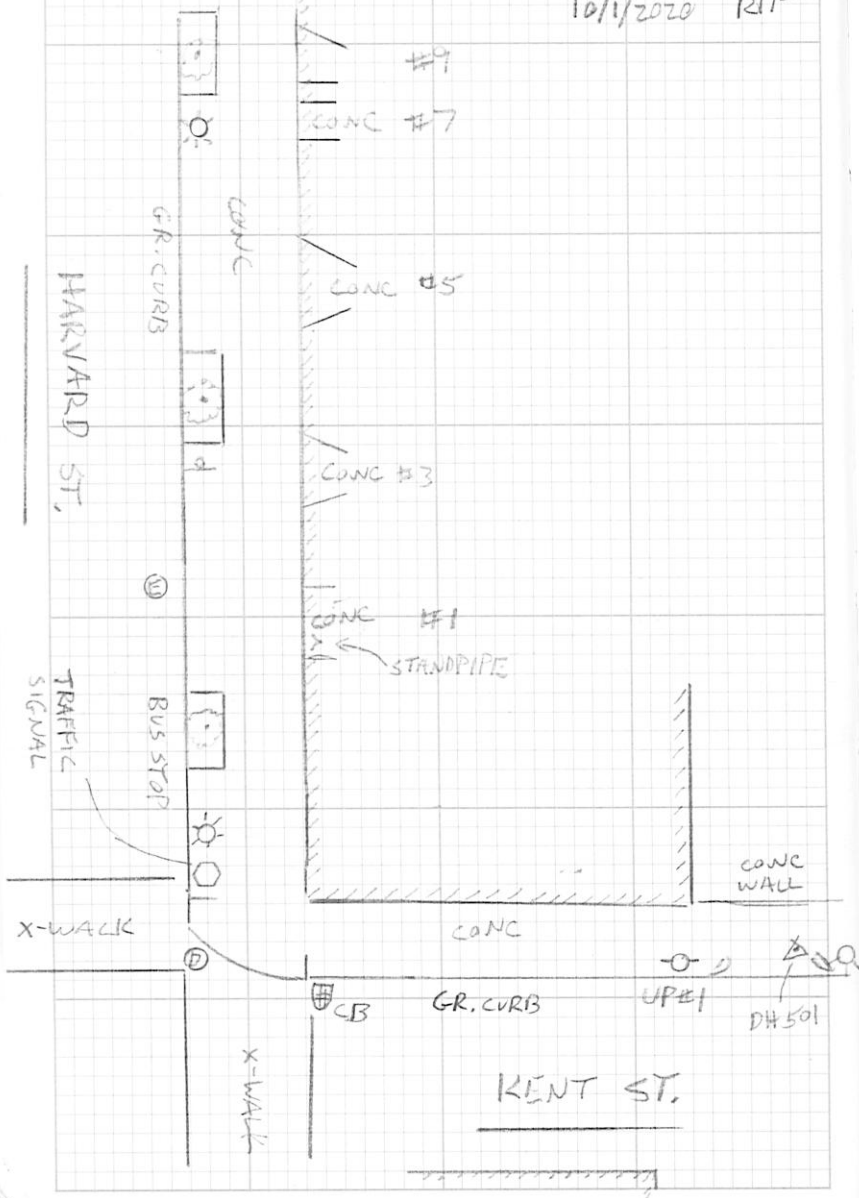

671/101

## BROOKLINE

Inst.	Tape	Wthr & Temp	Date	Crew
			10/1/2020	RTP

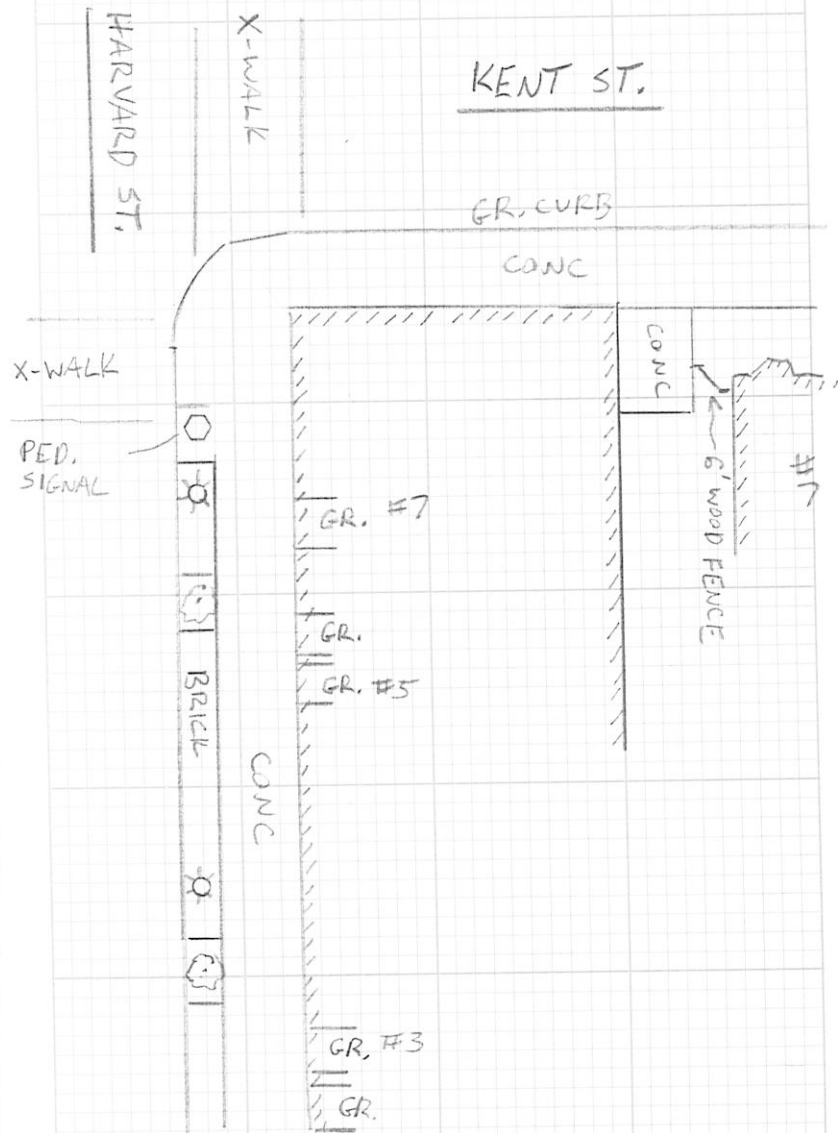

671/102

Inst.	Tape	Wthr & Temp	Date	Crew
-------	------	-------------	------	------

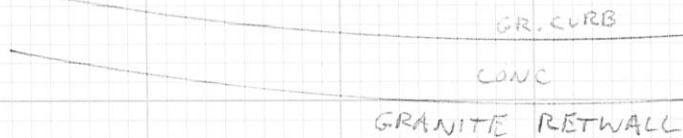
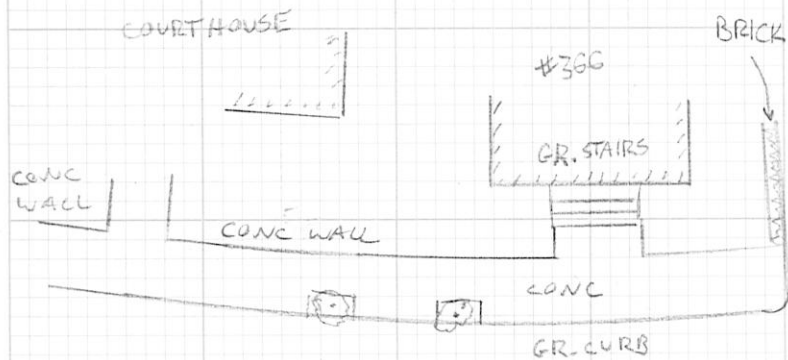

LIBRARY

671/103

Inst.	Tape	Wthr & Temp	Date	Crew
-------	------	-------------	------	------

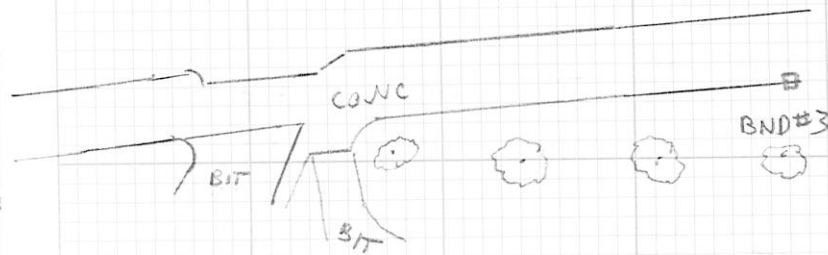
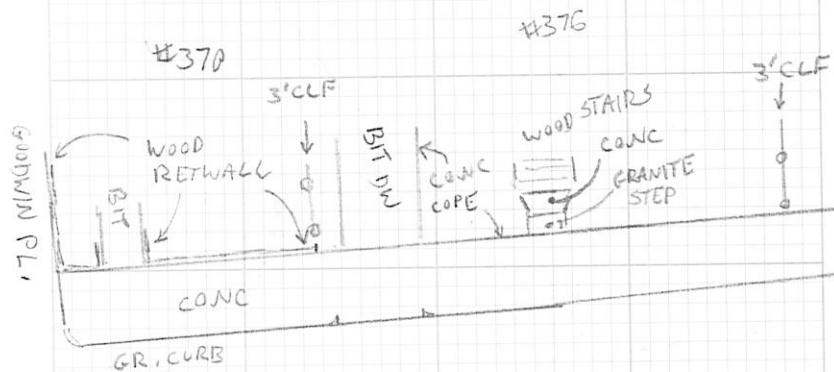



671/104

Inst.	Tape	Wthr & Temp	Date	Crew
-------	------	-------------	------	------

#89

BIT DW

4' CLF

BIT  
PARKING  
LOT

4' CLF

BIT

#115

BRICK WALK

4' METAL  
FENCE

SCHOOL ST.

BRICK X-WALK

PED.  
SIGNALTRAFFIC  
SIGNALBRICK  
X-WALKWASHINGTON ST  
BROOKLINE.

671/105

Inst.	Tape	Wthr & Temp	Date	Crew
TS16 8167		CLEAR 68°	10/01/2020	RF CP

K@CB 3 (5.25) → ON STK 2 (6.0)

SHOTS 4944 - 5034

MFLY ON DHL 7 (S.D)

TS16 2997	CLEAR 50'S	10/8/2020	RF CP MS
FILE: 1080_2997 DETAIL 3			

A@SBDH#8 HI=4.89 BS

PTS 12633 - 13025

12914 MFLY9 13025 MFLY9

671/106

## BROOKLINE WASHINGTON ST

671/107

Inst.	Tape	Wthr & Temp	Date	Crew
T516		CLEAR 50's	10/9/2020	RTP
2997	FILE:1080-UTILITY			CP MJ

 $\pi e 5$  HI=5.41 BS 4@7.0

13026-13150 13150 MFLY 4

 $\pi e 1$  HI=5.25 BS 2@5.5

13151-13191 13191 MFLY 2

 $\pi e 2$  HI=5.33 BS 1@5.5

13192-13218 13218 MFLY 3

 $\pi e 3$  HI=5.45 BS 2@5.5

13219-13338 13338 MFLY 7

Inst.	Tape	Wthr & Temp	Date	Crew
-------	------	-------------	------	------

671/108

## BROOKLINE

Inst. Tape Wthr & Temp Date Crew  
 LS15 CLOUDY 80'S 7/14/2021 KIF  
 CP  
 1080-071421

DIST	BS+	HI	FS-	DIST	ELEV	PT#
49	6.375	60.385			54.01	1
30	3.853	60.342	3.690	30	56.695	1000
49	2.208	55.687	6.869	40	53.470	1001
17	3.900	51.515	8.073	57	47.614	1002
44	4.835	50.211	6.139	18	45.375	1003
57	5.760	50.081	5.490	54	44.720	1004
57	7.721	48.070	1.792	52	48.289	1005
16	5.504	58.892	2.682	41	53.388	1006
			4.884	12	54.008	1

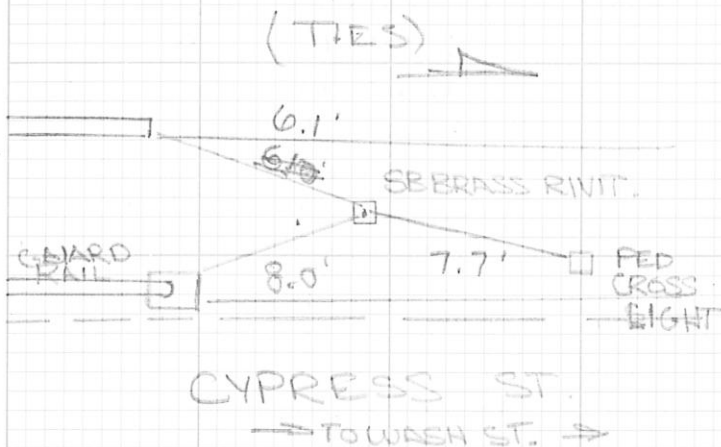

CYPRESS ST

671/109

Inst. Tape Wthr & Temp Date Crew  
 Collim. Error Old - 2.9" / New - 1.9"

## DESCRIPTION

BM MY 2083 - E 37 1978 NAVD 88  
 BRASS PIN IN SBND ON CYPRESS OPPOSITE TAPPAN  
 LOC BCS #102 CYPRESS  
 TURTLE  
 CH. SQR SE COR. CONC BASE PED. SIGNAL @  
 LOC GR. STEP #90 CYPRESS (DAVIS & CYPRESS)  
 TURTLE  
 TURTLE  
 P.O.B. BM MY 2083

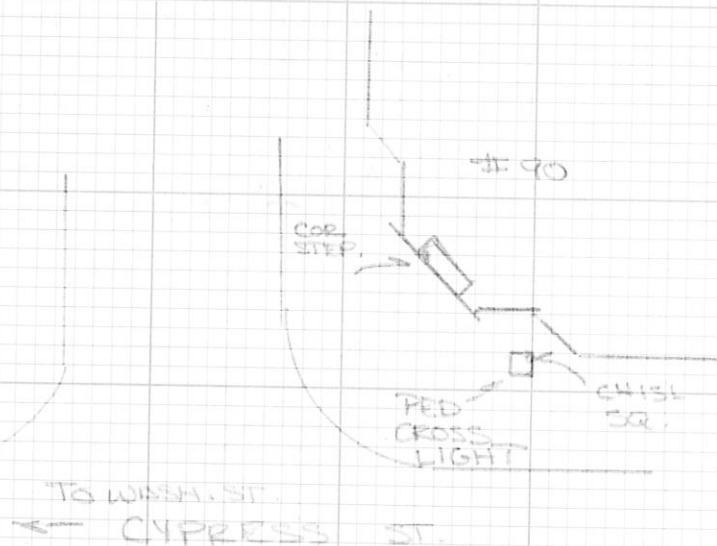

671/110

BROOKLINE

Inst.	Tape	Wthr & Temp	Date	Crew
LS15		CLEAR 90'S	7/19/2011	RJE CP
1080-71621				

DIST	BS+	#1	FS-	DIST	ELEV	PT#
51.0	3.545	48.920			45.375	1003
			6.994	78.0	41.926	1007
87.0	2.017	43.941	4.272	100.0	39.671	1008
123.0	5.238	44.910	4.244	129.0	40.665	1009
145.0	4.825	45.491	4.036	175.0	41.454	1010
144.0	4.168	45.622	5.744	141.0	39.878	1011
123.0	4.884	44.762	3.357	135.0	41.406	3
165.0	5.767	47.173	4.904	142.0	42.269	1012
9.0	4.644	46.914	1.986	19.0	44.928	2
189.0	4.267	49.195	1.60	160.0	44.437	1000
		4.758				
159.0	4.497	48.934	6.451	183.0	42.483	1013
165.0	3.950	46.433	5.028	168.0	41.405	3
135.0	3.352	44.757	4.882	125.0	39.875	1014
109.0	5.376	45.251	3.554	124.0	41.697	1015
227.0	4.399	46.090	5.898	243.0	40.198	1016
140.0	4.391	44.589	4.460	159.0	40.123	1007
61.0	7.278	47.401	2.021	58.0	45.386	1003

CYPRESS ST

671/111

Inst.	Tape	Wthr & Temp	Date	Crew
-------	------	-------------	------	------

DESCRIPTION

CH. SQ. (P. 108)

TURTLE.

TURTLE

TURTLE

TURTLE

TURTLE.

STN # 3

~~STN # 2~~ TURTLE

MSTN # 2

MSTN # 1

~~MSTN # 2~~ TURTLE.

MSTN # 3

TURTLE.

TURTLE.

TURTLE.

TURTLE.

CHSQ (P. 108)

671/112 LAKE ST NORFOLK

Inst.	Tape	Wthr & Temp	Date	Crew
TS16		CLEAR 50'S	12/8/2022	RTF
Z997	FILE:1027-11-30-22			CP PR

CONTINUED FROM 876/160

TC 67 HI=5.23 BS 66 @ 5.24

FS 652 @ 5.4 SB BROKEN OFF  
CENTER SHOT DOWN 1'

HZ 174.45.25 DIST 50.407

FS <sup>654</sup>~~653~~ @ 5.4 DVNN MCKENZIE  
CAPPED REBAR

HZ 4.09.57 DIST 215.303

STK 9701 STORE 20048

NORWAY FARMS DR. NORFOLK 671/113

Inst.	Tape	Wthr & Temp	Date	Crew
TS16		CLEAR 30'S	12/9/2022	RTF
Z997	FILE:1027-11-30-22			CP PR

TC 86 (676/150) HI=5.12 BS 53 @ 5.25

FS 95 @ 5.35 MN SET

HZ 75.27.57 DIST 260.003

FS 96 @ 5.30 MN SET

HZ 78.35.46 DIST 357.853

STK	STORE		NF
9745	20049		
9760	20050		
9761	20051		
9746	20052		
9747	20053		↓

TC 85 HI=5.35 BS 86 @ 5.12

FS 655 @ 5.4 DH FND

HZ 89.41.08 DIST 237.284

FS 656 @ 1.31 DH FND

HZ 117.45.33 DIST 290.477

TC 655 HI=4.88 BS 95 @ 5.35

FS 657 @ 5.4 DH FND

HZ 183.48.23 DIST 25.429

671/114 NORWAY FARMS DR NORFOLK

Inst.	Tape	Wthr & Temp	Date	Crew
TS16		CLEAR 40's	12/9/2022	RTF CP PR
2997	FILE:1027-11-30-22			

TC 96 HI=5.30 BS 86 @ 5.12

FS 658 @ 8.0 5/8 REBAR UP 0.5'

HZ 4 307.41.20 DIST 283.380

NEXT STORE PT 20055

Inst.	Tape	Wthr & Temp	Date	Crew
TS16		CLEAR 30's	12/19/2022	RTF CP PR
2997	FILE:1027-12-19-22			

TC 67 HI=5.07 BS 66 @ 5.10

STK PT 9835 STORE PT 20053

TC 96 HI=5.25 BS 86 @ 5.14

FS 97 @ 5.14 SN SET

HZ 4 292.16.00 DIST 304.863

9770 20056

9774 20057

TC 97 HI=5.14 BS 96 @ 5.25

9767 20058

9763 20059

9764 20060

9765 REBAR SHOT AS 659

9766 20061

671/115

Inst.	Tape	Wthr & Temp	Date	Crew
			12/19/2022	RTF CP PR

TC 97 HI=5.14 BS 96 @ 5.25

FS 659 @ 11.15 5/8" REBAR UP 0.3

HZ 4 179.49.14 DIST 118.058

FS 98 @ 5.10 MN SET

HZ 4 32.32.15 DIST 565.285

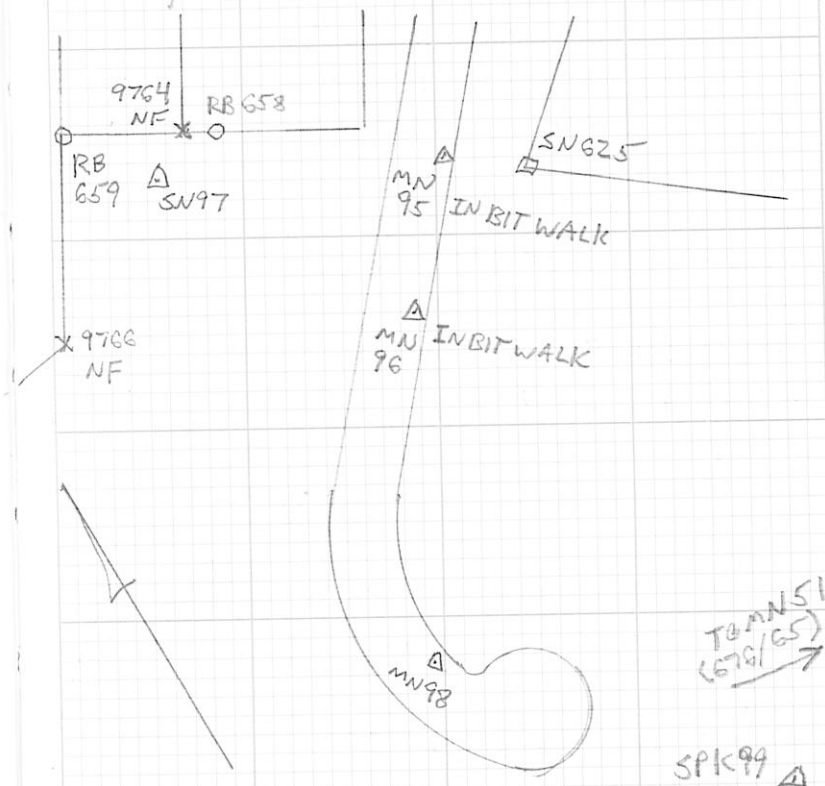



671/116

## CRESSBROOK &amp; NORWAY FARM

Inst.	Tape	Wthr & Temp	Date	Crew
TS16		CLEAR 30'S	12/20/2022	RTF
2997	FILE:1027-12-19-22			CP

K@51 H1=5.45 BS53@5.34

FS99@5.17 SPK SET

HZ &amp; 236.39.51 DIST 260.897

K@99 H1=5.17 BS51@5.45

FS660@5.4 1/2" REBAR

HZ &amp; 318.53.35 DIST

FS661@5.4 5/8" REBAR

HZ &amp; 73.14.45 DIST

FS662@5.4 1/2" REBAR

HZ &amp; 126.33.03 DIST

FS663@5.4 5/8" REBAR

HZ &amp; 166.06.47 DIST

FS664@5.4 1/8" x 9" x 1.5" H SET H

HZ &amp; 286.45.43 DIST

FS98A@5.24

HZ &amp; 220.52.47 DIST

K@98A H1=5.24 FS99@5.17

FS97A@5.11

HZ &amp; 237.25.38 DIST

K@97 H1=5.11 BS96@5.10

STK PT 9838 STORE PT 20062

K@56 H1=5.38 BS54@6.0

10131-10197 STONEWALL 10148 MFLY

## NORFOLK

671/117

Inst.	Tape	Wthr & Temp	Date	Crew
TS16		P. CLOUDY 40'S	12/29/2022	RTF
2997	FILE:1027-12-29-22			CP
				PR

K@87 H1=5.51 BS54@5.30

STK PT 101 STORE PT IRON "T" FND

FS665@5.1 IRON "T" DOWN 0.3

HZ &amp; 127.00.45 DIST 47.764

FS666@5.30 SN SET

HZ &amp; 168.32.32 DIST 959.676

K@666 H1=5.30 BS87@5.51

FS667@5.10 DH FND

HZ &amp; 170.13.30 DIST

FS668@5.10 DH FND

HZ &amp; 173.30.20 DIST

FS669@5.52 SN SET

HZ &amp; 176.39.09 DIST 667.959

671/118

NORFOLK

Inst.	Tape	Wthr & Temp	Date	Crew
TSIG		P. cloudy 40S	12/29/2022	RTF
2997		FILE:1027-12-29-22		CP
				PR

AT @ 669 HI=5.5Z BS 666 @ 5.30

FS 670 @ 5.3 DH FND

HZ @ 180.44.36 DIST 325.039

FS 671 @ 9.3 DH FND

HZ @ 143.00.24 DIST 436.259

671/119

Inst.	Tape	Wthr & Temp	Date	Crew
-------	------	-------------	------	------

671 670

HSE 65

HSE 63

SN  
669

HSE 61

DH  
668

HSE 59

DH  
667

HSE 57

△ GGG  
SN

HSE #56

TRURO RD

MEDWAY ST

665  
T

SN  
△ 87 HSE #44

LAKE ST

△ 54