

Plan showing the Discontinuance of a portion of Common Street, Dedham, MA

as laid out
by the NORFOLK COUNTY COMMISSIONERS
on July 7, 1903
as made by the Norfolk County Commissioners
by Return dated November 1, 2006
Scale: 1 inch = 40 feet
Joseph M. McNichols, County Surveyor

Joseph M. McNichols CHAIRMAN



"I HEREBY CERTIFY THAT THIS PLAN
WAS PREPARED IN CONFORMITY WITH THE
RULES AND REGULATIONS OF THE REGISTERS
OF DEEDS."



DATE: 11/1/2006

PROFESSIONAL LAND SURVEYOR

— A TRUE COPY —

Attest: *May K. Buckley, Fox Axt* Clerk.

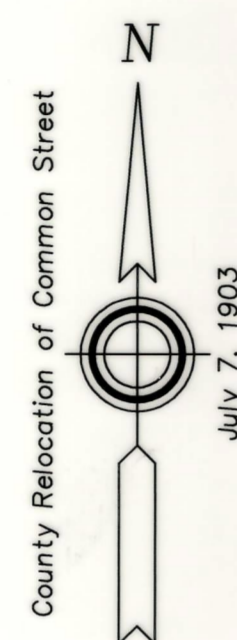

**ROUTE 128
CIRCUMFERENTIAL HIGHWAY**
1954 STATE ALTERATION
BOOK 3244 PAGE 386

EPLP SB (FND)

LP SB (FND)

70.04'

COMMON STREET
1994 TOWN LAYOUT
BOOK 3244
PAGE 386

EPLP SB (FND)

N/F
HRCA OF DEDHAM, INC.
BOOK 22288 PAGE 70

PARCEL "A"
16,003 S.F.±

EPLP SB (FND)

S18°32'35"W
155.11'

EPLP SB (FND)

COMMON (PUBLIC - VARIABLE WIDTH) STREET
1903 COUNTY RELOCATION
COUNTY CLERK RECORD VOL. 36, PLAN 1700

N/F
HRCA OF DEDHAM, INC.
BOOK 22288 PAGE 70

N49°33'16"E
58.58'

N40°13'51"W
298.00'

CONCRETE

BITUMINOUS

286.75'

S38°21'47"E

48.81'

S49°33'16"W

59.61'

R=1005.30'
L=109.93'

NON-TANGENT
R=1230.91'
L=11.44'
CHORD BRG. = S38°30'53"E
CHORD DIST. = 11.43'

DH SB (FND)

DH CB TO BE SET

DH CB TO BE SET

NON-TANGENT
R=1230.91'
L=164.32'
CHORD BRG. = S42°36'18"E
CHORD DIST. = 164.20'

STONE BOUND "I"
SB (FND)
BACK CENTER