

Plan of Alteration  
of  
**BRIDGE AND APPROACHES**  
at Crossing of Washington Street and  
New York, New Haven & Hartford R.R., in Dedham,

as prescribed by the Norfolk County Commissioners  
by decision dated Feb. 28, 1928 and amended May 29, 1928.

Hartley L. White, County Engineer. Scale 1 inch = 40 feet.

*Grant Richardson*, Chairman.

- A TRUE COPY -

Attest *R. B. Worthington*, Clerk.

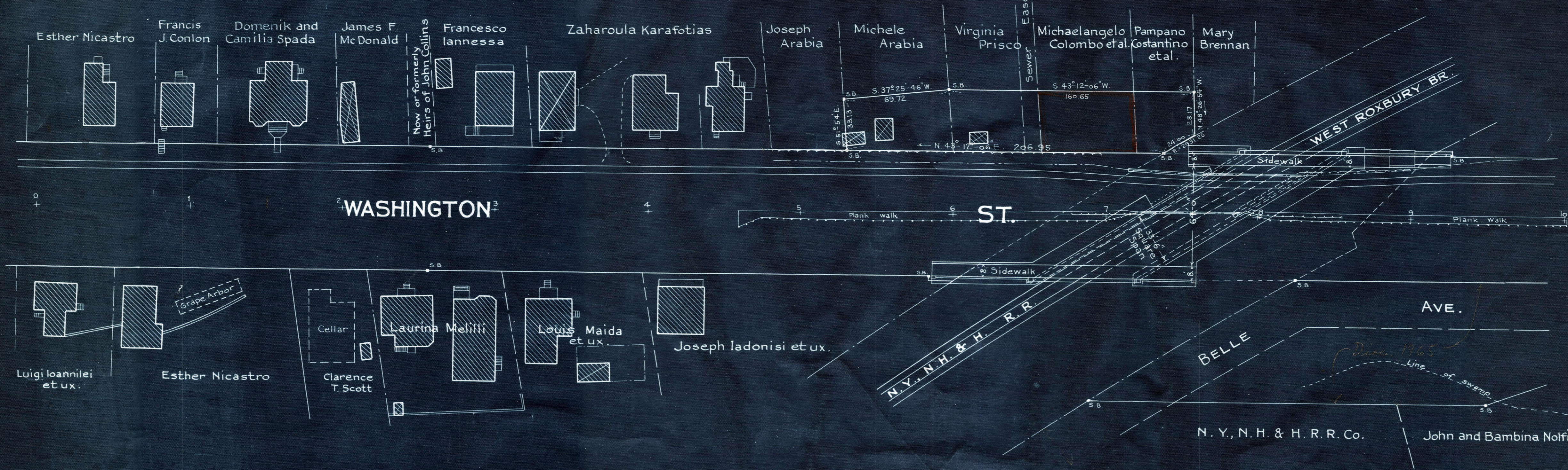

- PROFILE -  
Hor. Scale 1 inch = 40 feet.  
Vert. " 1 " = 8 "