

Plan showing the Relocation and Widening
of
WASHINGTON STREET
between Central Ave. and Hollis Ave.
in the
TOWN OF BRAINTREE
as made by the Norfolk County Commissioners.

as made by the Norfolk County Commissioners.

Erwin F. Richardson Chairman

June ~ 1926.

Hartley L. White, County Engineer: Scale 1 inch = 40 feet.

- A TRUE COPY -

Attest: *R. B. Worthington* Clerk

Bounds Set Fall 1926

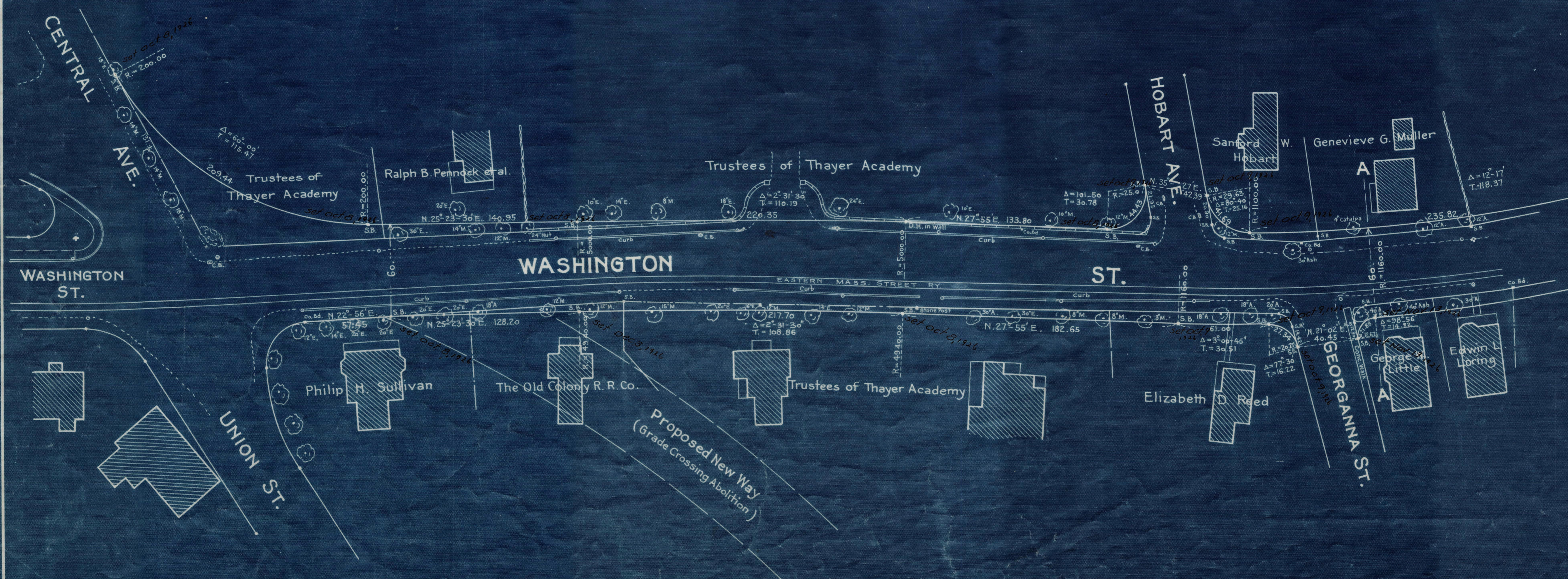

Note: Poles shown thus: ○
Hydrants: ●

*TAKING - 1706-229
P.B. - 206-458-60-9766
Recorded - July 28, 1926*