

Plan showing the Relocation and Widening
of
POND AND BILLINGS STREETS
at or near Main Street in the
TOWN OF SHARON
as made by the Norfolk County Commissioners
Edward Richardson Chairman.
November-1925.
Hartley L. White, County Engineer. Scale 1 inch = 40 feet.

A TRUE COPY -
Attest *R. B. Worthington* Clerk.

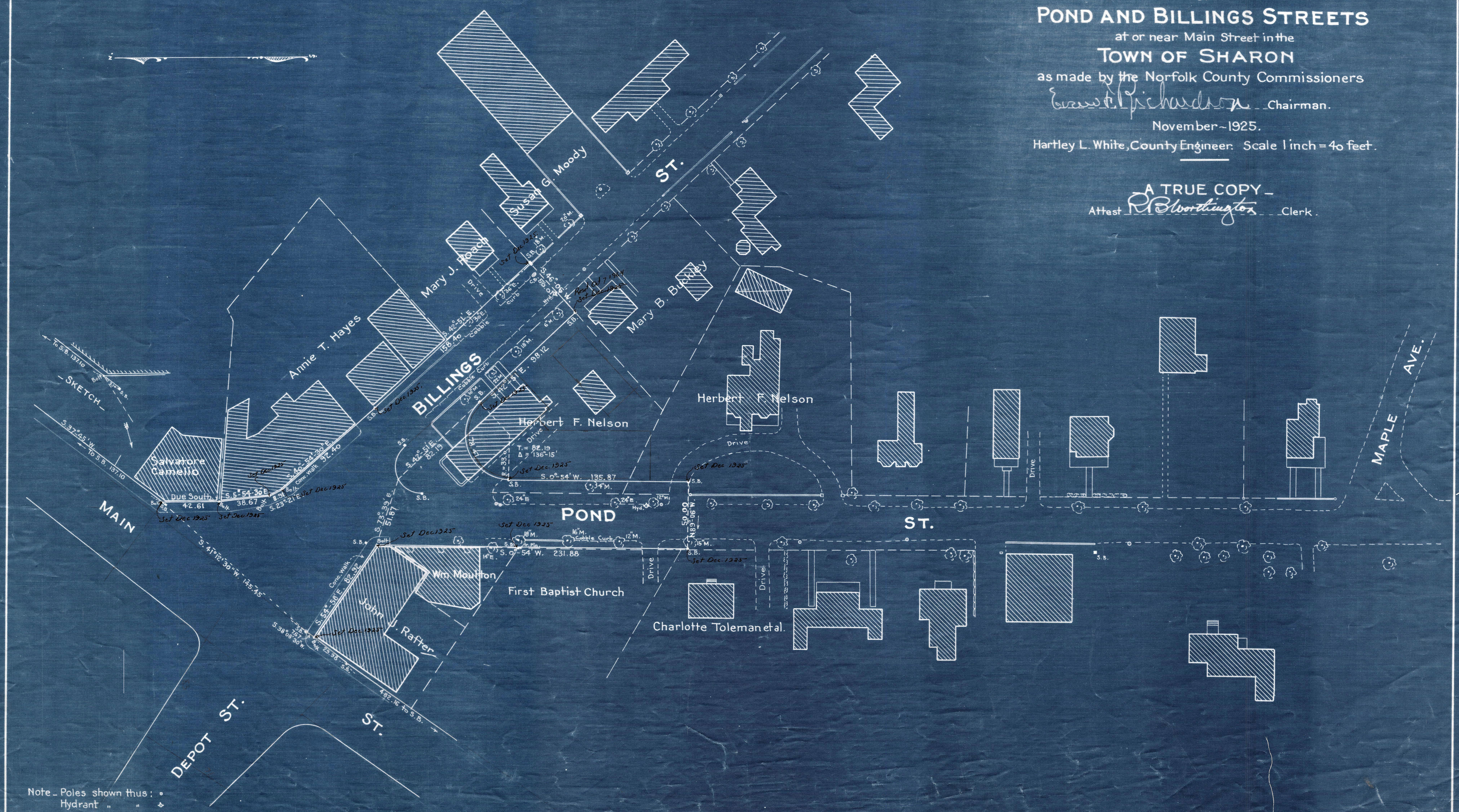

Note - Poles shown thus: •
Hydrant " " •