

Plan showing the Relocation and Widening of  
**DOVER ST., DOVER**  
between Main St. and the Charles River  
and  
**CHARLES RIVER ST., NEEDHAM**  
between the Charles River and Grove St.  
as made by the Norfolk County Commissioners.

*Ernest F. Richardson*, Chairman.

- A TRUE COPY -  
Attest. *R. B. Worthington* Clerk.

Norfolk Registry of Deeds  
DORHAM, MASS.  
Received *July 9, 1925* with Taking  
by *County of Norfolk*  
Filed as No. *589-1925 HBK 104*  
Attest. *Walter W. Schamir*  
REGISTER

Hartley L. White, County Engineer. Scale 1 inch = 40 feet. Surveyed May, 1925.

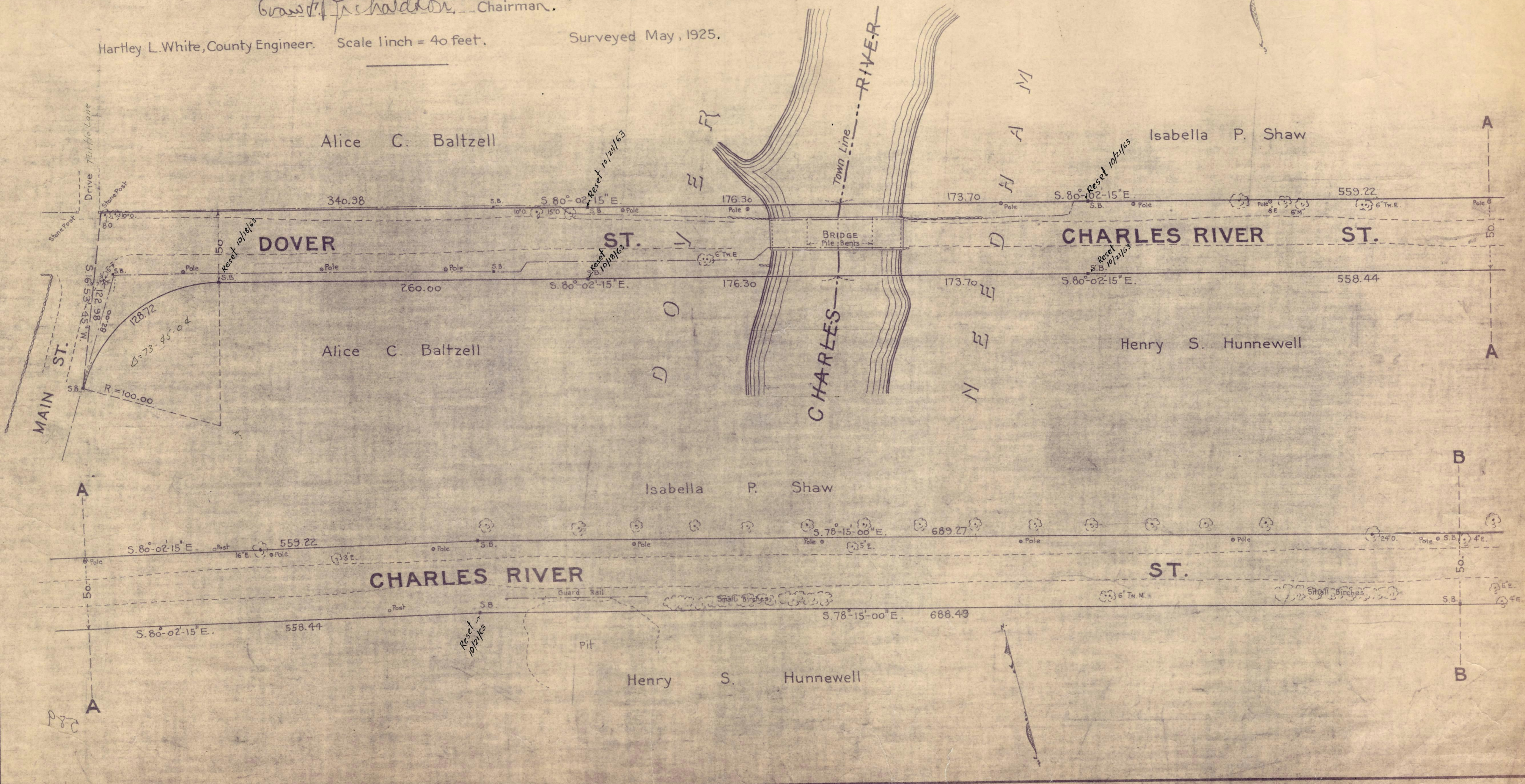

Office Copy