

Plan showing the Relocation and Widening  
of  
**MASSAPOAG AVENUE, SHARON,**  
from  
East St. to Massapoag St.  
as made by the Norfolk County Commissioners  
by Return dated July 22, 1930.

Hartley L. White, County Engineer. Scale 1 inch = 40 feet.  
*Edward W. Wood* Chairman

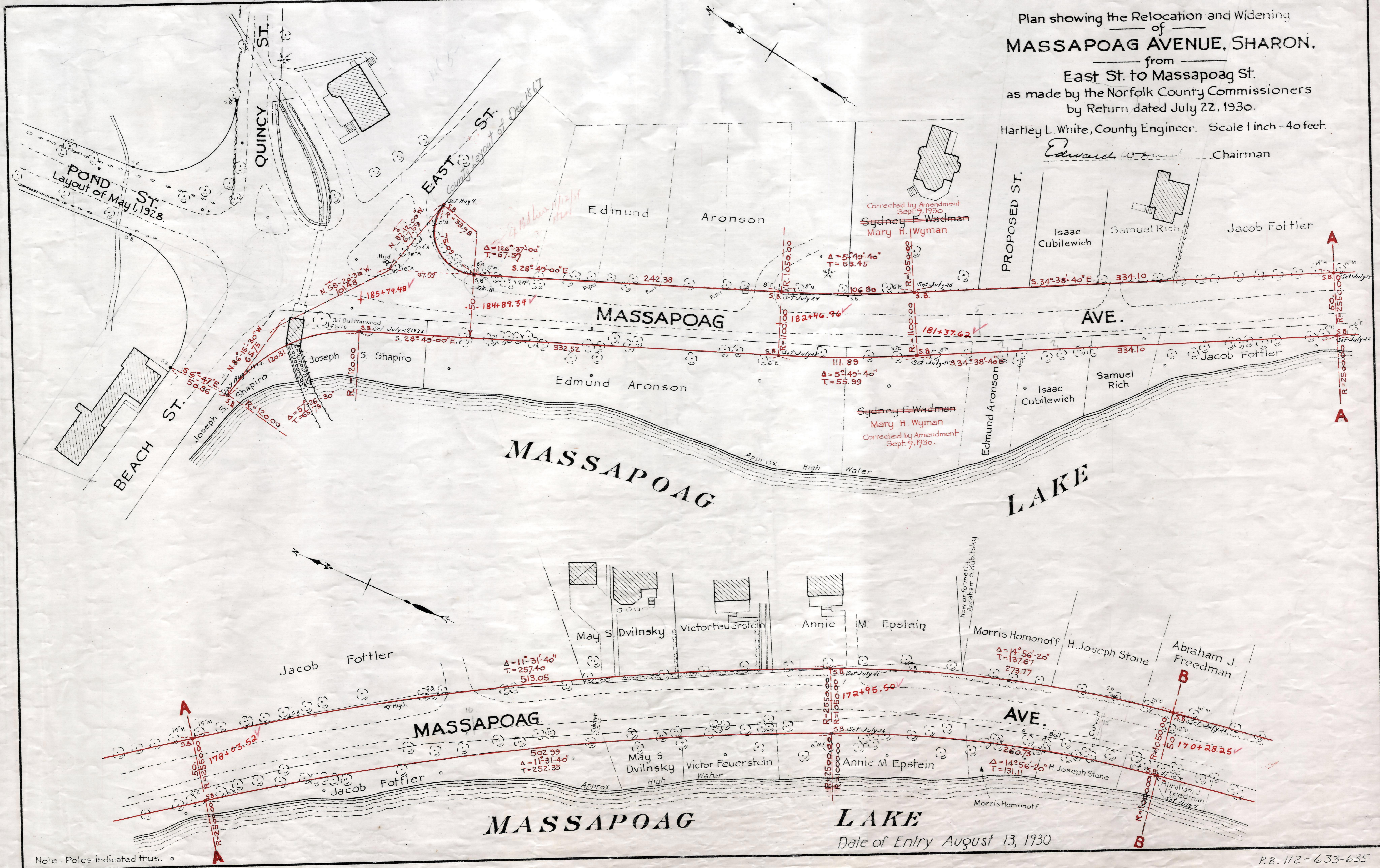

Note - Poles indicated thus: ○

Date of Entry August 13, 1930

P.B. 112-633-635  
TAKING  
Rec- 8-12-30