

Plan showing the Relocation and Widening
of
AMES STREET

at and near the Bridge over the Charles River
in the

TOWN OF DEDHAM

as made by the Norfolk County Commissioners

Ernest Richardson Chairman

July ~ 1926

Hartley L. White, County Engineer. Scale 1 inch = 20 feet.

- A TRUE COPY -
Attest *R. B. Worthington*, Clerk.

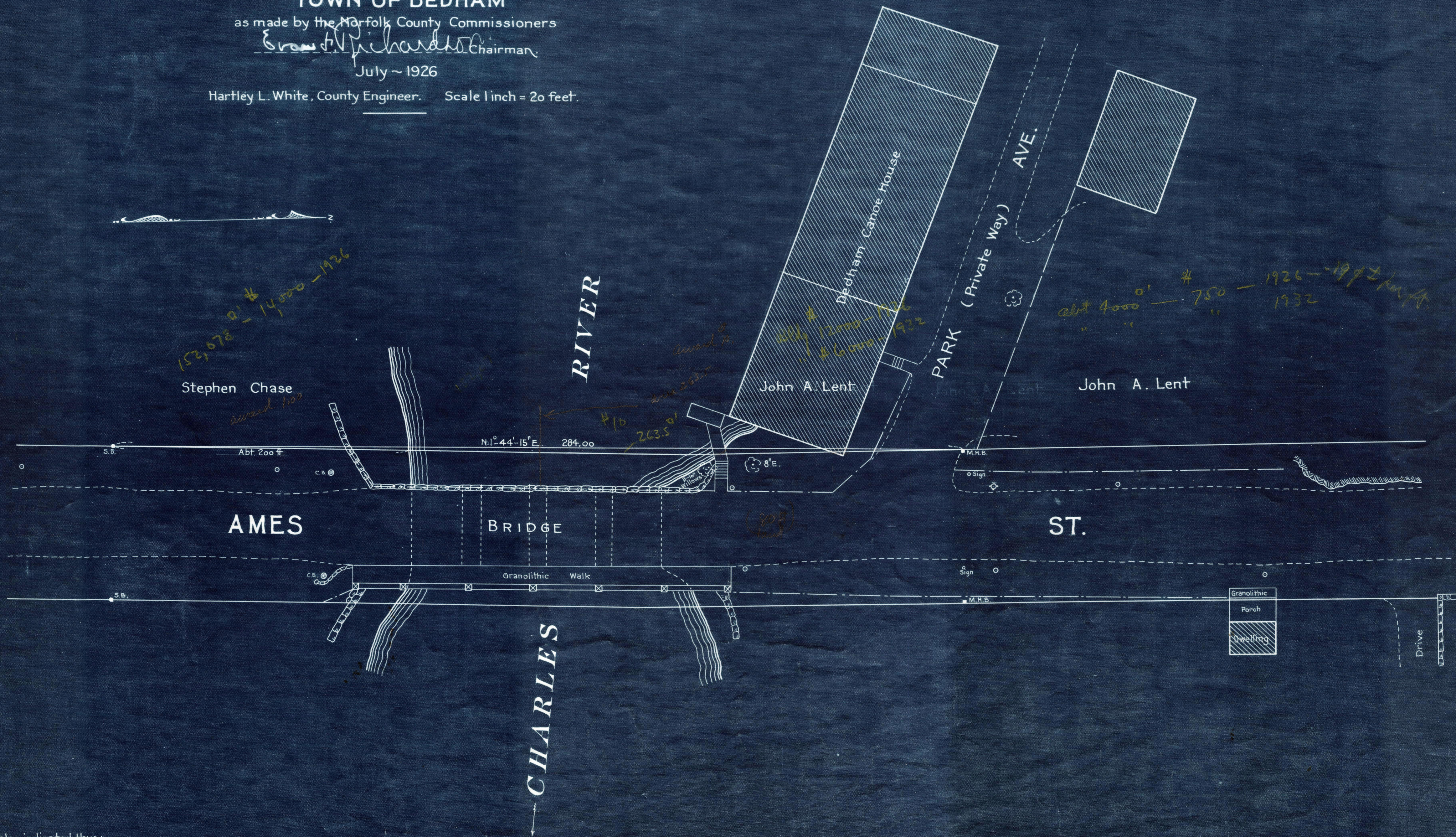

Note - Poles indicated thus: ○
Hydrants " " ⊕

Date of Deed July 1926