

Grade of "Change" will be the same as above.

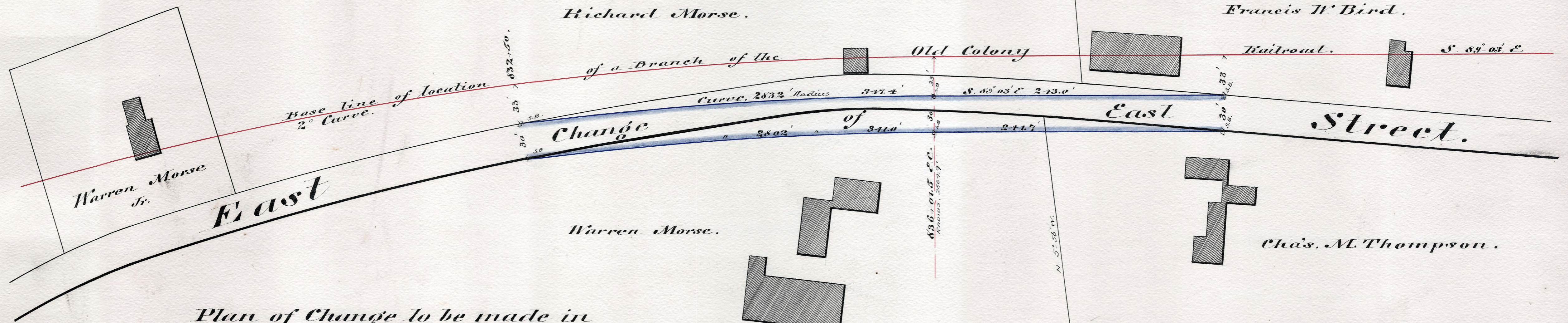

Plan of Change to be made in
 East Street, East-Walpole,
 by the
 Old Colony Railroad Co.,
 Scale: 50 ft. = 1 inch.

Dedham, *Fromber* Oct. 25th 1890.

Geo. S. Morrill,
 chf. engr.

No. 4.

George W. Higgin, Chairman.