

192 B

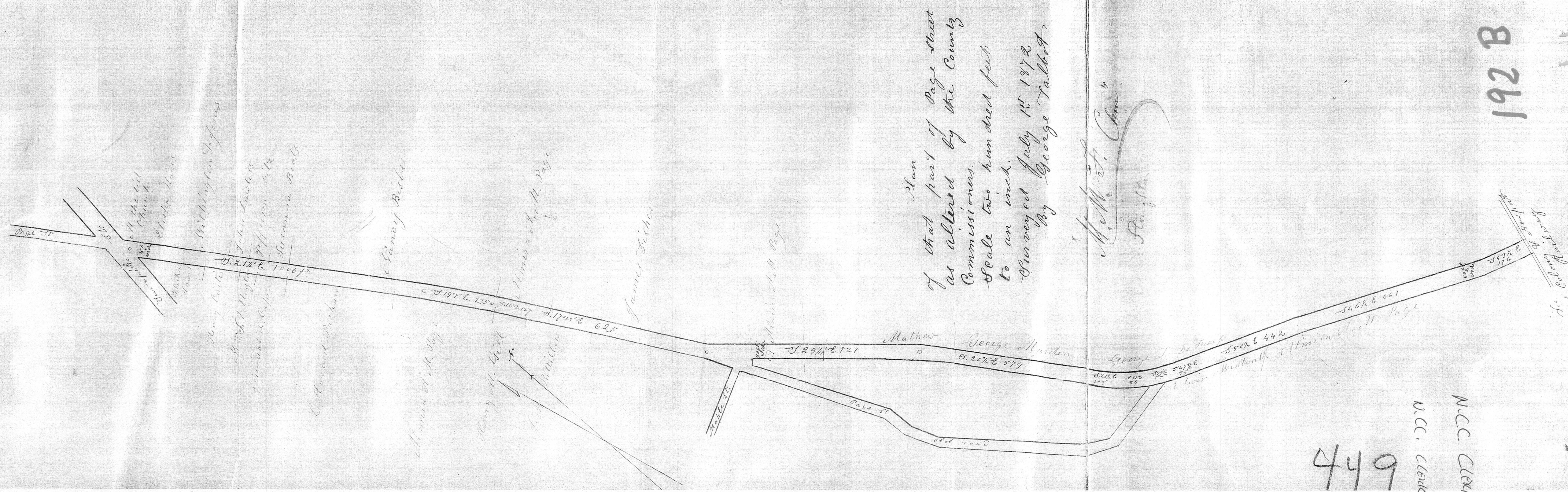

Plan
 of that part of Page Street
 as altered by the County
 Commissioners.
 Scale two hundred feet
 to an inch.
 Surveyed July 14th 1872
 By George Talbot

McM. St. Chm.
 Staughton

449

R. Bk. Vol. 7 / GRAD # 449
 N.C.C. Clerk RECORD Vol. 11 / 63

192 B