

PLAN SHOWING THE LOCATION OF  
 A NEW WITNESS MONUMENT ON THE  
**FRANKLIN AND NORFOLK TOWN LINE**

MARCH 13, 1997 SCALE: 1 INCH = 100 FEET  
 JOHN M. PARONICH, COUNTY ENGINEER

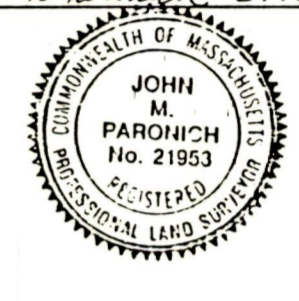

*John M. Paronich* DATE: 3/13/97



**FRANKLIN-NORFOLK 1 W.M. (F-N 1 W.M.)**  
 1983 NAD POSITION PROVIDED BY MASS HIGHWAY'S  
 GEODETIC SURVEY  
 N 2871165.258  
 E 688722.543  
 D.H. (SET) IN TOP OF 3.2'± HIGH  
 GRANITE MONUMENT (FND) AT  
 THE S'WLY EDGE OF LAKE POPULATIC.

A DRILL HOLE IN A 6" X 6" GRANITE MONUMENT  
 SET ON THE TOWN LINE 6"± ABOVE GROUND.  
 (FEB. 28, 1997)

A DRILL HOLE IN A 6" X 6" GRANITE MONUMENT  
 SET ON THE TOWN LINE 6"± ABOVE GROUND.  
 (FEB. 28, 1997)

THE ROADSTONE IS A TRIANGULARLY SHAPED  
 STONE MONUMENT 0.7' X 0.7' X 1.0' IN SIZE.  
 IT IS TIPPED AT AN ANGLE OF APPROX. 45°  
 WITH 3.0'± EXPOSED FROM THE GROUND. AN  
 "N" SHOWS ON ONE FACE AND PRESUMABLY  
 AN "F" IS ON THE SIDE THAT LEANS AGAINST  
 A STONE RETAINING WALL.

**NEW (F-N 2 W.M.)  
 WITNESS MONUMENT**  
 DRILL HOLE (SET) IN THE TOP OF A  
 NEW 12" X 12" X 4' HIGH GRANITE  
 WITNESS MONUMENT SET ON TOWN  
 LINE 12/12/96. THE LETTER N IS  
 CUT INTO THE N'ELY SIDE AND THE  
 LETTER F WITH THE DATE 1995 AND  
 LETTERS WM ARE CUT INTO THE S'WLY  
 SIDE.

**FRANKLIN-NORFOLK 2 (F-N 2)**  
 1983 NAD POSITION PROVIDED BY MASS HIGHWAY'S  
 GEODETIC SURVEY  
 N 2864155.961  
 E 692057.632  
 A STAKE & NAIL WAS SET OVER THE CENTER  
 OF THE BROKEN GRANITE MONUMENT WHICH  
 WAS FOUND NEAR THE PAVEMENT'S EDGE  
 DOWN 1.5'±.

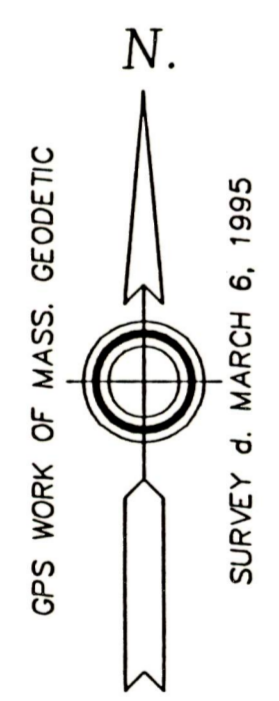

\*SEE THE 1905 HARBOR AND LAND COMMISSION ATLAS  
 FOR ADDITIONAL INFORMATION REGARDING THE BOUNDARIES  
 OF THE TOWNS OF FRANKLIN AND NORFOLK.