

INDEPENDENCE AVE.

CENTRE ST.

CHURCH ST.
(COUNTY LAYOUT OF FEB 9, 1937)

BUSHNELL TERRACE

Ralph T. and Helen C. Conner
GARAGE
PARCEL NO. 1 TAKING 800' S.E.

NEW HAVEN AND HARTFORD RAILROAD

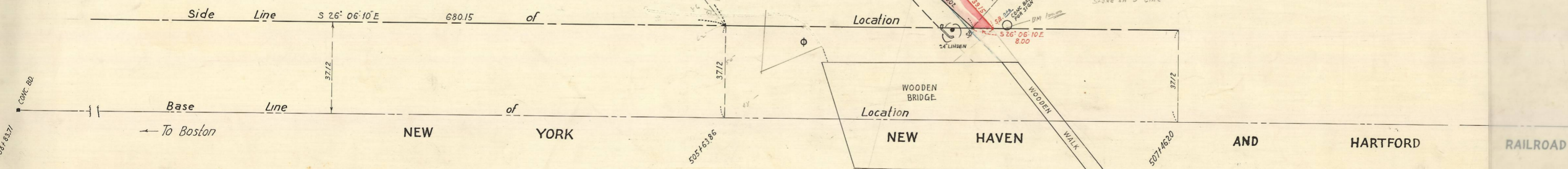

NORFOLK COUNTY — ENGINEERS DEPT.			
Town	BRAINTREE	Street	WASH - CHURCH
Survey by	MEDA	F. B. #	71
Plotted by		Date	JULY 1949
Checked by		Scale	1" = 20'
		Drawer	No.

27 1/2
34 1/2
R 25